

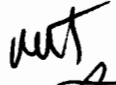
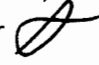

MEMORANDUM

To: Mayor Westover and Members of the Assembly
Jim Dinley, Municipal Administrator

From: Michael Harmon, P.E. Public Works Director 
Stephen Weatherman, P.E, Municipal Engineer 

Reviewed: Jay Sweeney, Finance Director 
Tammy O'Neil Contract Coordinator 

Date: November 22, 2011

Subject: Centennial Hall and Crescent Harbor Parking Upgrades

Background

On July 26, 2011 the Assembly approved the "Work Items List". After the approval the Centennial Hall and Crescent Harbor Parking Upgrades Feasibility Committee was formed to develop a site plan that address issues identified in the "Work Items List". The following is a timeline of past meetings:

- March 30th & 31st – First Public Meeting to discuss needs and approve process and User Group list.
- April & June – User Group interviews to identify "needs list".
- July 13th and 14th – Draft "needs list" presented to the Public (two meetings each day).
- July 26th – Assembly approved final "needs lists".
- September 7th – First concepts presented to the Centennial Hall Feasibility Committee.
- September 13th – Assembly Update Report
- September 15th – Improved concepts presented to the Centennial Hall Feasibility Committee.
- September 19th – Public Meeting (site analysis options)
- October 20th – Presented refined site layout concepts to Feasibility Committee
- October 26th – Public meetings to review and comment on refined site layout concept C-7.
- November 17th – Centennial Feasibility meeting to review public comments and finalize site plan C7

The next step after assembly approval of the site plan is to begin working with appropriate Commissions for developing a detailed design. We will also prepare a project development schedule and begin the process of acquiring design consultants through the RFP process.

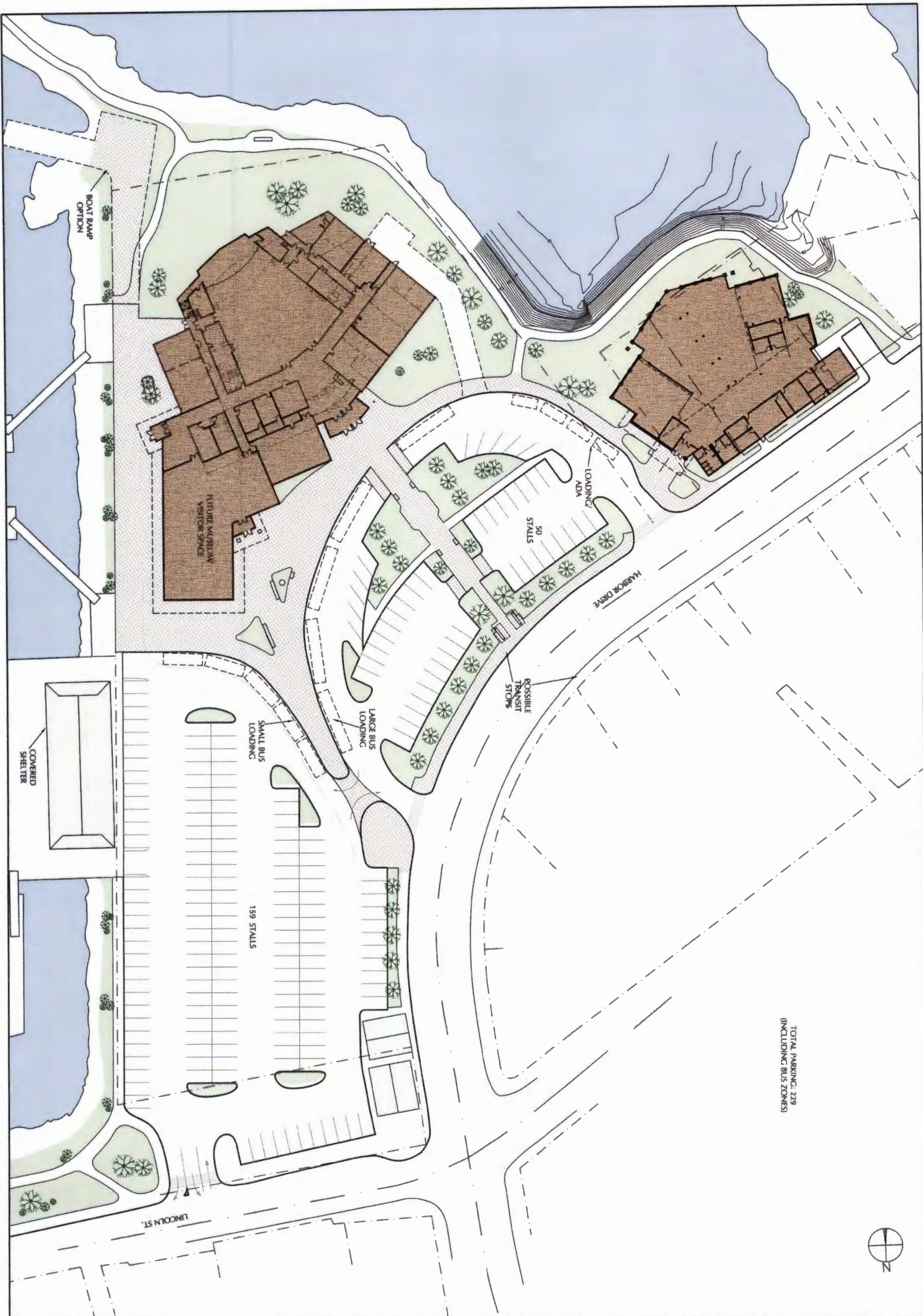

SITE STUDY

CENTENNIAL PARKING AND SITE IMPROVEMENTS

FOR THE
CITY OF SITKA

MRVARCHITECTS

1420 GLACIER AVENUE
JUNEAU, ALASKA 99801

907-586-1371
FAX 907-463-5544
mrv@mrvarchitects.com

MRV # 1107

SHEET TITLE:

SITE PLAN OPTION

DATE: NOV 21, 2011
SCALE: 1/32" = 1'-0"
DRAWN:
CHECKED:

SHEET NO.

C7

