

Public Works
Road Master Planning
March 24, 2014

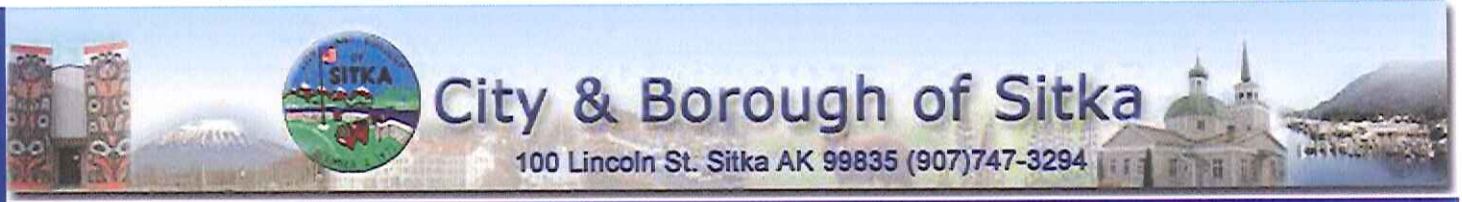

Road System Master Planning and Funding Strategies



Created By:
Michael Harmon
CBS Public Works
March 24, 2014



Chapter

Slide Number

- Road System Background
 - Expanding Infrastructure..... 3
 - Paving History..... 4
 - Ballot History..... 5
 - Sustainable Roads..... 6 thru 9
- Remaining Service Life (RSL)
 - Road Inventory..... 10
 - RSL Breakdown (Pie Chart)..... 11
 - RSL versus Cost (Bar Char)..... 12
 - Cumulative Cost 13
 - RSL Condition Examples..... 14 thru 30
- Cumulative Cost and Funding Chart (No LID)..... 31
- Adding an LID Program to Fund Residential Roads
 - LID Background..... 32
 - LID Analysis and Charts..... 33 thru 35
- Annual Funding Stats..... 36 thru 37
- Funding Scenarios (with and without LID)..... 38 thru 39



Expanding Infrastructure with Shrinking Budgets & Maintenance Staff

- Streets (33% Increase):

Knutson Drive	Katherine Benson	Andrew Hope	Bahovic Court
Price Street	Naomi Kanosh	Kaasda Heen Circle	Harbor Mt ByPass
Vitskari	Yaw	Kostrometinoff	Toivo Circle
Kiksadi Court	Thomas Young	Mills Street	Old Harbor Mt Road
Lance Drive	Gil Truitt	Georgeson Loop	Nelson Logging Road*
Harvest Way	Herb Didrikson	Johnston Street	Eliason
Lillian Drive	Peter Simpson	Donna Drive	Versa
Smith Street	Rudolph	Kramer (Casc.Ck end)	Alice Loop (Japonski)
Jarvis Street	Walton	Sanddollar Drive	Seward Ave.(Japonski)
Indian River	Charlie Joseph	Tongass (Japonski)	



PAVING HISTORY

- The road system in Sitka has developed over a long period of time. The downtown business area roads have been paved for many years.
- Many of the residential roads were not paved until either an LID was formed by residents or they were paved during the 80's and 90's under State Grants. Some of these roads did not have good bases and have deteriorated more than others.

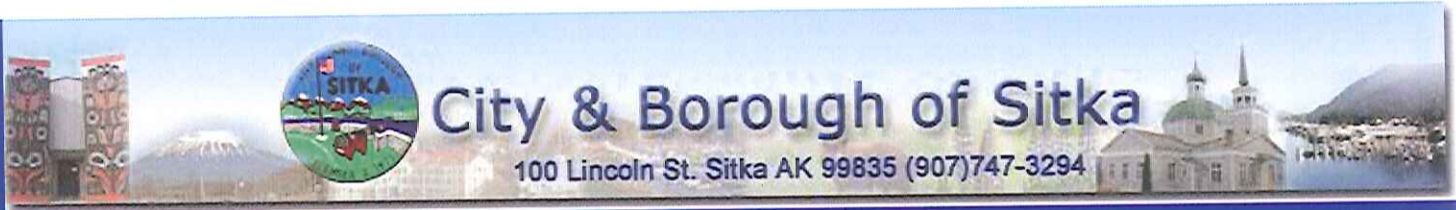

BALLOT PROPOSITION HISTORY

- In 2009 Proposition #2 asked the voters to support a $\frac{1}{2}$ sales tax increase all year around to fund a \$7,000,000 road improvement package and including bonding for 20-years.
 - » Yes 465
 - » No 572
- In 2011 Proposition #1 asked the voters to support a $\frac{1}{2}$ millage rate increase in support of funding improvements to roads and the Hospital.
 - » Yes 792
 - » No 1282



FUNDING SUSTAINABLE ROADS

- A dedicated infrastructure fund has been established but it does not have a dedicated revenue stream commensurate with the needed maintenance.
- Currently the majority of the funding for road repair and maintenance is allocated from the General Fund.
- The FY 2015 Budget proposes \$1.3 million towards road improvements.



BOTTOM UP FAILURE

Most of the current road base material is not free draining and is not “non frost susceptible” material. Many of these road exhibit “alligator” cracking and potholes.

TOP DOWN FAILURE

This can happen from heavy or repetitive loads pulverizing the pavement from the top. Also prevalent in aging or thin pavement over a relatively competent base.

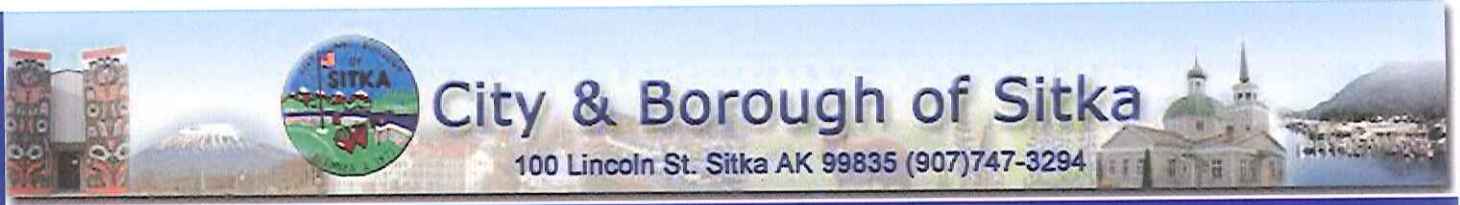

BUILDING SUSTAINABLE ROADS

Building a good road starts with a stable base that is free draining.

The sustainable solution for our roads is to remove the substandard base and replace it with 2 inch minus shot rock approximately 18 to 24 inches thick. This will provide a free draining base for the pavement to be constructed over and resurfaced as needed into the foreseeable future.

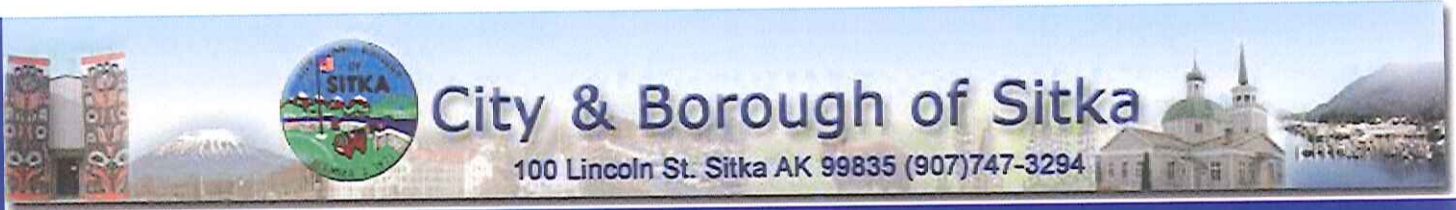

ROAD REPAIR TREATMENT OPTIONS

<u>Treatment</u>	<u>Maintenance Type</u>	<u>Cost Per SY</u>	<u>Added Life</u>	<u>Next Treatment</u>
• Patching	Routine	\$4.50	1 Years	Grind with 2 ½" overlay
• Chip Seal	Preventative	\$15.00	5 Years	Chip Seal
• Grind with 2 ½" overlay	Rehabilitation	\$30.00	12 Years	Fog/Crack Seal
• Reconstruction	Reconstruction	\$73.00	20 Years	Fog/Crack Seal
• Downtown Reconstruction Full Curb, gutter Sidewalk	Reconstruction	\$285.00	20 Years	2 ¼ Inch overlay



TOTAL ROAD INVENTORY SORTED BY REMAINING SERVICE LIFE

Location ID	Road Name	From	To	Length (ft)	Width (ft)	Area (yd^2)	RSL	Recommended Treatment	Treatment Costs/YD^2	Estimated Cost
400	FINN ALLEY	ETOLIN ST	BARLOW ST	218	12	291	0	2.5" Repave	73	\$21,219
545	LANCE DR	VITSKARI ST	SAWMILL CREEK RD	792	18	1584	0	2.5" Repave	73	\$115,632
579	RANDS DR	WINCHESTER WAY	END	105	18	210	0	2.5" Repave	73	\$15,330
588	SHOTGUN ALLEY	UNKNOWN UNK	YAKOBI WAY	201	18	402	0	2.5" Repave	73	\$29,346
43	TOIVO CR	HALIBUT POINT RD	END	411	18	822	0	2.5" Repave	73	\$60,007
378	JEFF DAVIS ST	ETOLIN ST	CRESCENT DR	66	24	176	0	Full Reconstruct	285	\$50,160
466	LINCOLN ST	CATHEDRAL WAY	END	65	18	130	0	Full Reconstruct	285	\$37,050
473	LINCOLN ST	END	MAKSOUTOFF ST	104	36	416	0	Full Reconstruct	285	\$118,560

Road Repair Cost	Cost per SY
Full Reconstruct	\$ 285.00
2.5" Repave	\$ 73.00
Grind/Overlay	\$ 30.00
CPI (avg. last 10-years)	2.7%

Cost Per Remaining Service Life

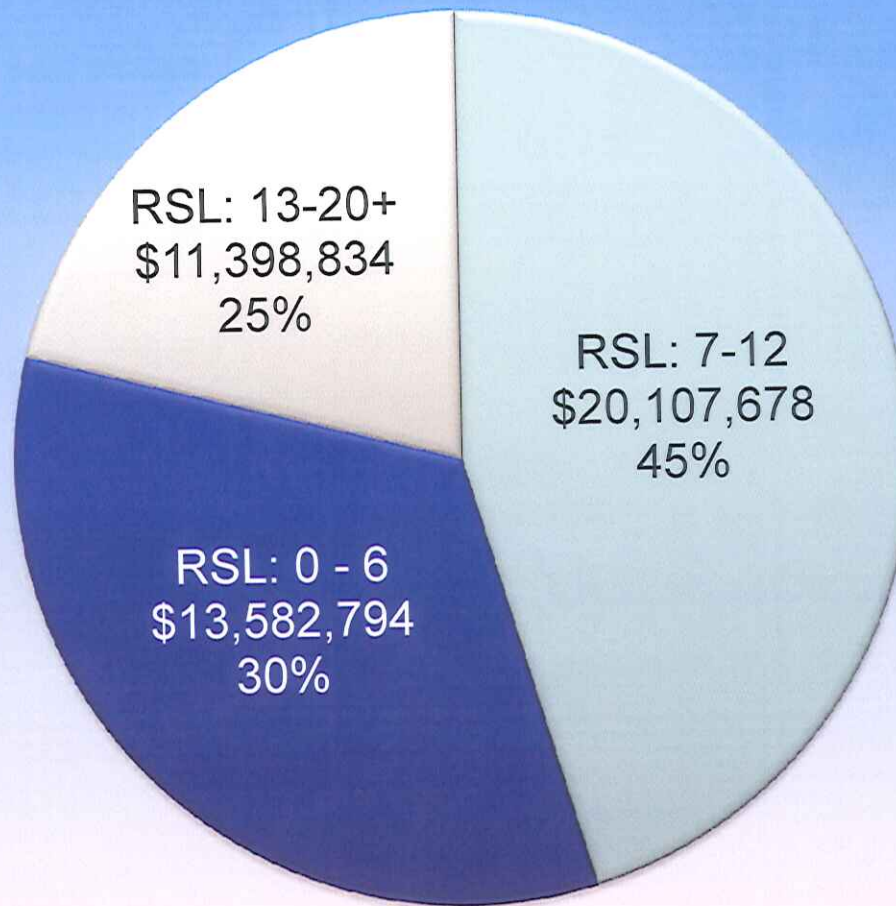

Remaining Service Life Cost Per Year

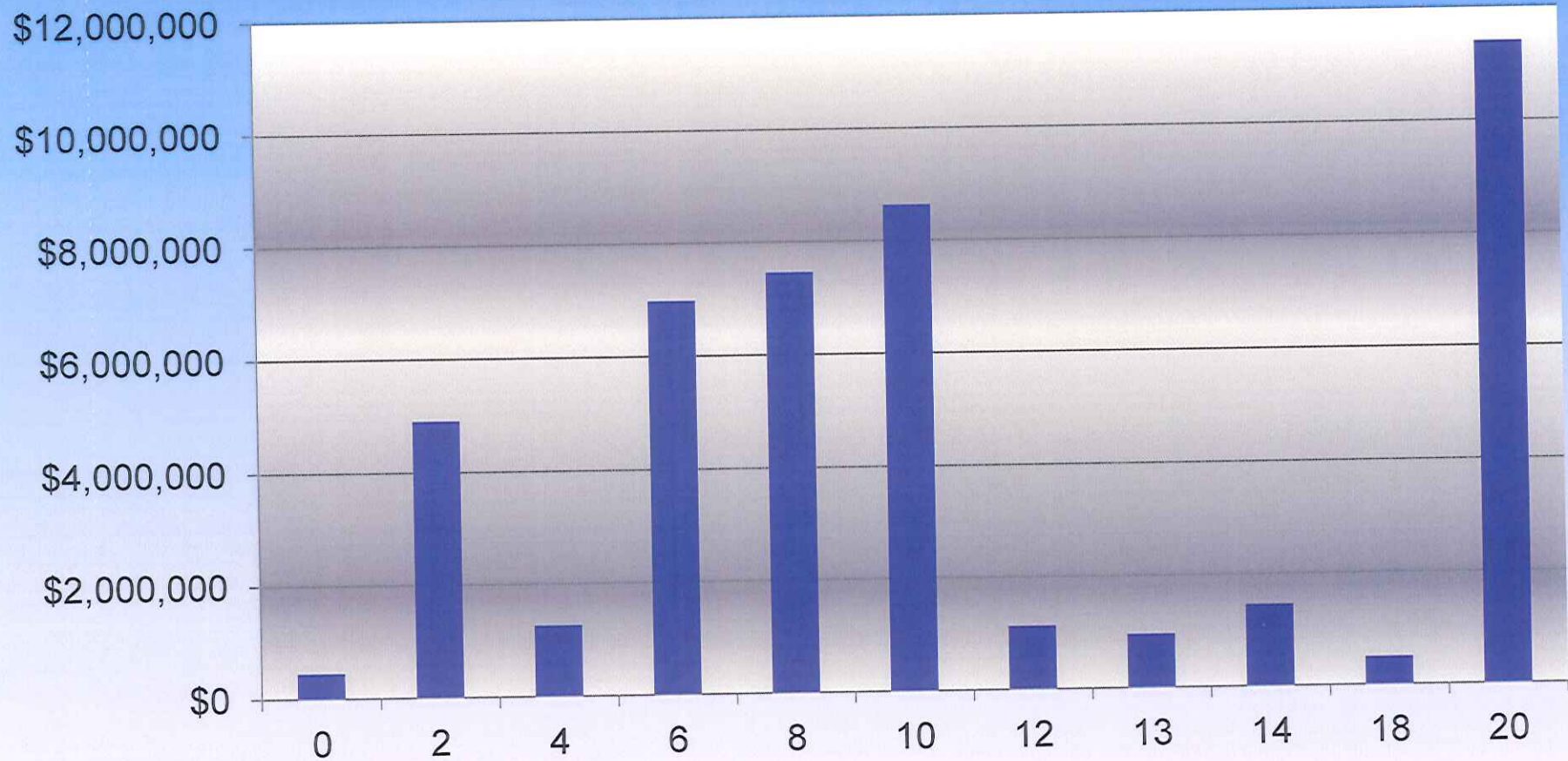

Remaining Service Life



Cumulative Total RSL Cost Total Road System

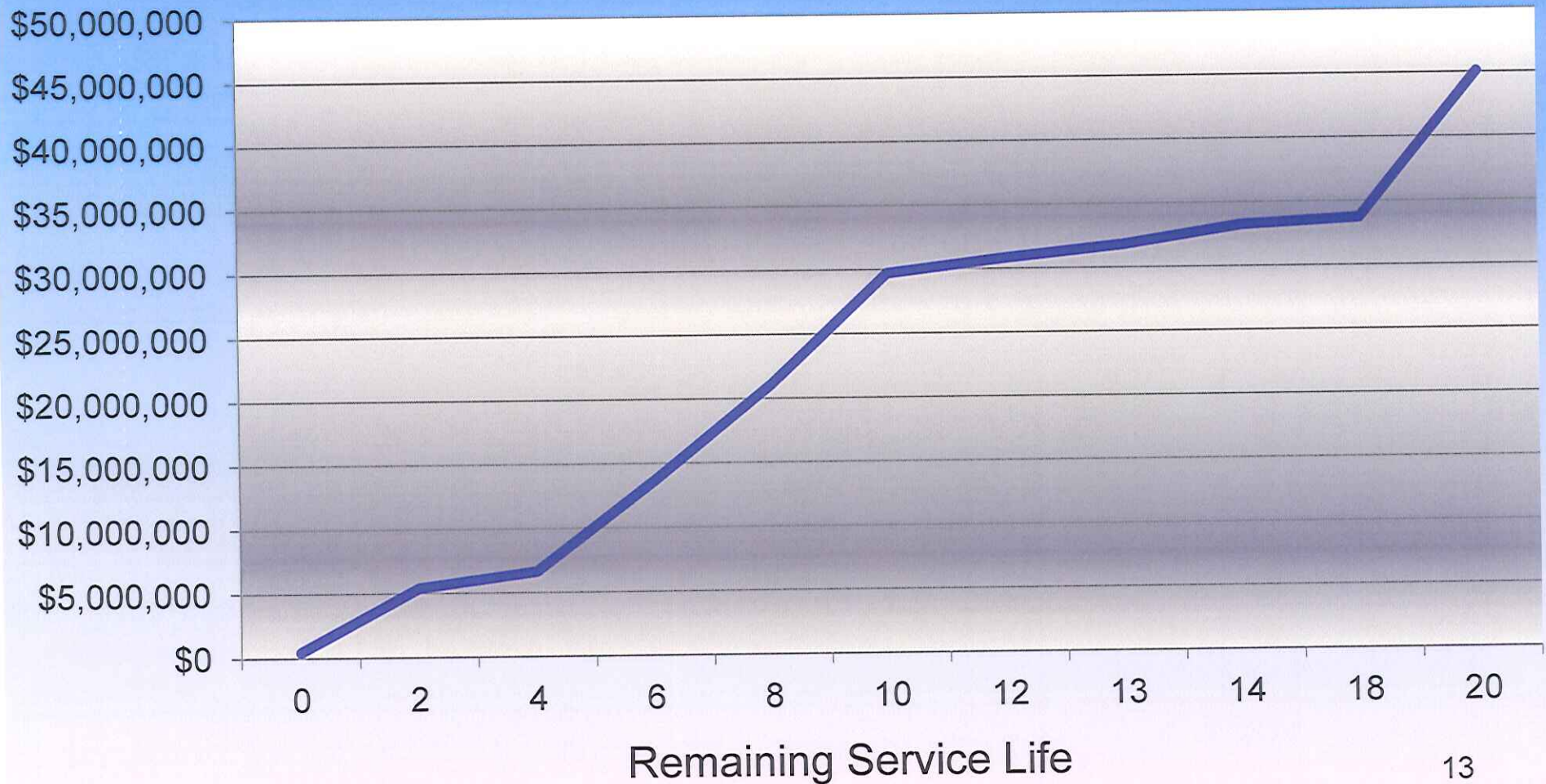

ETOLIN AT PARK RSL- 0



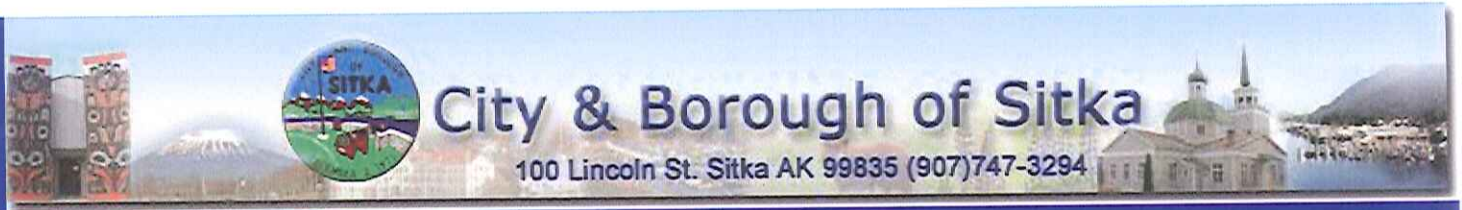

NEW ARCHANGEL RSL - 0





ARROWHEAD RSL - 0

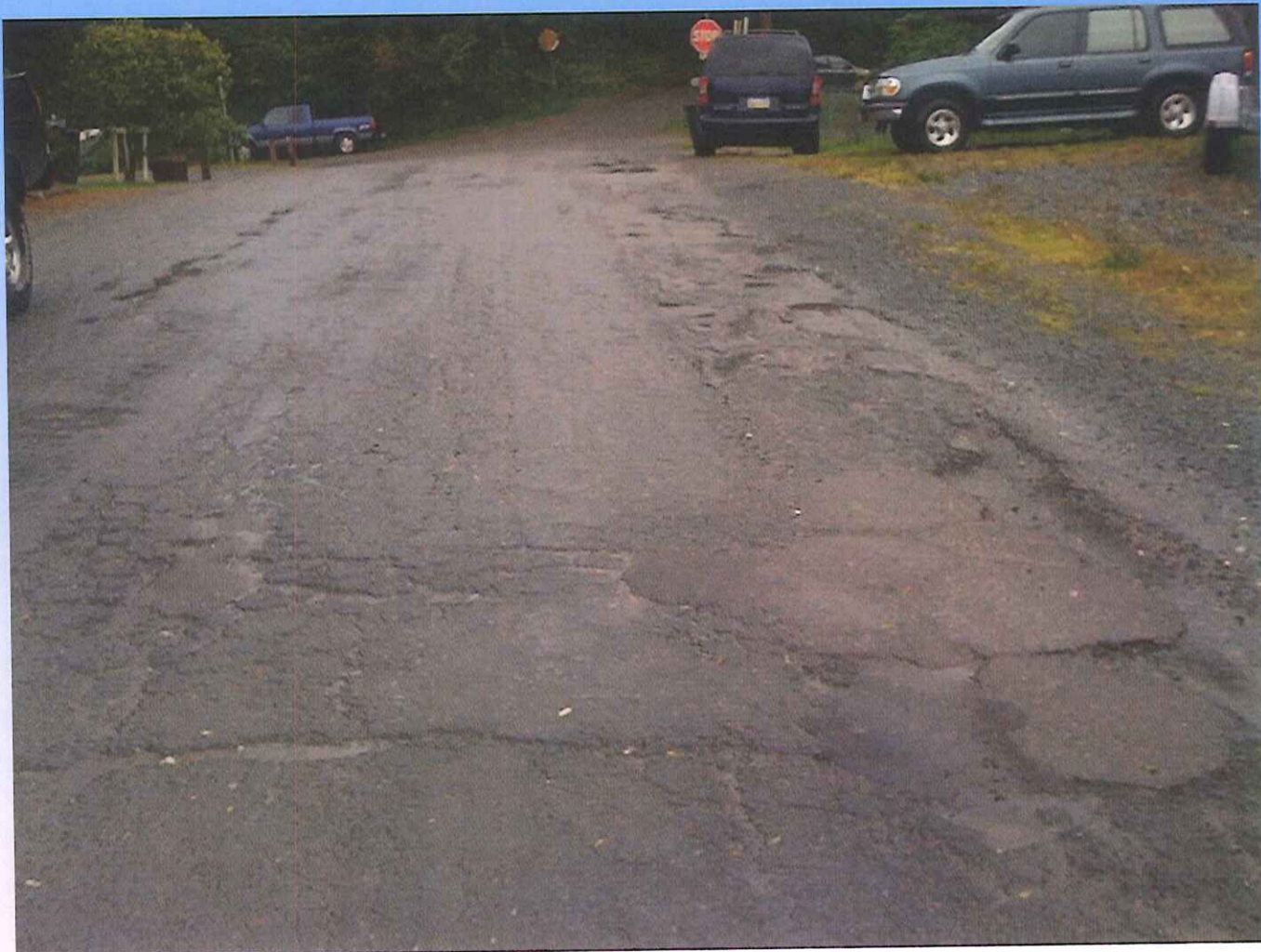

MONASTERY RSL - 2



CASCADE STREET RSL - 2





MONASTERY

RSL - 2



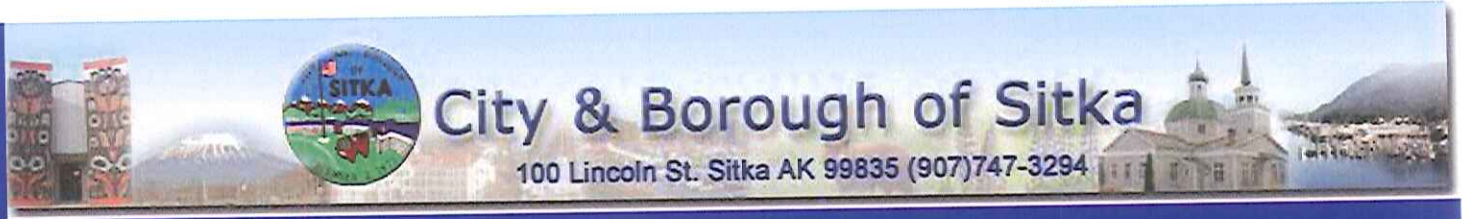

EDGE CUMBE
RSL - 4

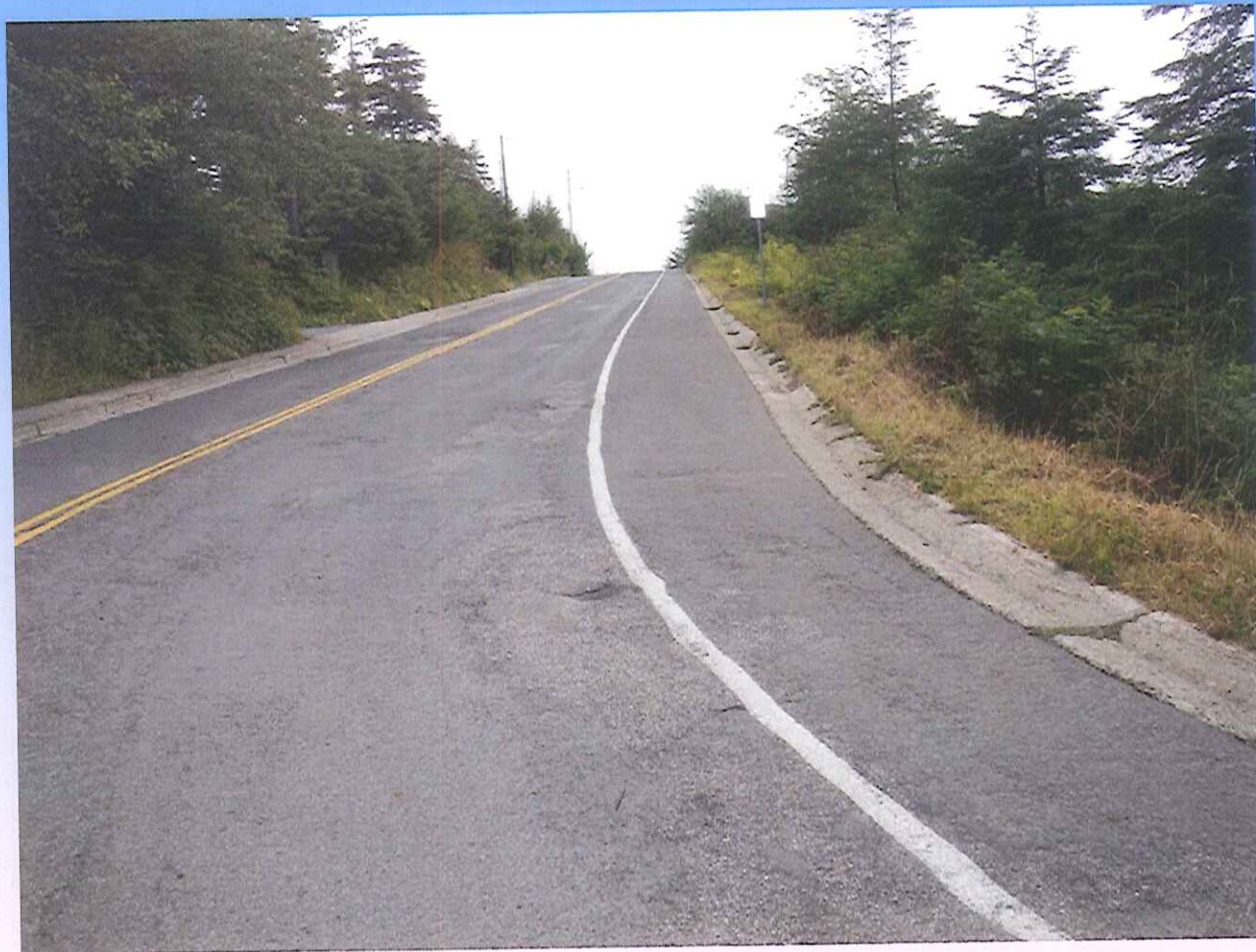

LAKE VIEW
RSL - 4





BARANOF
RSL - 6





BARANOF
RSL - 6





EDGE CUMBE DR
RSL - 6





EDGE CUMBE DR
RSL - 6



DAVIDOFF ST.
RSL - 8





WORTMAN LOOP RSL - 20 REPLACEMENT COMPETED 2010



WORTMAN LOOP RSL - 20 REPLACEMENT COMPETED 2010



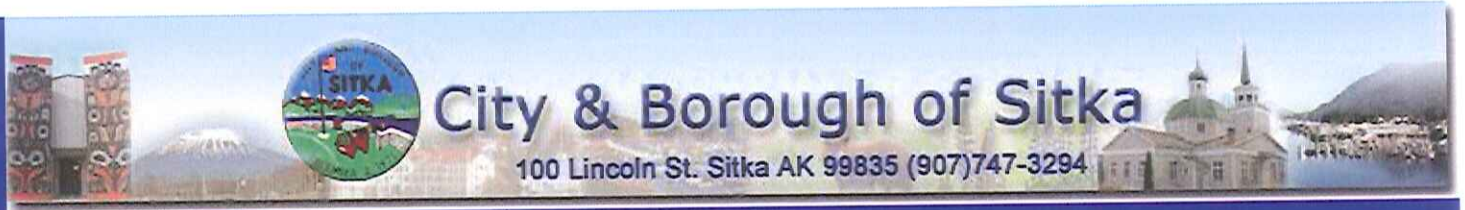

OJA STREET RSL - 20 FULL RECONSTRUCTION IN 2010



MONASTERY STREET UNDER CONSTRUCTION 2011





Cumulative Cost vs. \$2.7-mill per year for 25-years
(\$600k per year beyond 25-Years)

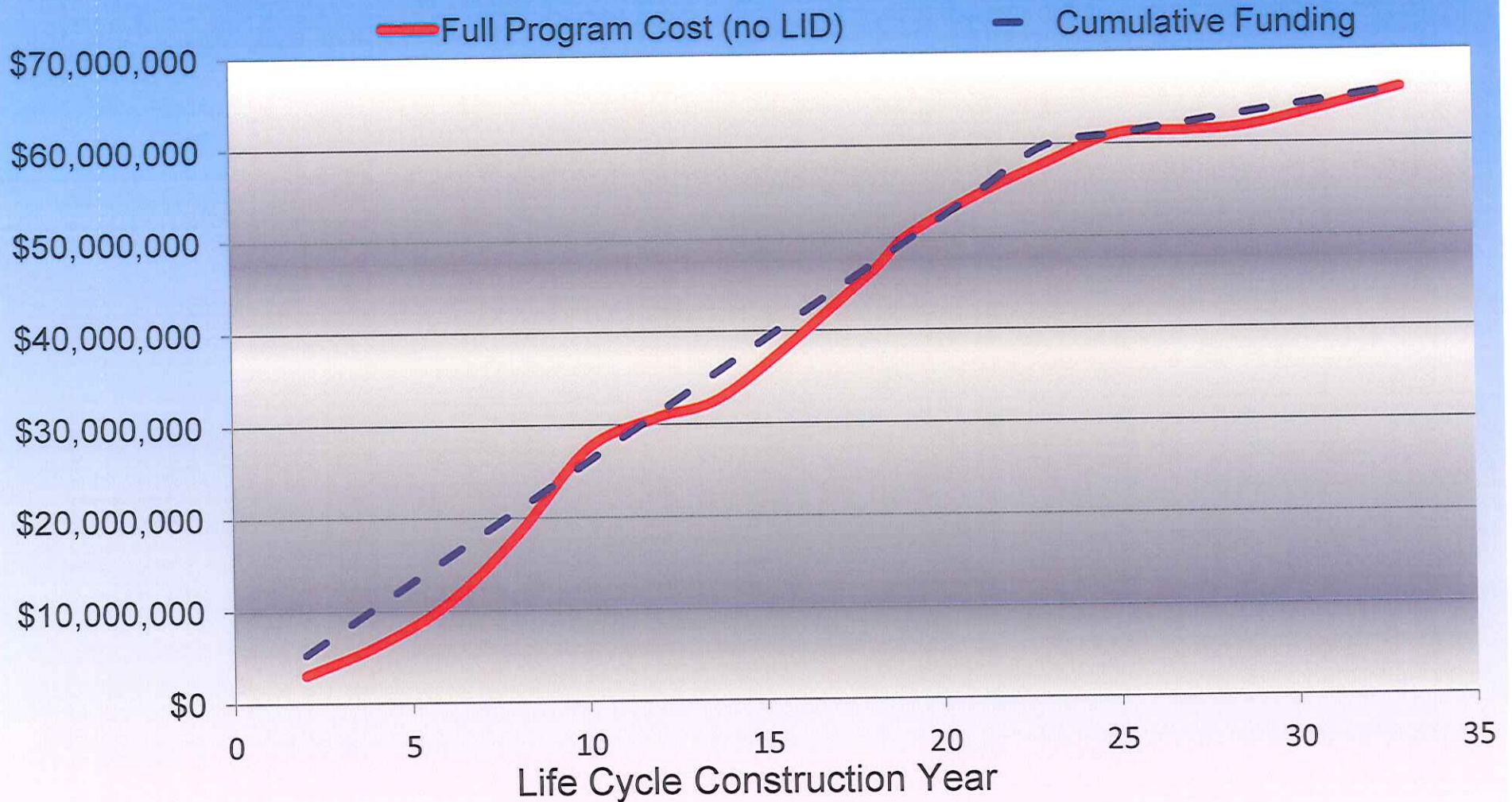

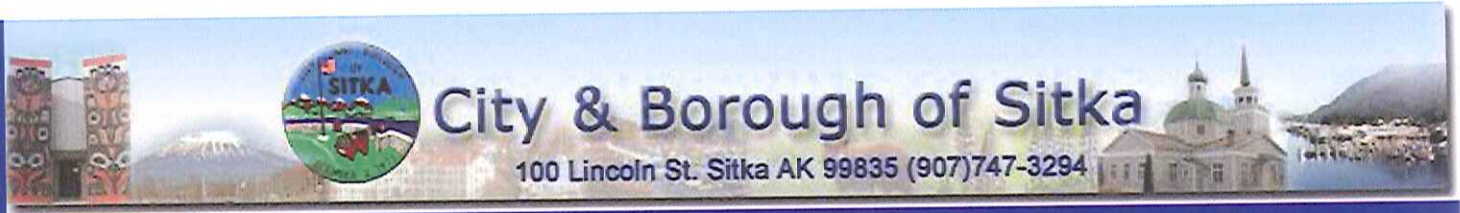

Reducing CBS Cost by Adding LID Program

- Local Improvement Districts (LID) can be formed and assessed the cost to repair streets per current CBS code.
- To maintain the primary road system at a high level LID programs could be focused towards residential street areas only.
- LID programs are more successful when municipalities pay a portion of the cost and provides low interest loans to the owners assessed in order to pay the cost over 20-years.
- The challenges with LID programs are that they require 50% support by the owners within the LID area and the allocation of the assessment can be viewed as unfair.
- LID programs can create a patchwork system whereas some roads may not get repaired and be converted to gravel.



Potential LID Program Scenario

- Focus on the residential streets without curb, gutter and sidewalk.
- Select street sections that make sense functionally as a unit and apply an LID to that section.
- LID expenses are shared 1/3rd for one side of the street, 1/3rd for the opposite side of the street, and 1/3rd by the CBS.
- Separating the residential streets equates to \$14.6 million in construction costs shifted into the LID program.
- There are approximately \$28 million in road repair remaining associate to our primary roads consisting on curb, gutter and sidewalk.

Public Works

Road Master Planning

March 24, 2014



City & Borough of Sitka

100 Lincoln St. Sitka AK 99835 (907)747-3294

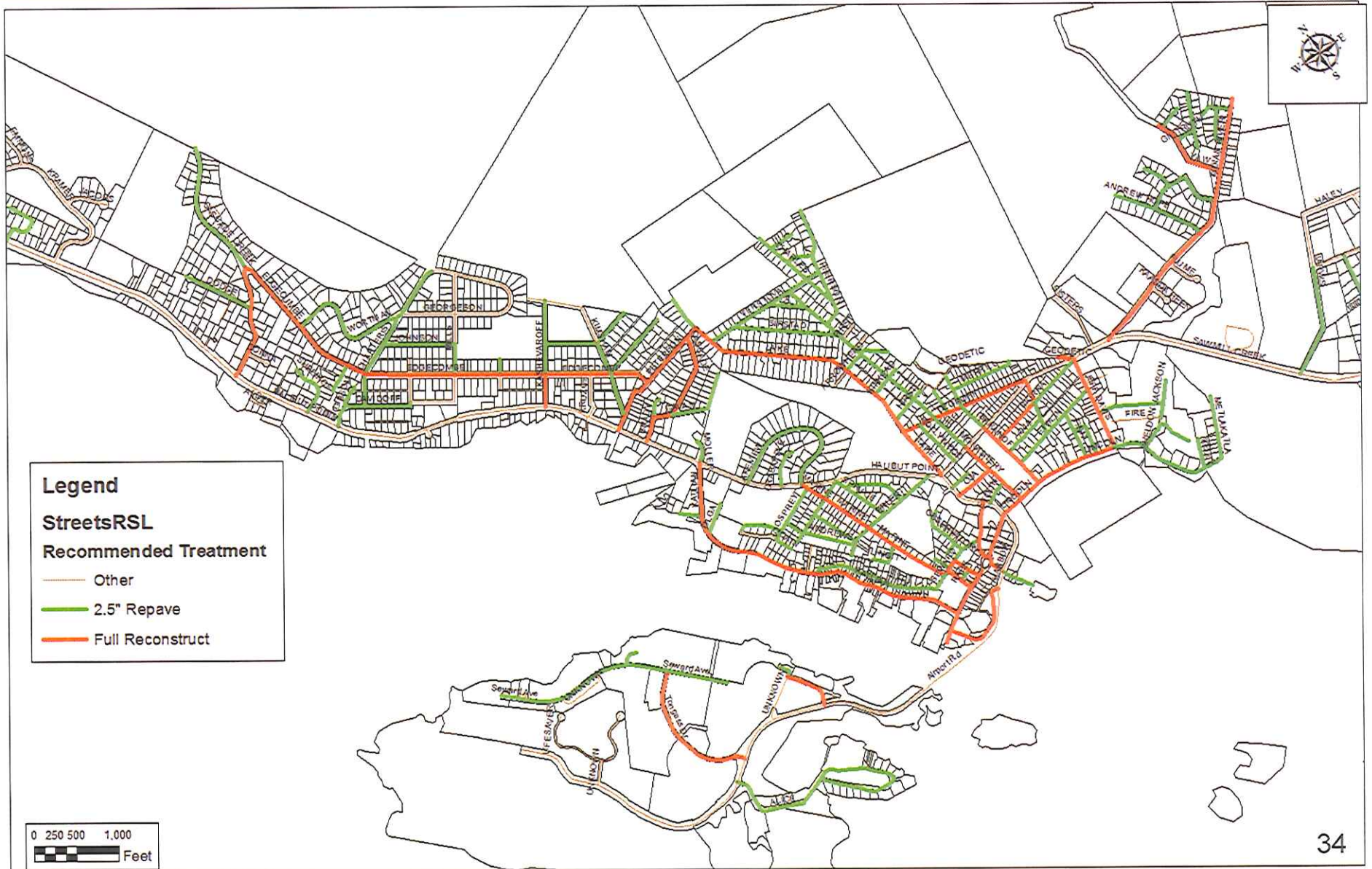

Cumulative Cost with LID Program

(CBS Funding=\$2-mill per year for 25-years; \$600k per year beyond 25-Years)

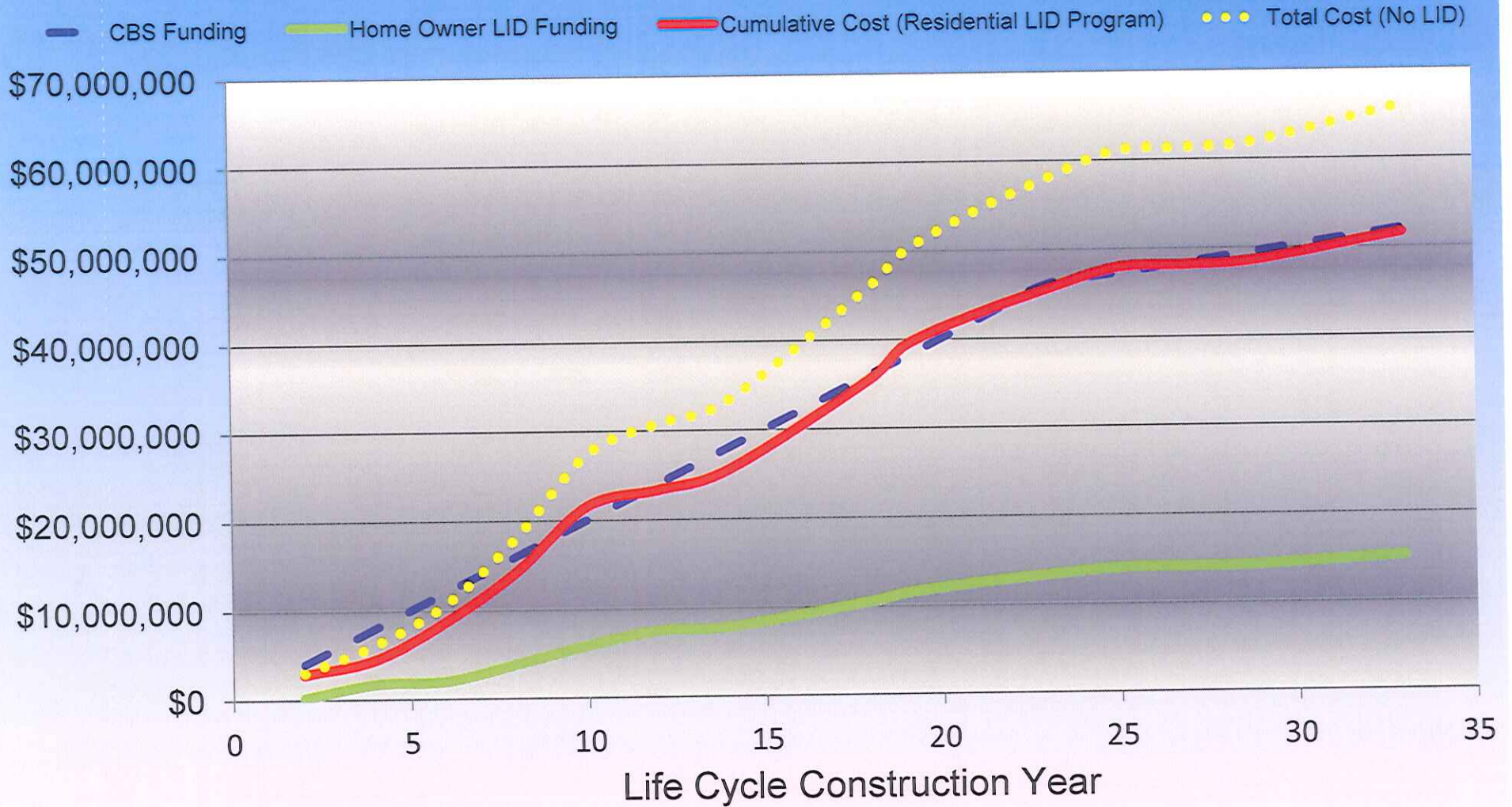



Annual Funding Stats

- Past 12-years from the General Fund:

Year	General Fund
2004	300,000
2005	300,000
2006	150,000
2007	290,000
2008	300,000
2009	300,000
2010	290,000
2011	450,000
2012	425,000
2013	260,000
2014	813,000
2015	1,385,020
Total	5,263,020
Average	438,585

- Pass ordinance dedicating annual funding out of the General Fund for road replacement.
- Continue to build Infrastructure Sinking Fund. Currently there is very little funding in this account.
- Utilize the funding within the LID account to promote road projects such as Gavan and Smith Street.



Annual Funding Stats

- **Sales Tax:**
 - 1% Sales Tax = \$1.6 million
 - 1% Sales Tax in the summer = \$953k
 - 1% Sales Tax in the winter = \$638k
- **Property Tax:**
 - One millage rate = \$1 million
- **Vehicle Licensing Fees:**
 - Adding CBS fee to State Licensing \$500k to \$1-million
- **LID Funding:**
 - Residential Streets and 2/3^{rds} \$700k
- **Grant Funding:**
 - Continue to utilize utility DEC funding when appropriate
 - State and Federal funding for roads is not likely



Potential Funding Scenarios (No LID)

- Annual Road Program No LID (\$2.7-mill annually):
 - General Fund= \$1,062,000
 - State Vehicle License Fee= \$ 500,000
 - 1% Sales Tax in the winter= \$ 638,000
 - Sales Tax Exemption Reduction= \$ 500,000

- Annual Road Program No LID (\$2.7-mill annually):
 - General Fund= \$1,362,000 (Same as FY15)
 - Property Tax 1/2 Millage Rate= \$ 500,000
 - 1% Sales Tax in the winter= \$ 638,000
 - Sales Tax Exemption Reduction= \$ 200,000

- Annual Road Program No LID (\$2.7-mill annually):
 - General Fund= \$1,100,000
 - 1% Sales Tax= \$1,600,000



Potential Funding Scenarios LID

- Annual Road Program with Residential LID (\$2-mill annually):
 - General Fund= \$1,000,000
 - Property Tax One Millage Rate= \$1,000,000

- Annual Road Program with Residential LID (\$2-mill annually):
 - General Fund= \$1,062,000
 - State Vehicle License Fee= \$ 200,000
 - 1% Sales Tax in the winter= \$ 638,000
 - Sales Tax Exemption Reduction= \$ 100,000

- Annual Road Program with Residential LID (\$2-mill annually):
 - General Fund= \$1,362,000 (Same as FY15)
 - 1% Sales Tax in the winter= \$ 638,000

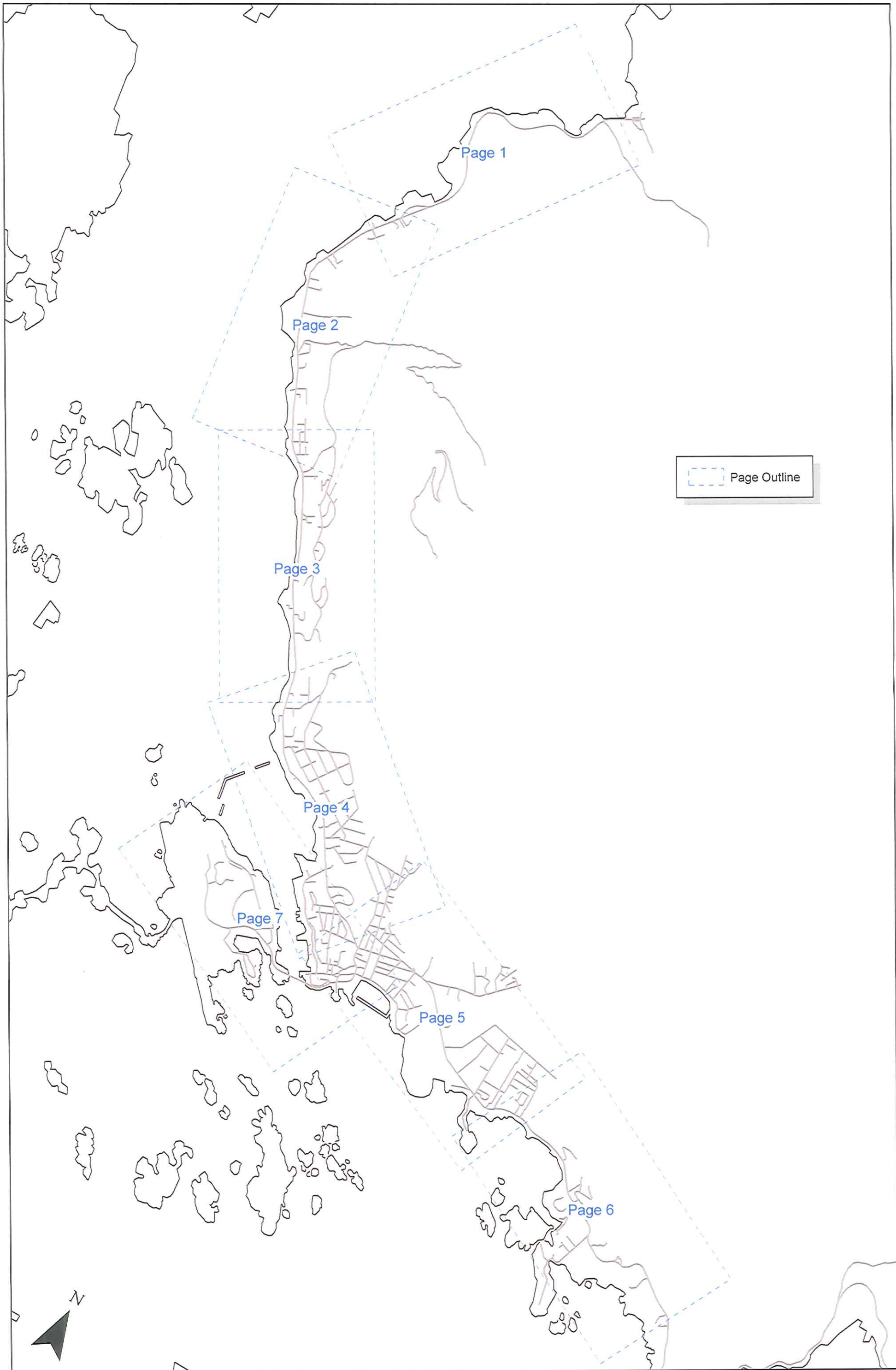

 Page Outline

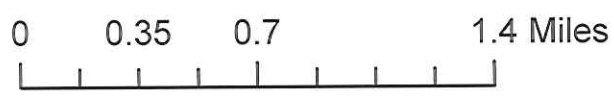

Map Index



City and Borough of Sitka

PUBLIC WORKS
100 LINCOLN STREET • SITKA, ALASKA 99835
PHONE (907) 747-1804 • FAX (907) 747-3158



0 0.05 0.1 0.2 Miles

Remaining Service Life



City and Borough of Sitka
 PUBLIC WORKS
 100 LINCOLN STREET • SITKA, ALASKA 99835
 PHONE (907) 747-1804 • FAX (907) 747-3158

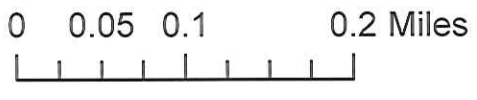
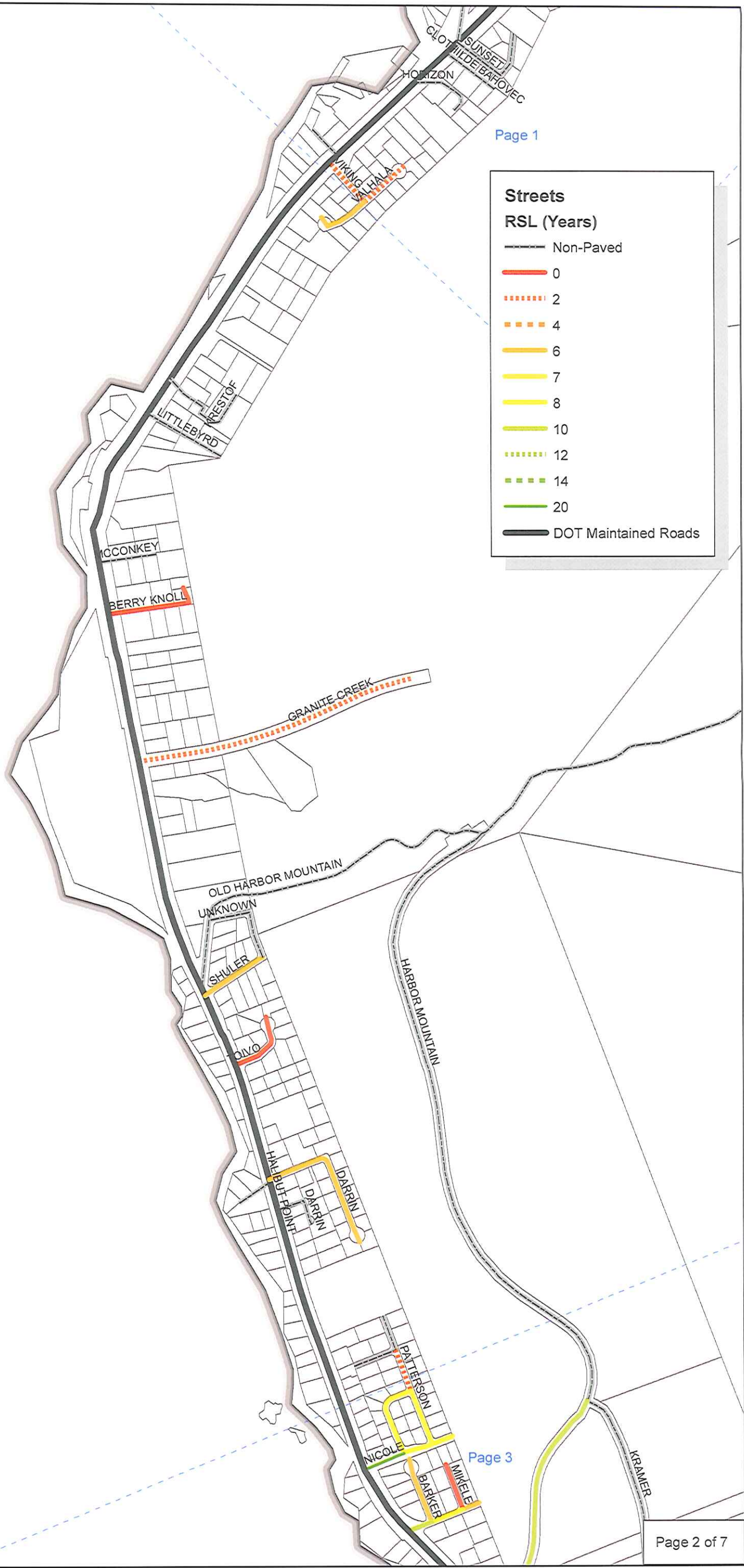
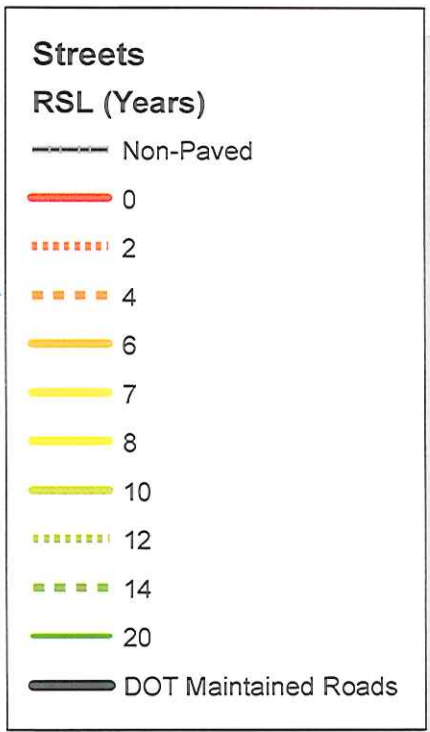

Remaining Service Life



City and Borough of Sitka

PUBLIC WORKS
100 LINCOLN STREET • SITKA, ALASKA 99835
PHONE (907) 747-1804 • FAX (907) 747-3150

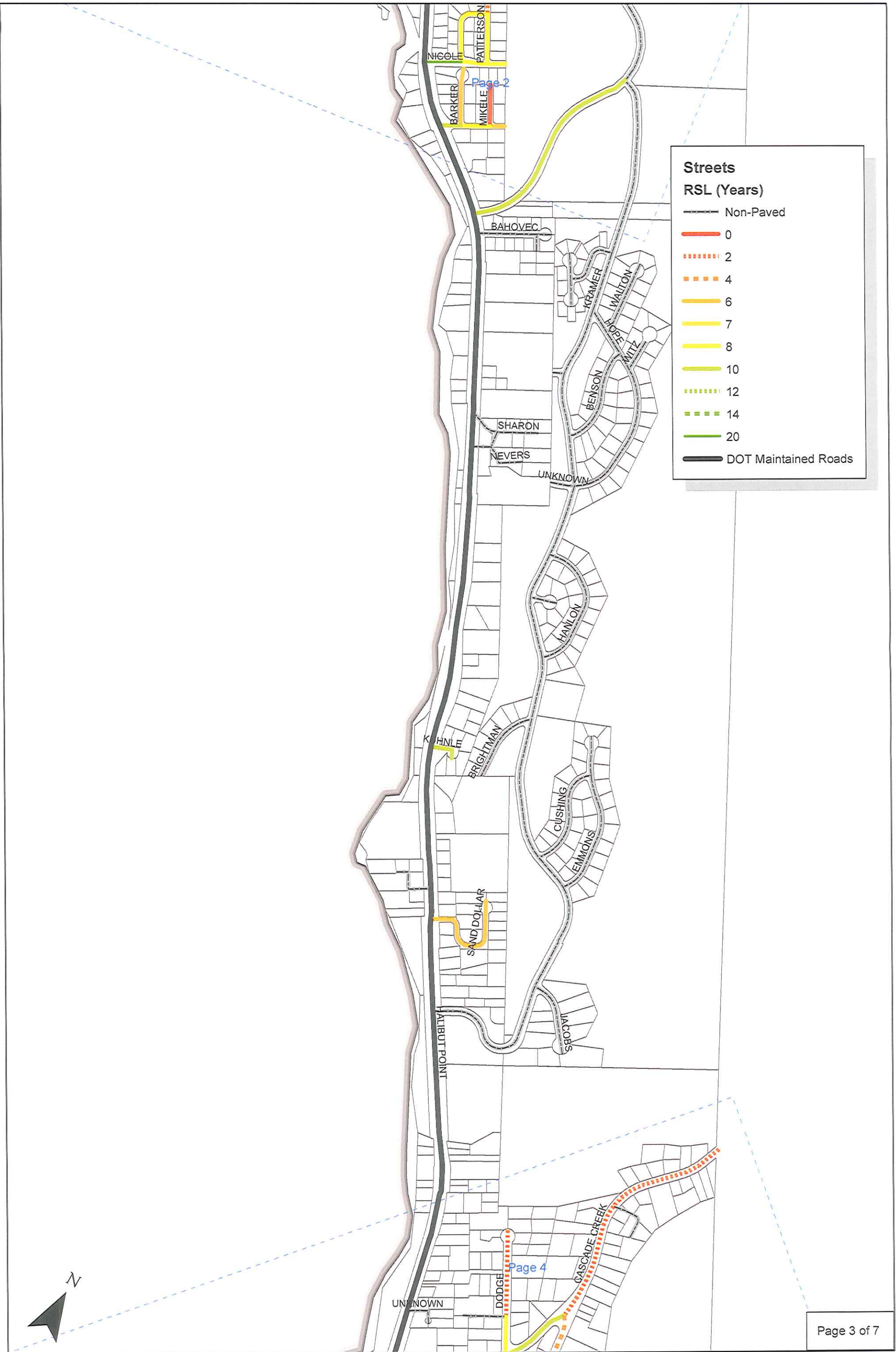

0 0.05 0.1 0.2 Miles

Remaining Service Life



City and Borough of Sitka

PUBLIC WORKS
 100 LINCOLN STREET • SITKA, ALASKA 99835
 PHONE (907) 747-1804 • FAX (907) 747-3158

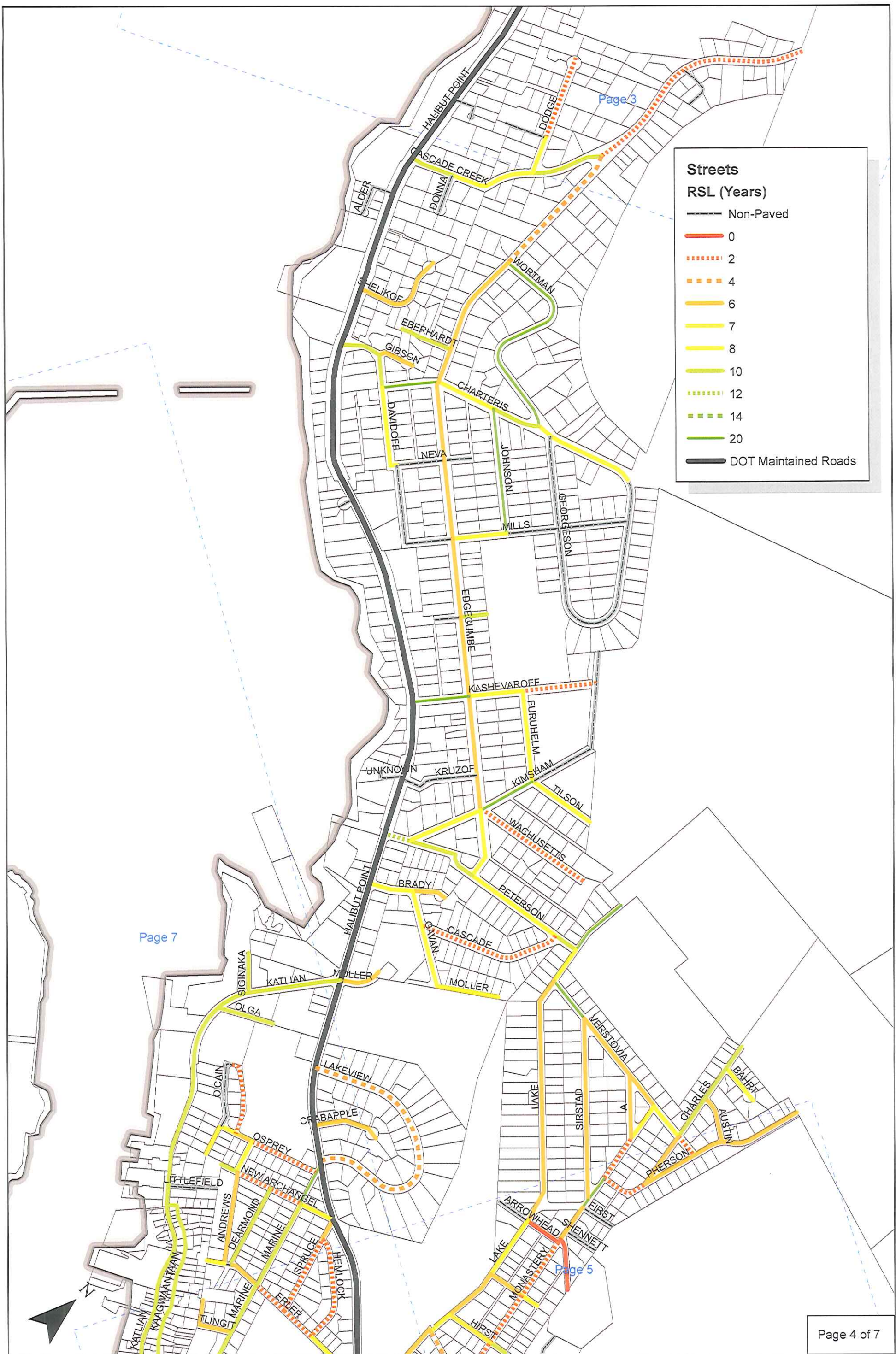

Page 3

Page 7

Page 5

Page 4 of 7



Remaining Service Life



City and Borough of Sitka

PUBLIC WORKS
100 LINCOLN STREET • SITKA, ALASKA 99635
PHONE (907) 747-1804 • FAX (907) 747-3158

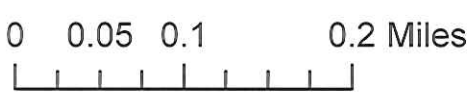
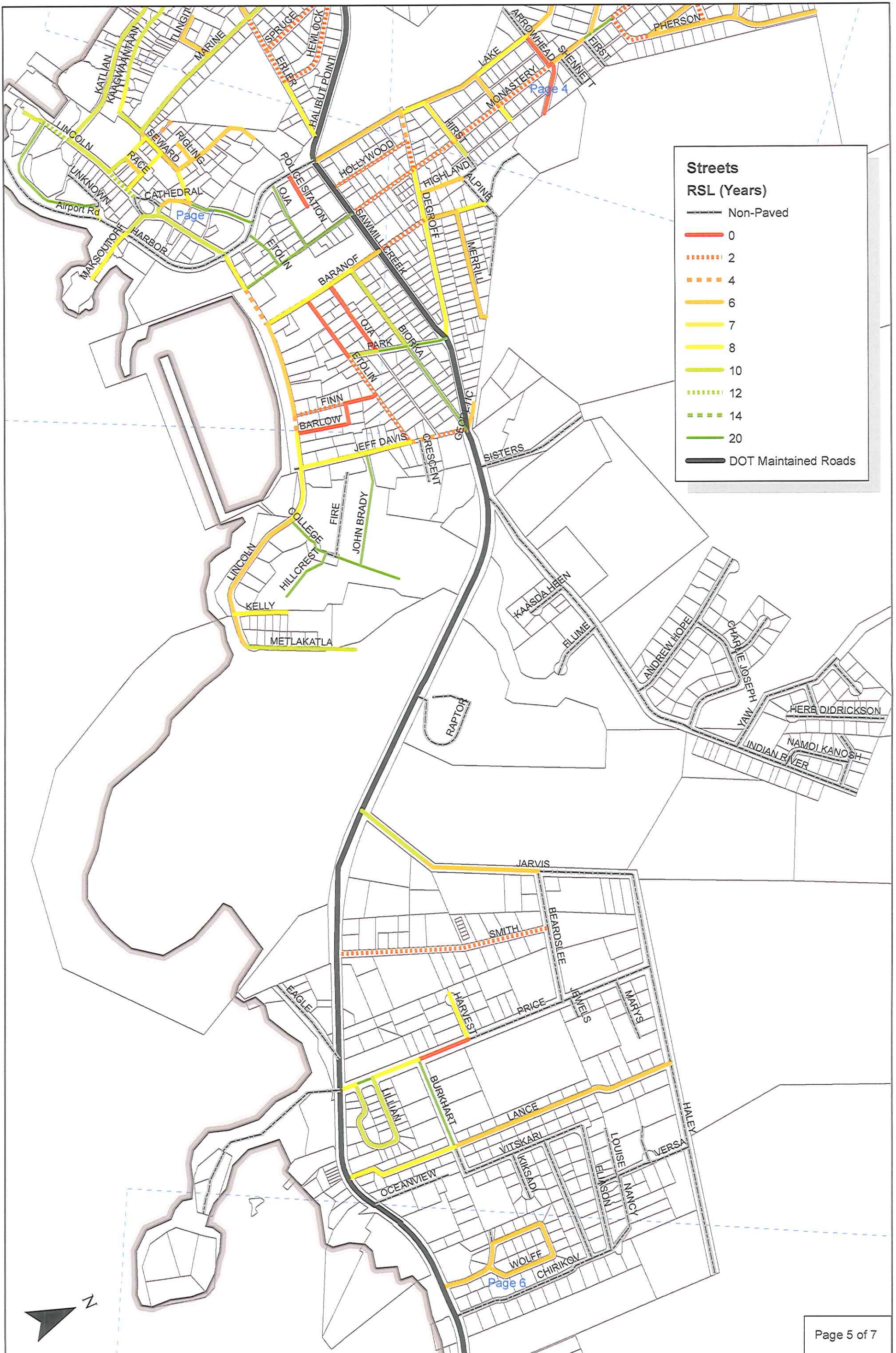

Remaining Service Life



City and Borough of Sitka

PUBLIC WORKS
 100 LINCOLN STREET • SITKA, ALASKA 99835
 PHONE (907) 747-1804 • FAX (907) 747-3158

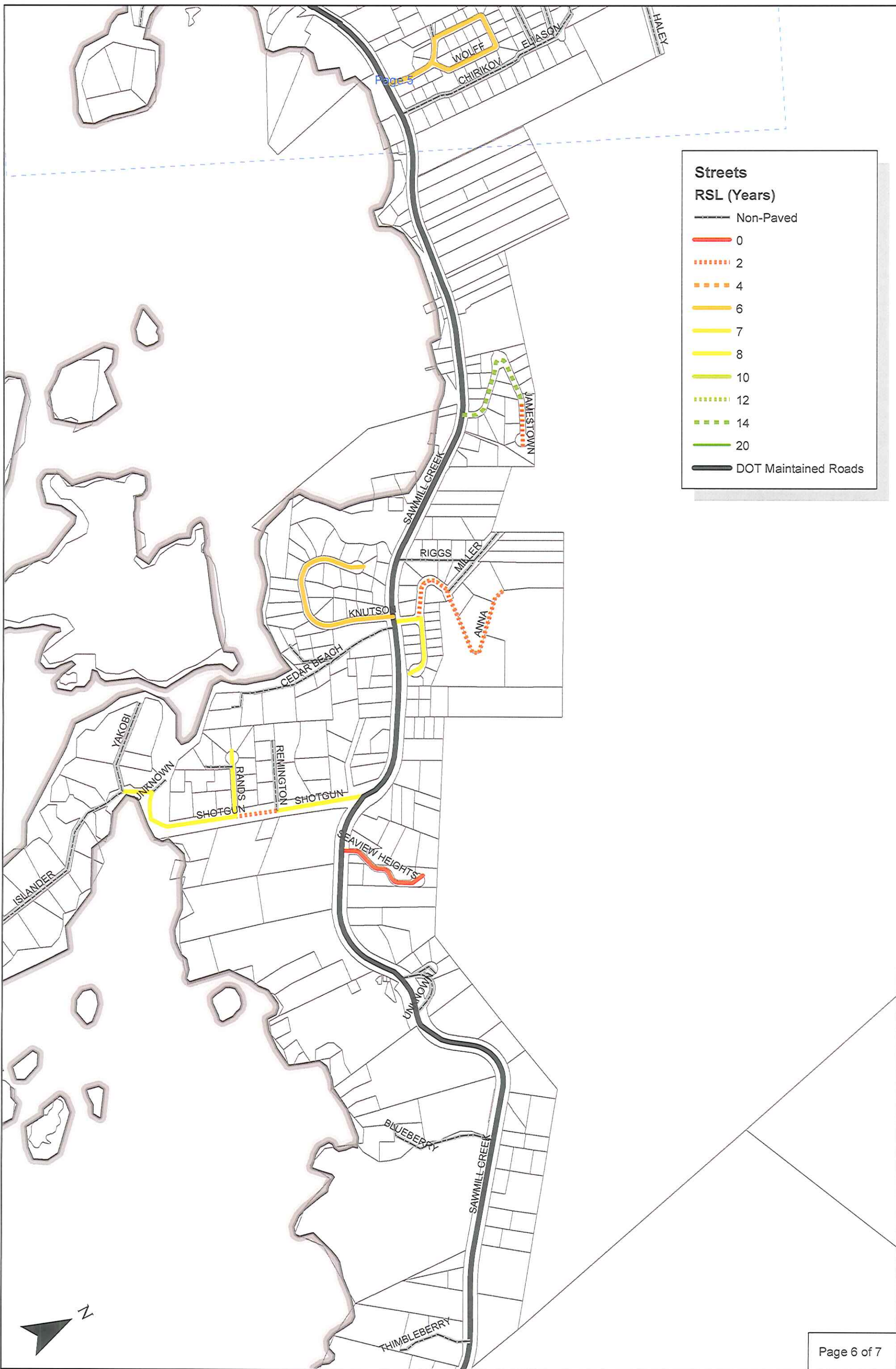

Streets
RSL (Years)

- Non-Paved
- 0
- · · 2
- · · 4
- 6
- 7
- 8
- 10
- · · 12
- · · 14
- 20
- DOT Maintained Roads



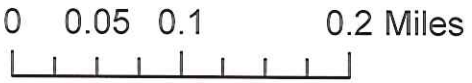
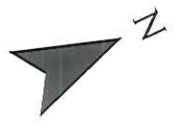
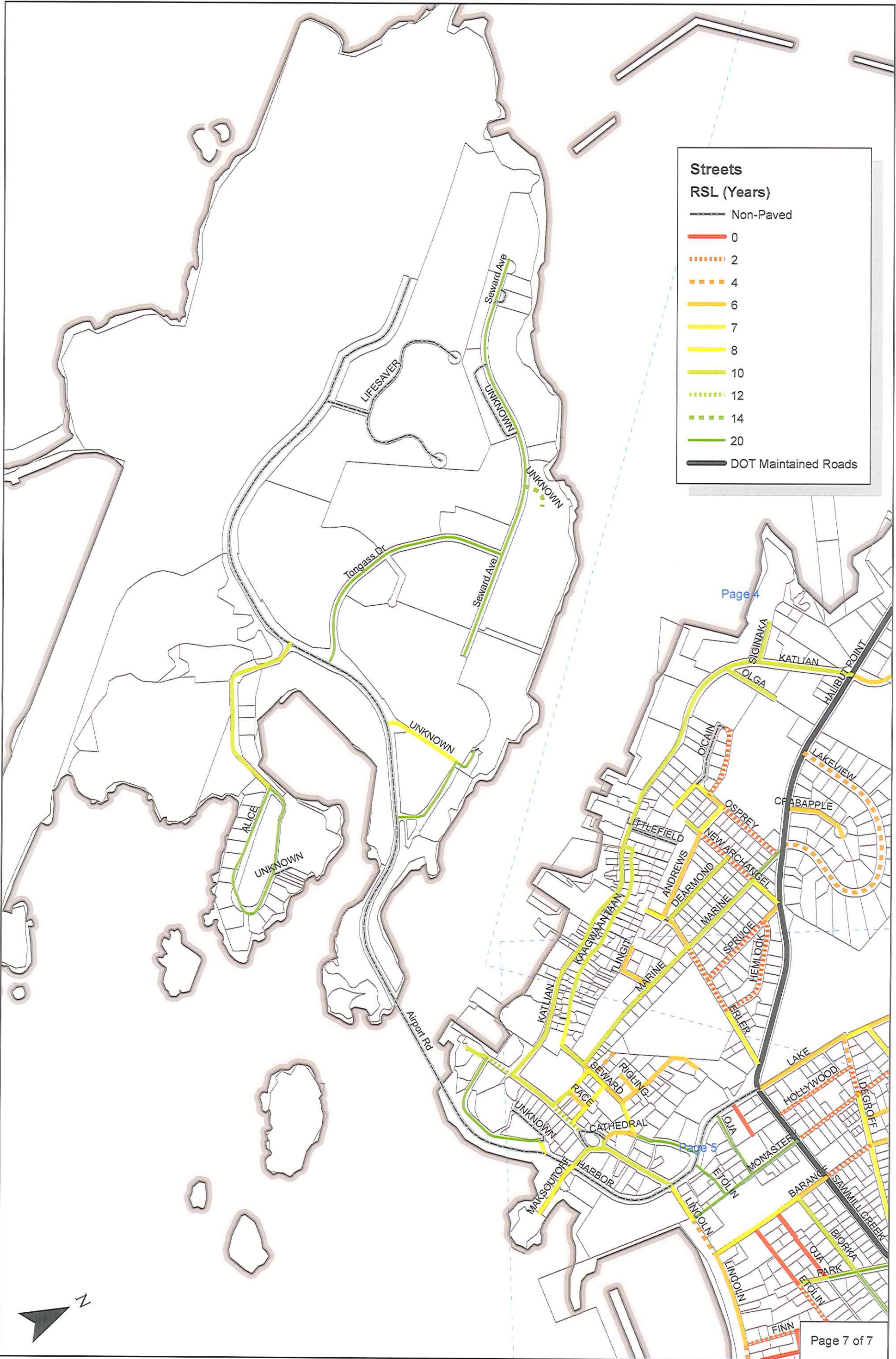

Remaining Service Life



City and Borough of Sitka

PUBLIC WORKS
100 LINCOLN STREET • SITKA, ALASKA 99835
PHONE (907) 747-1804 • FAX (907) 747-3158

TOTAL ROAD INVENTORY SORTED BY REMAINING SERVICE LIFE

Location ID	Road Name	From	To	Length (ft)	Width (ft)	Area (yd^2)	RSL	Recommended Treatment	Treatment Costs/YD^2	Estimated Cost
400	FINN ALLEY	ETOLIN ST	BARLOW ST	218	12	291	0	2.5" Repave	73	\$21,219
545	LANCE DR	VITSKARI ST	SAWMILL CREEK RD	792	18	1584	0	2.5" Repave	73	\$115,632
579	RANDS DR	WINCHESTER WAY	END	105	18	210	0	2.5" Repave	73	\$15,330
588	SHOTGUN ALLEY	UNKNOWN UNK	YAKOBI WAY	201	18	402	0	2.5" Repave	73	\$29,346
43	TOIVO CR	HALIBUT POINT RD	END	411	18	822	0	2.5" Repave	73	\$60,007
378	JEFF DAVIS ST	ETOLIN ST	CRESCENT DR	66	24	176	0	Full Reconstruct	285	\$50,160
466	LINCOLN ST	CATHEDRAL WAY	END	65	18	130	0	Full Reconstruct	285	\$37,050
473	LINCOLN ST	END	MAKSOUTOFF ST	104	36	416	0	Full Reconstruct	285	\$118,560
150	CHARTERIS ST	DAVIDOFF ST	EDGECOMBE DR	389	20	865	2	2.5" Repave	77	\$66,616
385	ETOLIN ST	FINN Alley	JEFF DAVIS ST	404	10	449	2	2.5" Repave	77	\$34,562
390	ETOLIN ST	PARK ST	FINN Alley	319	10	354	2	2.5" Repave	77	\$27,291
344	HEMLOCK ST	SPRUCE ST	ERLER ST	739	18	1478	2	2.5" Repave	77	\$113,799
598	JAMESTOWN	JAMESTOWN	END	287	16	510	2	2.5" Repave	77	\$39,256
155	JOHNSON ST	MILLS ST	CHARTERIS ST	856	24	2284	2	2.5" Repave	77	\$175,854
513	LANCE DR	VITSKARI ST	HALEY WAY	1595	18	3190	2	2.5" Repave	77	\$245,615
509	LINCOLN ST	COLLEGE DR	KELLY ST	808	24	2155	2	2.5" Repave	77	\$165,899
470	LINCOLN ST	JEFF DAVIS ST	COLLEGE DR	381	24	1016	2	2.5" Repave	77	\$78,227
511	LINCOLN ST	KELLY ST	METLAKATLA ST	242	24	645	2	2.5" Repave	77	\$49,688
62	MIKELE ST	ROSS STREET	END	284	12	378	2	2.5" Repave	77	\$29,126
252	MONASTERY ST	ARROWHEAD ST	KINKEAD ST	439	14	683	2	2.5" Repave	77	\$52,579
297	MONASTERY ST	HIRST ST	DEGROFF ST	347	14	540	2	2.5" Repave	77	\$41,560
275	MONASTERY ST	KINKEAD ST	HIRST ST	389	14	605	2	2.5" Repave	77	\$46,591
220	MONASTERY ST	IPHERSON ST	A ST	330	18	660	2	2.5" Repave	77	\$50,782
311	OCAIN ST	OSPREY ST	END OF PAVEMENT	511	12	681	2	2.5" Repave	77	\$52,468
296	OSPREY ST	MARINE ST	ANDREWS ST	490	18	980	2	2.5" Repave	77	\$75,455
54	PATTERSON WAY	SOMER DR	KINCROFT WAY	262	12	349	2	2.5" Repave	77	\$26,881
219	IPHERSON ST	CHARLES ST	MONASTERY ST	328	18	657	2	2.5" Repave	77	\$50,560
512	PRICE ST	BURKHART ST	HARVEST ST	369	24	984	2	2.5" Repave	77	\$75,763
580	SHOTGUN Alley	RANDS	REMINGTON DR	795	18	1590	2	2.5" Repave	77	\$122,422
225	SIRSTAD ST	VERSTOVA ST	MONASTERY ST	1243	18	2485	2	2.5" Repave	77	\$191,348
522	SMITH ST	SAWMILL CREEK RD	BEARDSLEE WAY	1466	24	3909	2	2.5" Repave	77	\$301,000
25	VIKING WAY	HALIBUT POINT RD	VALHALA WAY	316	16	561	2	2.5" Repave	77	\$43,215
213	CASCADE ST	GAVAN ST	PETERSON ST	1002	36	4006	2	Full Reconstruct	301	\$1,204,274
305	DEGROFF ST	HIGHLAND ST	MONASTERY ST	175	32	623	2	Full Reconstruct	301	\$187,311
298	DEGROFF ST	MONASTERY ST	HOLLYWOOD WAY	198	24	527	2	Full Reconstruct	301	\$158,484

TOTAL ROAD INVENTORY SORTED BY REMAINING SERVICE LIFE

Location ID	Road Name	From	To	Length (ft)	Width (ft)	Area (yd^2)	RSL	Recommended Treatment	Treatment Costs/YD^2	Estimated Cost
444	JEFF DAVIS ST	LINCOLN ST	JOHN BRADY DR	456	24	1216	2	Full Reconstruct	301	\$365,527
345	JEFF DAVIS ST	OJA ST	BIORKA ST	201	24	536	2	Full Reconstruct	301	\$161,120
490	UNKNOWN	UNKNOWN	Airport Rd	622	24	1659	2	Full Reconstruct	301	\$498,591
431	FINN ALLEY	BARLOW ST	LINCOLN ST	359	12	479	4	2.5" Repave	81	\$38,872
278	LAKEVIEW DR	HALIBUT POINT RD	HALIBUT POINT RD	1917	18	3834	4	2.5" Repave	81	\$311,356
451	PRINCESS WAY	END	SEWARD ST	206	12	275	4	2.5" Repave	81	\$22,305
294	DEGROFF ST	HOLLYWOOD WAY	LAKE ST	196	24	522	4	Full Reconstruct	317	\$165,467
368	JEFF DAVIS ST	CRESCENT DR	OJA ST	130	24	347	4	Full Reconstruct	317	\$109,910
401	JEFF DAVIS ST	JOHN BRADY DR	ETOLIN ST	313	24	835	4	Full Reconstruct	317	\$264,630
435	LINCOLN ST	FINN Alley	BARLOW ST	122	24	325	4	Full Reconstruct	317	\$103,147
424	LINCOLN ST	MONASTERY ST	BARANOF ST	283	24	755	4	Full Reconstruct	317	\$239,266
552	ANNA DR	MILLER DR	END	969	18	1938	6	2.5" Repave	86	\$165,997
191	AUSTIN ST	IPHERSON ST	CHARLES ST	328	18	656	6	2.5" Repave	86	\$56,189
308	BARANOF ST	DEGROFF ST	MERRILL ST	225	18	450	6	2.5" Repave	86	\$38,544
434	BARLOW ST	FINN Alley	LINCOLN ST	504	8	448	6	2.5" Repave	86	\$38,373
212	BRADY ST	GAVAN ST	END	234	36	936	6	2.5" Repave	86	\$80,184
122	CASCADE CREEK RD	EDGECOMBE DR	CEDAR HEIGHTS RD	827	18	1654	6	2.5" Repave	86	\$141,656
216	CHARLES ST	IPHERSON ST	VERSTOVA ST	400	18	800	6	2.5" Repave	86	\$68,534
268	CRABAPPLE DR	END	HALIBUT POINT RD	466	18	932	6	2.5" Repave	86	\$79,829
50	DARRIN DR	END	HALIBUT POINT RD	889	18	1779	6	2.5" Repave	86	\$152,336
123	DODGE CR	UNKNOWN UNK	END	603	18	1206	6	2.5" Repave	86	\$103,256
356	ERLER ST	DEARMOND ST	MARINE ST	231	16	411	6	2.5" Repave	86	\$35,175
149	GIBSON PL	DAVIDOFF ST	END	252	12	335	6	2.5" Repave	86	\$28,728
304	HIGHLAND ST	ALPINE ST	DEGROFF ST	318	18	636	6	2.5" Repave	86	\$54,476
281	HIRST ST	LAKE ST	MONASTERY ST	333	14	518	6	2.5" Repave	86	\$44,369
258	KINKEAD ST	LAKE ST	MONASTERY ST	258	14	401	6	2.5" Repave	86	\$34,376
564	KNUTSON DR	SAWMILL CREEK RD	END	1353	18	2706	6	2.5" Repave	86	\$231,779
295	MERRILL ST	BARANOF ST	END	774	12	1032	6	2.5" Repave	86	\$88,394
234	MOLLER DR	HALIBUT POINT	END	288	24	768	6	2.5" Repave	86	\$65,805
236	MONASTERY ST	ARROWHEAD ST	SHENNETT ST	71	18	142	6	2.5" Repave	86	\$12,174
231	MONASTERY ST	SHENNETT ST	FIRST ST	200	18	399	6	2.5" Repave	86	\$34,205
421	OBSERVATORY ST	END	RIGLING WAY	534	18	1068	6	2.5" Repave	86	\$91,478
436	OBSERVATORY ST	RIGLING WAY	SEWARD ST	114	10	127	6	2.5" Repave	86	\$10,849
306	OSPREY ST	ANDREWS ST	OCAIN ST	124	18	248	6	2.5" Repave	86	\$21,242
190	IPHERSON ST	AUSTIN ST	END	568	18	1136	6	2.5" Repave	86	\$97,302

TOTAL ROAD INVENTORY SORTED BY REMAINING SERVICE LIFE

Location ID	Road Name	From	To	Length (ft)	Width (ft)	Area (yd^2)	RSL	Recommended Treatment	Treatment Costs/YD^2	Estimated Cost
204	PERSON ST	VERSTOVA ST	AUSTIN ST	213	18	426	6	2.5" Repave	86	\$36,488
215	PERSON ST	VERSTOVA ST	CHARLES ST	390	18	781	6	2.5" Repave	86	\$66,860
471	RACE ST	AMERICAN ST	BARRACKS ST	153	18	306	6	2.5" Repave	86	\$26,210
426	RIGLING WAY	END	OBSERVATORY ST	148	10	164	6	2.5" Repave	86	\$14,085
61	ROSS STREET	END	MIKELE ST	102	12	136	6	2.5" Repave	86	\$11,620
115	SAND DOLLAR DR	HALIBUT POINT RD	END	787	12	1050	6	2.5" Repave	86	\$89,895
443	SEWARD AVE	UNKNOWN	UNKNOWN	195	24	520	6	2.5" Repave	86	\$44,540
446	SEWARD ST	AMERICAN ST	OBSERVATORY ST	162	24	432	6	2.5" Repave	86	\$37,002
454	SEWARD ST	MARINE ST	BARRACKS ST	54	24	144	6	2.5" Repave	86	\$12,334
143	SHELIKOF WAY	END	HALIBUT POINT RD	673	24	1794	6	2.5" Repave	86	\$153,688
307	SPRUCE ST	NEW ARCHANGEL ST	HEMLOCK ST	150	30	500	6	2.5" Repave	86	\$42,827
402	TLINGIT WAY	MARINE ST	END	392	18	784	6	2.5" Repave	86	\$67,152
24	VALHALA WAY	END	VIKING WAY	319	12	426	6	2.5" Repave	86	\$36,451
26	VALHALA WAY	VIKING WAY	END	328	12	437	6	2.5" Repave	86	\$37,443
519	WOLFF DR	END	END	166	18	332	6	2.5" Repave	86	\$28,437
518	WOLFF DR	END	END	1078	18	2156	6	2.5" Repave	86	\$184,669
529	WOLFF DR	SAWMILL CREEK RD	END	349	24	931	6	2.5" Repave	86	\$79,715
217	BRADY ST	HALIBUT POINT RD	GAVAN ST	303	36	1213	6	Full Reconstruct	334	\$405,777
131	CASCADE CREEK RD	HALIBUT POINT RD	DONNA DR	299	18	599	6	Full Reconstruct	334	\$200,217
463	CATHEDRAL WAY	SEWARD ST	LINCOLN ST	223	18	446	6	Full Reconstruct	334	\$149,143
349	LAKE ST	DEGROFF ST	SAWMILL CREEK RD	706	24	1883	6	Full Reconstruct	334	\$629,566
233	LAKE ST	FIRST ST	VERSTOVA ST	1573	24	4196	6	Full Reconstruct	334	\$1,403,115
282	LAKE ST	HIRST ST	KINKEAD ST	400	32	1421	6	Full Reconstruct	334	\$475,034
432	LINCOLN ST	BARANOF ST	FINN Alley	657	24	1752	6	Full Reconstruct	334	\$585,870
445	LINCOLN ST	BARLOW ST	JEFF DAVIS ST	236	24	629	6	Full Reconstruct	334	\$210,450
318	ANDREWS ST	OSPREY ST	NEW ARCHANGEL ST	235	18	470	8	2.5" Repave	90	\$42,460
561	ANNA CR	ANNA DR	END	440	18	880	8	2.5" Repave	90	\$79,500
182	BAHRT CR	CHARLES ST	END	289	18	578	8	2.5" Repave	90	\$52,217
288	BARANOF ST	ALPINE ST	MERRILL ST	203	12	271	8	2.5" Repave	90	\$24,452
64	BARKER ST	END	ROSS STREET	395	12	526	8	2.5" Repave	90	\$47,549
120	CASCADE CREEK RD	CEDAR HEIGHTS RD	END	834	16	1483	8	2.5" Repave	90	\$134,021
137	CHARTERIS ST	GEORGESON LP	GEORGESON LP	616	24	1641	8	2.5" Repave	90	\$148,281
138	CHARTERIS ST	GEORGESON LP	WORTMAN LP	102	24	271	8	2.5" Repave	90	\$24,458
161	DAVIDOFF ST	NEVA ST	CHARTERIS ST	581	18	1163	8	2.5" Repave	90	\$105,022
357	DEARMOND ST	NEW ARCHANGEL ST	ERLER ST	590	18	1180	8	2.5" Repave	90	\$106,603

TOTAL ROAD INVENTORY SORTED BY REMAINING SERVICE LIFE

Location ID	Road Name	From	To	Length (ft)	Width (ft)	Area (yd^2)	RSL	Recommended Treatment	Treatment Costs/YD^2	Estimated Cost
374	ERLER ST	END	ANDREWS ST	121	16	215	8	2.5" Repave	90	\$19,433
177	FURUHELM ST	KIMSHAM ST	KASHEVAROFF ST	624	18	1248	8	2.5" Repave	90	\$112,702
222	GAVAN ST	CASCADE ST	MOLLER AVE	428	18	855	8	2.5" Repave	90	\$77,269
493	HARVEST ST	PRICE ST	END	345	18	690	8	2.5" Repave	90	\$62,336
597	JARVIS	JARVIS	BEARDSLEE	800	24	2133	8	2.5" Repave	90	\$192,673
458	KAAGWAANTAAN ST	UNKNOWN UNK	END	104	24	277	8	2.5" Repave	90	\$25,055
172	KASHEVAROFF ST	EDGECOME DR	FURUHELM ST	371	24	988	8	2.5" Repave	90	\$89,282
168	KASHEVAROFF ST	FURUHELM ST	KIMSHAM ST	507	24	1352	8	2.5" Repave	90	\$122,177
508	KELLY ST	LINCOLN ST	KAAGWAANTAAN ST	1017	18	2034	8	2.5" Repave	90	\$183,754
207	KIMSHAM ST	PETERSON ST	EDGECOMBE DR	532	36	2128	8	2.5" Repave	90	\$192,236
251	KINKEAD ST	MONASTERY ST	END	127	14	198	8	2.5" Repave	90	\$17,847
162	MILLS ST	EDGECOMBE DR	JOHNSON ST	371	24	988	8	2.5" Repave	90	\$89,292
221	MOLLER AVE	HALIBUT POINT RD	END	428	14	666	8	2.5" Repave	90	\$60,148
210	MONASTERY ST	VERSTOVA ST	A ST	271	18	542	8	2.5" Repave	90	\$48,939
55	NICOLE DR	PATTERSON WAY	END	128	18	256	8	2.5" Repave	90	\$23,089
57	NICOLE DR	SOMER DR	PATTERSON WAY	178	18	356	8	2.5" Repave	90	\$32,123
325	OCAIN ST	OSPREY ST	END	215	12	287	8	2.5" Repave	90	\$25,898
310	OSPREY ST	OCAIN ST	OCAIN ST	112	18	224	8	2.5" Repave	90	\$20,236
56	PATTERSON WAY	NICOLE DR	SOMER DR	341	18	682	8	2.5" Repave	90	\$61,577
581	RANDS DR	WINCHESTER WAY	SHOTGUN Alley	342	18	684	8	2.5" Repave	90	\$61,793
63	ROSS STREET	MIKELE ST	BARKER ST	201	12	268	8	2.5" Repave	90	\$24,197
440	SEWARD ST	CATHEDRAL WAY	OBSERVATORY ST	241	24	643	8	2.5" Repave	90	\$58,059
450	SEWARD ST	PRINCESS WAY	AMERICAN ST	103	24	275	8	2.5" Repave	90	\$24,814
587	SHOTGUN ALLEY	RANDS DR	UNKNOWN UNK	769	18	1538	8	2.5" Repave	90	\$138,945
40	SHULER DR	HALIBUT POINT RD	UNKNOWN	438	18	876	8	2.5" Repave	90	\$79,126
58	SOMER DR	NICOLE DR	PATTERSON WAY	483	18	967	8	2.5" Repave	90	\$87,344
174	TILSON ST	KIMSHAM ST	END	480	18	961	8	2.5" Repave	90	\$86,814
183	WACHUSETTS ST	KIMSHAM ST	END	850	18	1699	8	2.5" Repave	90	\$153,521
129	CASCADE CREEK RD	DONNA DR	DODGE CR	585	18	1169	8	Full Reconstruct	353	\$412,406
478	AMERICAN ST	RACE ST	LINCOLN ST	142	18	284	8	Full Reconstruct	353	\$100,167
464	AMERICAN ST	SEWARD ST	RACE ST	202	18	404	8	Full Reconstruct	353	\$142,492
366	ANDREWS ST	NEW ARCHANGEL ST	ERLER ST	632	18	1264	8	Full Reconstruct	353	\$445,816
472	BARRACKS ST	SEWARD ST	RACE ST	200	18	400	8	Full Reconstruct	353	\$141,081
322	DEGROFF ST	BARANOF ST	PARK ST	824	36	3296	8	Full Reconstruct	353	\$1,162,507
309	DEGROFF ST	HIGHLAND ST	BARANOF ST	179	32	636	8	Full Reconstruct	353	\$224,475

TOTAL ROAD INVENTORY SORTED BY REMAINING SERVICE LIFE

Location ID	Road Name	From	To	Length (ft)	Width (ft)	Area (yd^2)	RSL	Recommended Treatment	Treatment Costs/YD^2	Estimated Cost
501	HARBOR WAY	UNKNOWN UNK	Airport Rd	95	24	253	8	Full Reconstruct	353	\$89,351
292	LAKE ST	DEGROFF ST	HIRST ST	178	32	632	8	Full Reconstruct	353	\$222,908
198	LAKE ST	VERSTOVA ST	PETERSON ST	260	24	693	8	Full Reconstruct	353	\$244,254
427	LINCOLN ST	MONASTERY ST	HARBOR DR	279	28	868	8	Full Reconstruct	353	\$306,146
195	PETERSON ST	CASCADE ST	EDGECOMBE DR	703	36	2814	8	Full Reconstruct	353	\$992,482
211	A ST	MONASTERY ST	VERSTOVA ST	434	18	869	10	2.5" Repave	95	\$82,781
526	ALICE LP	Airport Rd	END	1330	24	3547	10	2.5" Repave	95	\$337,946
125	CASCADE CREEK RD	EDGECOMBE DR	DODGE CR	827	16	1470	10	2.5" Repave	95	\$140,076
202	CHARLES ST	AUSTIN ST	VERSTOVA ST	321	18	642	10	2.5" Repave	95	\$61,173
187	CHARLES ST	BAHRT CR	AUSTIN ST	249	18	498	10	2.5" Repave	95	\$47,452
181	CHARLES ST	END	BAHRT CR	180	18	360	10	2.5" Repave	95	\$34,303
141	CHARTERIS ST	WORTMAN LP	JOHNSON ST	340	18	680	10	2.5" Repave	95	\$64,818
151	DAVIDOFF ST	GIBSON PL	CHARTERIS ST	223	18	447	10	2.5" Repave	95	\$42,592
126	DODGE CR	CASCADE CREEK RD	UNKNOWN UNK	261	18	521	10	2.5" Repave	95	\$49,653
142	EBERHARDT DR	EDGECOMBE DR	END	360	12	480	10	2.5" Repave	95	\$45,713
274	HIRST ST	MONASTERY ST	KINKEAD ST	126	14	196	10	2.5" Repave	95	\$18,676
370	KAAGWAANTAAN	KIRKMAN WAY	KATLIAN AVE	78	24	208	10	2.5" Repave	95	\$19,819
449	KAAGWAANTAAN	UNKNOWN UNK	UNKNOWN UNK	1211	24	3229	10	2.5" Repave	95	\$307,709
166	KOSTROMETINOFF	EDGECOMBE DR	END	181	18	362	10	2.5" Repave	95	\$34,485
69	KRAMER AVE	HALIBUT POINT RD	RBOR MOUNTAIN BYPA	1454	24	3878	10	2.5" Repave	95	\$369,534
537	LILLIAN DR	PRICE ST	PRICE ST	1105	18	2210	10	2.5" Repave	95	\$210,581
510	METLAKATLA ST	LINCOLN ST	KELLY ST	906	24	2416	10	2.5" Repave	95	\$230,210
321	NEW ARCHANGEL	ANDREWS ST	END	113	18	226	10	2.5" Repave	95	\$21,535
391	PARK ST	OJA ST	ETOLIN ST	199	18	398	10	2.5" Repave	95	\$37,924
539	PRICE ST	LILLIAN DR	SAWMILL CREEK RD	116	24	309	10	2.5" Repave	95	\$29,475
65	ROSS STREET	BARKER ST	HALIBUT POINT RD	145	12	193	10	2.5" Repave	95	\$18,360
462	SEWARD ST	END	MARINE ST	198	24	528	10	2.5" Repave	95	\$50,311
567	SHOTGUN Alley	SAWMILL CREEK RD	REMINGTON DR	82	18	164	10	2.5" Repave	95	\$15,627
257	SIGINAKA WAY	KATLIAN AVE	END	274	18	547	10	2.5" Repave	95	\$52,146
548	JAMESTOWN DR	SAWMILL CREEK RD	JAMESTOWN	875	16	1556	10	Full Reconstruct	372	\$579,004
256	KATLIAN AVE	HALIBUT POINT RD	SIGINAKA WAY	634	36	2537	10	Full Reconstruct	372	\$943,872
495	KATLIAN AVE	LINCOLN	BARANOF ST	434	36	1738	10	Full Reconstruct	372	\$646,419
371	KATLIAN AVE	LITTLEFIELD	KAAGWAANTAAN ST	153	24	408	10	Full Reconstruct	372	\$151,943
355	KATLIAN AVE	OLGA ST	LITTLEFIELD	209	24	557	10	Full Reconstruct	372	\$207,023
465	LINCOLN ST	END	HARBOR DR	521	36	2084	10	Full Reconstruct	372	\$775,259

TOTAL ROAD INVENTORY SORTED BY REMAINING SERVICE LIFE

Location ID	Road Name	From	To	Length (ft)	Width (ft)	Area (yd^2)	RSL	Recommended Treatment	Treatment Costs/YD^2	Estimated Cost
505	LINCOLN ST	END	HARBOR WAY	155	40	689	10	Full Reconstruct	372	\$256,270
494	LINCOLN ST	KATLIAN AVE	BARRACKS ST	349	36	1396	10	Full Reconstruct	372	\$519,320
392	MARINE ST	ERLER ST	TLINGIT WAY	367	32	1305	10	Full Reconstruct	372	\$485,426
352	MARINE ST	NEW ARCHANGEL ST	ERLER ST	634	32	2254	10	Full Reconstruct	372	\$838,583
455	MARINE ST	TLINGIT WAY	SEWARD ST	709	20	1576	10	Full Reconstruct	372	\$586,115
189	PETERSON ST	LAKE ST	CASCADE ST	171	36	685	10	Full Reconstruct	372	\$254,892
264	OLGA ST	KATLIAN AVE	OTTER	390	18	780	12	2.5" Repave	101	\$78,392
199	VERSTOVA ST	SIRSTAD ST	LAKE ST	329	20	731	12	2.5" Repave	101	\$73,420
482	LINCOLN ST	AMERICAN ST	BARRACKS ST	175	36	700	12	Full Reconstruct	392	\$274,655
477	LINCOLN ST	END	AMERICAN ST	67	18	134	12	Full Reconstruct	392	\$52,577
504	LINCOLN ST	KATLIAN AVE	HARBOR WAY	209	40	929	12	Full Reconstruct	392	\$364,463
208	PETERSON ST	HALIBUT POINT RD	KIMSHAM ST	177	36	710	12	Full Reconstruct	392	\$278,541
139	WORTMAN LP	CHARTERIS ST	EDGECOMBE DR	1553	18	3105	13	2.5" Repave	103	\$320,525
259	LAKE ST	ARROWHEAD ST	KINKEAD ST	442	32	1570	13	Full Reconstruct	403	\$632,627
224	MONASTERY ST	PERSON ST	SIRSTAD ST	184	18	367	14	2.5" Repave	106	\$38,933
359	BIORKA ST	BARANOF ST	PARK ST	646	18	1292	14	Full Reconstruct	414	\$534,680
206	PETERSON ST	KIMSHAM ST	EDGECOMBE DR	530	36	2121	14	Full Reconstruct	414	\$877,555
227	MONASTERY ST	FIRST ST	SIRSTAD ST	64	18	128	18	2.5" Repave	118	\$15,088
179	KASHEVAROFF ST	HALIBUT POINT RD	EDGECOMBE DR	389	24	1036	18	Full Reconstruct	460	\$476,987
525	ALICE LP	ALICE LP	UNKNOWN	639	24	1703	20	2.5" Repave	124	\$211,828
532	ALICE LP	UNKNOWN UNK	END	239	36	956	20	2.5" Repave	124	\$118,902
547	ALICE LP	UNKNOWN UNK	UNKNOWN UNK	1039	24	2771	20	2.5" Repave	124	\$344,601
483	BARRACKS ST	RACE ST	LINCOLN ST	149	18	298	20	2.5" Repave	124	\$37,064
514	BURKHART ST	PRICE ST	VITSKARI ST	647	18	1294	20	2.5" Repave	124	\$160,941
145	CHARTERIS ST	JOHNSON ST	EDGECOMBE DR	418	18	836	20	2.5" Repave	124	\$104,007
156	DAVIDOFF ST	HALIBUT POINT RD	GIBSON PL	281	24	750	20	2.5" Repave	124	\$93,235
35	GRANITE CREEK RD	END	HALIBUT POINT RD	1100	24	2933	20	2.5" Repave	124	\$364,832
497	JARVIS ST	JARVIS	SAWMILL CREEK RD	545	24	1454	20	2.5" Repave	124	\$180,802
184	KIMSHAM ST	WACHUSETTS ST	FURUHELM ST	390	22	953	20	2.5" Repave	124	\$118,584
339	LAKE ST	K	HALIBUT POINT RD	47	32	166	20	2.5" Repave	124	\$20,591
188	LAKE ST	PETERSON ST	END	438	24	1168	20	2.5" Repave	124	\$145,324
59	NICOLE DR	HALIBUT POINT RD	SOMER DR	254	12	339	20	2.5" Repave	124	\$42,148
373	PARK ST	BIORKA ST	OJA ST	208	24	555	20	2.5" Repave	124	\$68,986
524	PRICE ST	BURKHART ST	LILLIAN DR	337	24	899	20	2.5" Repave	124	\$111,771
527	PRICE ST	LILLIAN DR	LILLIAN DR	127	24	339	20	2.5" Repave	124	\$42,122

TOTAL ROAD INVENTORY SORTED BY REMAINING SERVICE LIFE										
Location ID	Road Name	From	To	Length (ft)	Width (ft)	Area (yd^2)	RSL	Recommended Treatment	Treatment Costs/YD^2	Estimated Cost
314	SEWARD AVE	Airport Rd	UNKNOWN UNK	424	36	1696	20	2.5" Repave	124	\$210,939
287	SEWARD AVE	END	UNKNOWN UNK	212	36	848	20	2.5" Repave	124	\$105,470
361	SEWARD AVE	TONGASS DR	END	361	24	963	20	2.5" Repave	124	\$119,731
350	SEWARD AVE	Tongass Dr	UNKNOWN UNK	494	10	549	20	2.5" Repave	124	\$68,268
404	SEWARD AVE	UNKNOWN UNK	END	631	10	701	20	2.5" Repave	124	\$87,200
324	SEWARD AVE	UNKNOWN UNK	UNKNOWN UNK	378	24	1008	20	2.5" Repave	124	\$125,370
290	SEWARD AVE	UNKNOWN UNK	UNKNOWN UNK	89	36	356	20	2.5" Repave	124	\$44,277
517	HARBOR WAY	LINCOLN ST	UNKNOWN UNK	982	24	2619	20	Full Reconstruct	486	\$1,271,551
485	MAKSOUTOFF ST	HARBOR DR	LINCOLN ST	176	24	469	20	Full Reconstruct	486	\$227,895
283	MARINE ST	HALIBUT POINT RD	OSPREY ST	65	20	144	20	Full Reconstruct	486	\$70,138
301	MARINE ST	OSPREY ST	NEW ARCHANGEL ST	240	20	533	20	Full Reconstruct	486	\$258,972
340	PARK ST	BIORKA ST	SAWMILL CREEK RD	277	18	554	20	Full Reconstruct	486	\$269,007
315	SEWARD AVE	UNKNOWN UNK	UNKNOWN UNK	509	24	1357	20	Full Reconstruct	486	\$659,083
439	SEWARD ST	CATHEDRAL WAY	LAKE ST	455	40	2022	20	Full Reconstruct	486	\$981,935
489	TONGASS DR	Airport Rd	Seward Ave	1736	24	4629	20	Full Reconstruct	486	\$2,247,875
556	ANNA DR	ANNA CR	MILLER DR	437	18	874	24	Grind/Overlay	57	\$49,696
558	ANNA DR	SAWMILL CREEK RD	ANNA CR	170	18	340	24	Grind/Overlay	57	\$19,333
246	ARROWHEAD ST	END	KINKEAD ST	175	12	233	24	Grind/Overlay	57	\$13,270
239	ARROWHEAD ST	KINKEAD ST	MONASTERY ST	178	12	238	24	Grind/Overlay	57	\$13,509
240	ARROWHEAD ST	LAKE ST	MONASTERY ST	258	12	344	24	Grind/Overlay	57	\$19,558
384	BARANOF ST	BIORKA ST	OJA ST	177	18	354	24	Grind/Overlay	57	\$20,129
331	BARANOF ST	DEGROFF ST	SAWMILL CREEK RD	377	18	754	24	Grind/Overlay	57	\$42,873
398	BARANOF ST	OJA ST	ETOLIN ST	187	18	374	24	Grind/Overlay	57	\$21,266
360	BARANOF ST	SAWMILL CREEK RD	BIORKA ST	234	18	468	24	Grind/Overlay	57	\$26,611
417	BARANOF ST	ETOLIN ST	LINCOLN ST	316	18	632	24	Grind/Overlay	57	\$35,936
130	EDGE CUMBE DR	WORTMAN LP	CASCADE CREEK RD	979	32	3480	24	Grind/Overlay	57	\$197,867
146	EDGE CUMBE DR	CHARTERIS ST	EBERHARDT DR	235	36	939	24	Grind/Overlay	57	\$53,378
153	EDGE CUMBE DR	CHARTERIS ST	NEVA ST	544	36	2176	24	Grind/Overlay	57	\$123,706
173	EDGE CUMBE DR	KASHEVAROFF ST	KOSTROMETINOFF ST	544	36	2176	24	Grind/Overlay	57	\$123,727
186	EDGE CUMBE DR	KIMSHAM ST	KRUZOF ST	243	40	1080	24	Grind/Overlay	57	\$61,437
167	EDGE CUMBE DR	KOSTROMETINOFF ST	MILLS ST	539	40	2396	24	Grind/Overlay	57	\$136,230
178	EDGE CUMBE DR	KRUZOF ST	KASHEVAROFF ST	541	40	2403	24	Grind/Overlay	57	\$136,634
163	EDGE CUMBE DR	MILLS ST	NEVA ST	541	36	2163	24	Grind/Overlay	57	\$122,981
196	EDGE CUMBE DR	PETERSON ST	KIMSHAM ST	482	36	1926	24	Grind/Overlay	57	\$109,528
140	EDGE CUMBE DR	EBERHARDT DR	WORTMAN LP	729	32	2592	24	Grind/Overlay	57	\$147,356

TOTAL ROAD INVENTORY SORTED BY REMAINING SERVICE LIFE

Location ID	Road Name	From	To	Length (ft)	Width (ft)	Area (yd^2)	RSL	Recommended Treatment	Treatment Costs/YD^2	Estimated Cost
346	ERLER ST	HEMLOCK ST	SPRUCE ST	252	30	840	24	Grind/Overlay	57	\$47,763
351	ERLER ST	SPRUCE ST	MARINE ST	253	18	506	24	Grind/Overlay	57	\$28,771
343	ERLER ST	HALIBUT POINT RD	HEMLOCK ST	439	16	780	24	Grind/Overlay	57	\$44,377
397	ETOLIN ST	BARANOF ST	PARK ST	479	14	745	24	Grind/Overlay	57	\$42,368
408	ETOLIN WAY	MONASTERY ST	LAKE ST	302	12	403	24	Grind/Overlay	57	\$22,896
214	GAVAN ST	BRADY ST	CASCADE ST	244	36	978	24	Grind/Overlay	57	\$55,588
342	HOLLYWOOD	SAWMILL	NICOLE DR	178	10	198	24	Grind/Overlay	57	\$11,232
403	MONASTERY ST	OJA WAY	ETOLIN WAY	228	12	304	24	Grind/Overlay	57	\$17,286
337	MONASTERY ST	SAWMILL CREEK RD	DEGROFF ST	519	14	807	24	Grind/Overlay	57	\$45,906
425	MONASTERY ST	LINCOLN ST	ETOLIN WAY	283	12	377	24	Grind/Overlay	57	\$21,455
387	MONASTERY ST	SAWMILL CREEK RD	OJA WAY	384	24	1024	24	Grind/Overlay	57	\$58,225
316	NEW ARCHANGEL	DEARMOND ST	ANDREWS ST	249	18	498	24	Grind/Overlay	57	\$28,317
312	NEW ARCHANGEL	MARINE ST	DEARMOND ST	224	18	448	24	Grind/Overlay	57	\$25,474
299	NEW ARCHANGEL	SPRUCE ST	MARINE ST	245	18	490	24	Grind/Overlay	57	\$27,862
383	OJA ST	PARK ST	BARANOF ST	561	14	873	24	Grind/Overlay	57	\$49,620
388	OJA WAY	LAKE ST	MONASTERY ST	485	24	1293	24	Grind/Overlay	57	\$73,540
379	POLICE STATION WAY	LAKE ST	END	256	10	284	24	Grind/Overlay	57	\$16,174
453	SEWARD ST	BARRACKS ST	PRINCESS WAY	46	24	123	24	Grind/Overlay	57	\$6,975
347	SPRUCE ST	HEMLOCK ST	ERLER ST	556	30	1853	24	Grind/Overlay	57	\$105,382
205	VERSTOVA ST	PERSON ST	CHARLES ST	168	18	336	24	Grind/Overlay	57	\$19,111
203	VERSTOVA ST	CHARLES ST	MONASTERY ST	265	18	530	24	Grind/Overlay	57	\$30,143
201	VERSTOVA ST	A ST	MONASTERY ST	273	18	546	24	Grind/Overlay	57	\$31,038
200	VERSTOVA ST	A ST	SIRSTAD ST	498	18	997	24	Grind/Overlay	57	\$56,677

			Grand Total	116850.8	5952	276872			Grand Total	\$45,089,307
			22.13 Centerline Miles							

<u>Road Repair Cost</u>	<u>Cost per SY</u>
Full Reconstruct	\$ 285.00
2.5" Repave	\$ 73.00
Grind/Overlay	\$ 30.00
CPI (avg. last 10-years)	2.7%

