

NOTE:
All lot corners marked with 5/8" rebar

Handwritten notes:
 Serial # 75-98
 Sitka
 Sub 4
 10-52-4
 City & Borough
 12-79

CERTIFICATE
 STATE OF ALASKA)
) s.s.
 First Judicial District)

I, the undersigned, being duly appointed and qualified, and an acting assessor for the City and Borough of Sitka, Alaska hereby certify that, according to the records in my possession, the following described property is carried on the tax records of the City and Borough of Sitka in the name of: **Arlene V. and Theodore Wolff**.

DESCRIPTION: All of U.S. Survey No. 2598 and lot 30, U.S. Survey No. 3718, near Sitka, Alaska.

and that, according to the records in my possession, all taxes assessed against said lands and in favor of the City and Borough of Sitka are paid in full; that current taxes for the year 1975 will be due on or before July 31, 1975.

DATED this 31st day of JANUARY 1975

Larry Stratton
 Assessor, City and Borough of Sitka

CERTIFICATION OF APPROVAL BY THE BOARD

I hereby certify that the Subdivision Plat shown hereon has been found to comply with the Subdivision Regulations of the City and Borough of Sitka Planning Board and that said Plat has been approved by the Board by Plat Resolution No. , dated 1975, and that the Plat shown hereon has been approved for recording in the office of the District Court, Ex-officio Recorder, Sitka, Alaska.

January 31, 1975 *Al Donaldson Jr.*
 Date Chairman, Planning Commission

ATTEST:

Lee Tew
 Secretary

CERTIFICATION OF APPROVAL BY THE ASSEMBLY

I hereby certify that the Subdivision Plat shown hereon has been found to comply with the Subdivision Regulations of the City and Borough of Sitka, and that said Plat has been approved by the Assembly as recorded in Minute Book page , dated 1975 and that the Plat shown hereon has been approved for recording in the office of the District Court, Ex-officio recorder, Sitka, Alaska.

1/30/75 *Joseph Depina*
 Date Mayor

ATTEST:

Maude V. Thom
 City and Borough Clerk

SURVEYOR'S CERTIFICATE

I hereby certify that I am registered to practice land surveying in Alaska and that this Plat represents the survey made by me or under my supervision, and that all the monuments shown thereon actually exist as located, and that all dimensions and other details are correct.

Jan. 31, 1975 *Larry Stratton*
 Date 3462-3

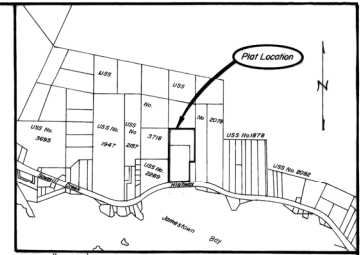

Vicinity Map

CERTIFICATE OF OWNERSHIP AND DEDICATION

We hereby certify that we are the owners of the property shown and described hereon and that we hereby assign this part of subdivision with our free consent, and dedicate all streets, alleys, walks, parks and other open spaces to public or private use as noted.

Jan. 20, 1975 *Theodore M. Wolff*
 Date Owner

Larry Stratton *Theodore M. Wolff*
 Witness Owner

NOTARY'S ACKNOWLEDGEMENT
 STATE OF ALASKA) s.s.
 First Judicial District)

This is to certify that on this 28th day of January, 1975, before me, the undersigned, a Notary Public in and for the State of Alaska, personally appeared **Arlene V. & Theodore Wolff**, et al., to me known and known to me to be the persons named in the foregoing Certificate of Ownership and Dedication and that they individually acknowledged to me that they executed the same freely and voluntarily for the uses and purposes therein mentioned.

WITNESS my hand and official seal the day and the year in this certificate named first above.

Henry P. Flynn
 Notary Public for Alaska

My commission expires *3-20-76*



PLAT TED WOLFF SUBDIVISION CITY & BOROUGH OF SITKA, ALASKA	
Dated: <i>January, 1975</i>	Scale: 1" = 50'
LARRY STRATTON - CIVIL ENGINEER	
Box 76 SITKA, ALASKA	
Drawn By: <i>L.C.S.</i>	Date: <i>Jan. 16, 1975</i>
Surveyed By: <i>L.C.S.</i>	Date: <i>Dec., 1974</i>

Handwritten: # 75-4