

1 2 3 4 5 6 7

F
E
D
C
B
A

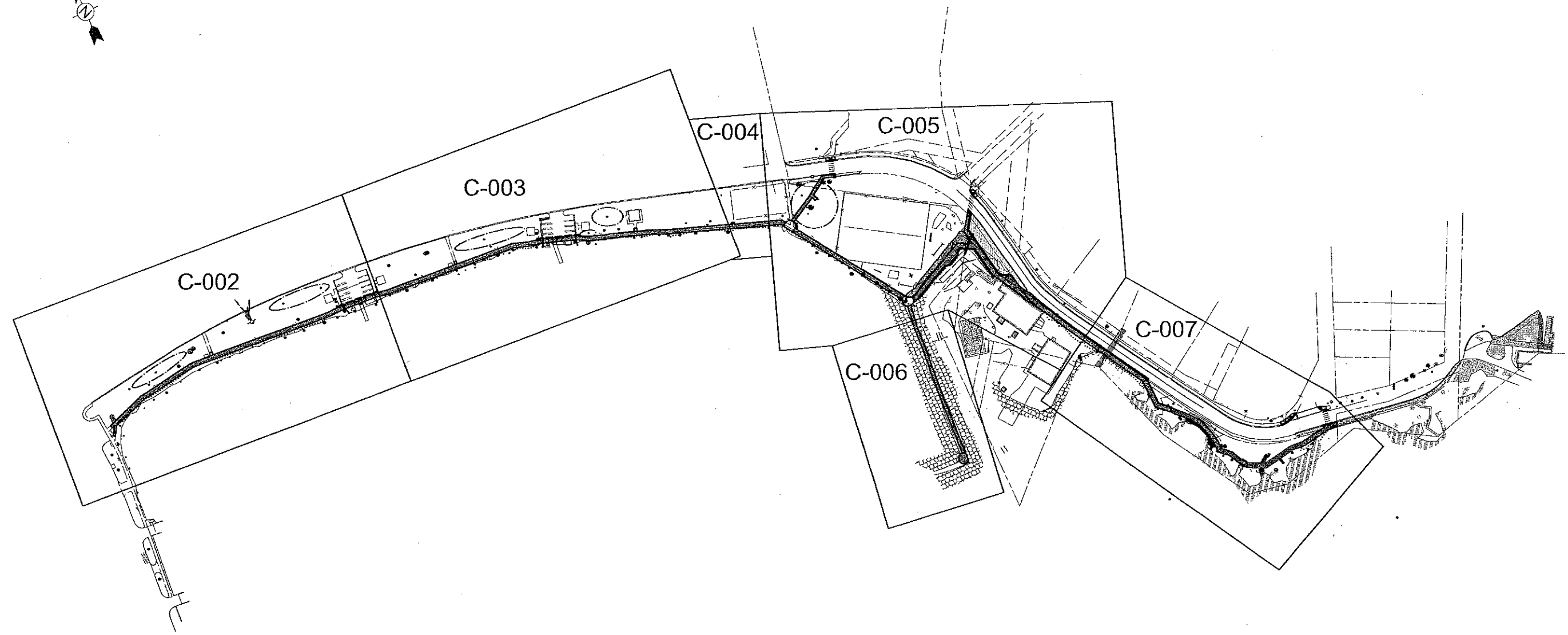

1/28/2013 4:05:42 PM - SALIBU70492 SITKA SEAWALK080 DESIGN DRAWINGS\CDDU70492 PLAN.DWG - KEMP, JENNIFER

DOWL HKM
5368 Commercial Boulevard
Juneau, AK 99801
(907) 780-3533
Fax (907) 780-3533

TETRA TECH
www.tetratech.com
230 South Franklin, Suite 212
Juneau, Alaska 99801
Phone: 907-588-6400 Fax: 907-436-3677



City and Borough of Sitka
DEPARTMENT OF
PUBLIC WORKS
100 LINCOLN STREET SITKA, ALASKA 99835
TEL (907) 747-1804 FAX (907) 747-3158

MARK	DATE	DESCRIPTION	BY

CITY AND BOROUGH OF SITKA ALASKA
SEA WALK - Crescent Harbor Park to National Historic Park
Project No's 90693, 90695
**PROPOSED ROUTE PLAN -
CIVIL KEY PLAN**

Project No.: 135-19635-12001
Designed By: NH
Drawn By: NH
Checked By: DB
C-001
Sheet X

Copyright: Tetra Tech

Bar Measures 1 inch

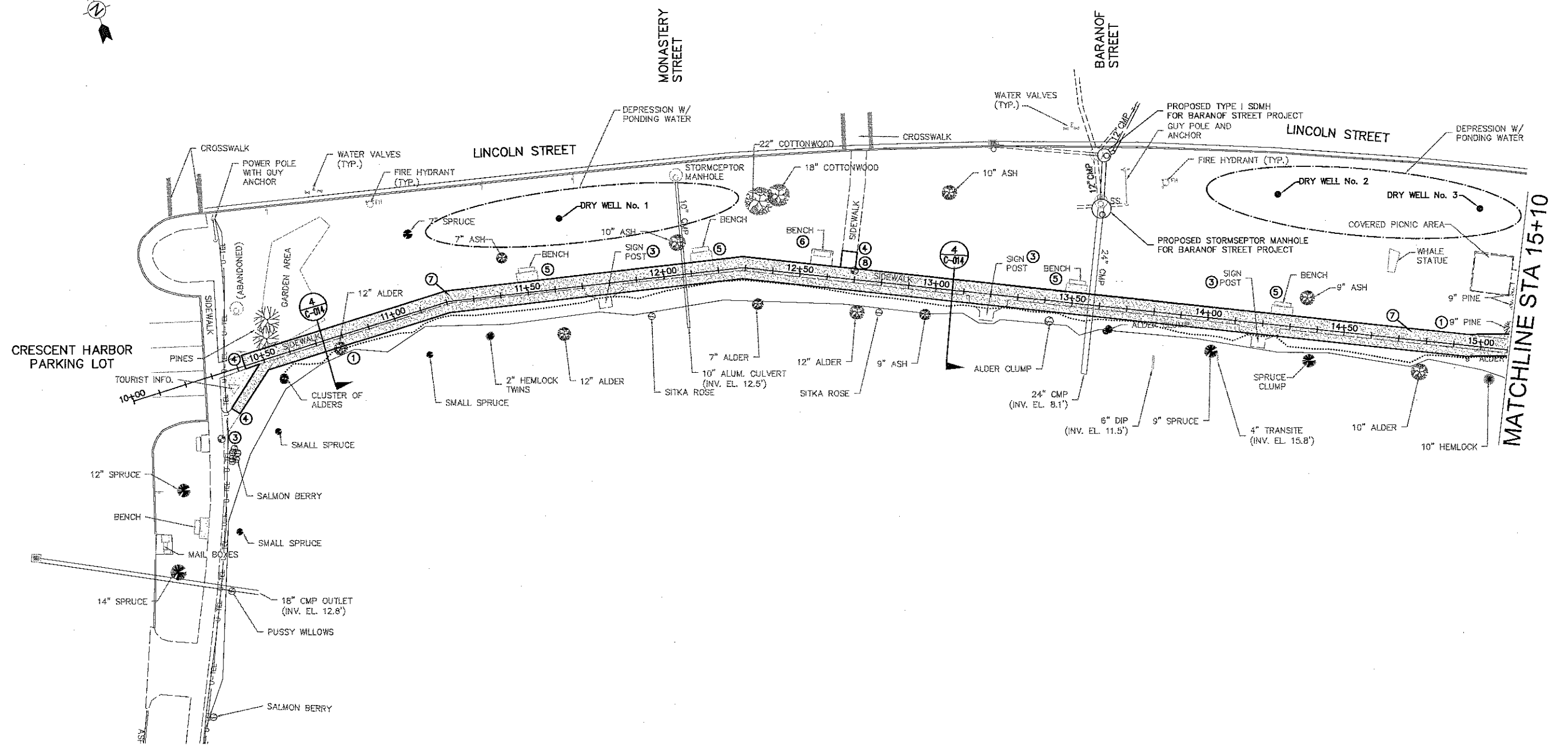

- NOTES:**
- ① REMOVE AND DISPOSE OF TREE AS REQUIRED FOR 8' PATH WIDTH. DO NOT REMOVE ANY TREE UNTIL APPROVED BY THE ENGINEER
 - ② REMOVE AND RELOCATE
 - ③ PROTECT AND MAINTAIN
 - ④ SAWCUT AND MATCH TO EXISTING
 - ⑤ REPLACE BACK AND SEAT OF BENCH
 - ⑥ SALVAGE BENCH AND DELIVER TO CBS PUBLIC WORKS STORAGE AREA
 - ⑦ REMOVE EXISTING CONCRETE SIDEWALK (TYP)
 - ⑧ REMOVE AND RESET BRASS CAP MONUMENT, CH-7

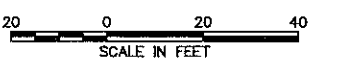

13/12013 2:28:20 PM - S:\LIB\70492 SITKA SEA WALK\K060 DESIGN DRAWINGS\C80\70492 PLAN.DWG - KEMP, JENNIFER

DOWL HKM
 5368 Commercial Boulevard
 Juneau, AK 99801
 (907) 780-3533
 Fax (907) 780-3533

TETRA TECH
 www.tetrattech.com
 230 South Franklin, Suite 212
 Juneau, Alaska 99801
 Phone: 907-586-6400 Fax: 907-436-3677

City and Borough of Sitka
 DEPARTMENT OF PUBLIC WORKS
 100 LINCOLN STREET SITKA, ALASKA 99835
 TEL (907) 747-1804 FAX (907) 747-3158

MARK	DATE	DESCRIPTION	BY

CITY AND BOROUGH OF SITKA ALASKA
 SEA WALK - Crescent Harbor Park to National Historic Park
 Project No's 90693, 90695
CIVIL PLAN -
CRESCENT PARK
 BOP TO STA 15+10

Project No.: 135-19835-12001
 Designed By: NH
 Drawn By: NH
 Checked By: DB
C-002
 Sheet X
 Bar Measures 1 inch

Copyright: Tetra Tech



NOTES:

- ① REMOVE AND DISPOSE OF TREE AS REQUIRED FOR 8' PATH WIDTH. DO NOT REMOVE ANY TREE UNTIL APPROVED BY THE ENGINEER
- ② REMOVE AND RELOCATE
- ③ PROTECT AND MAINTAIN
- ④ SAWCUT AND MATCH TO EXISTING
- ⑤ REPLACE BACK AND SEAT OF BENCH
- ⑥ SALVAGE BENCH AND DELIVER TO CBS PUBLIC WORKS STORAGE AREA
- ⑦ REMOVE EXISTING CONCRETE SIDEWALK (TYP)
- ⑧ THIS RAMP WILL BE 4" THICK CONCRETE AND WILL NOT BE MEASURED UNDER ITEM 30.07, P.C.C. CURB RAMP
- ⑨ REMOVE AND RESET BRASS CAP MONUMENT, CH-8

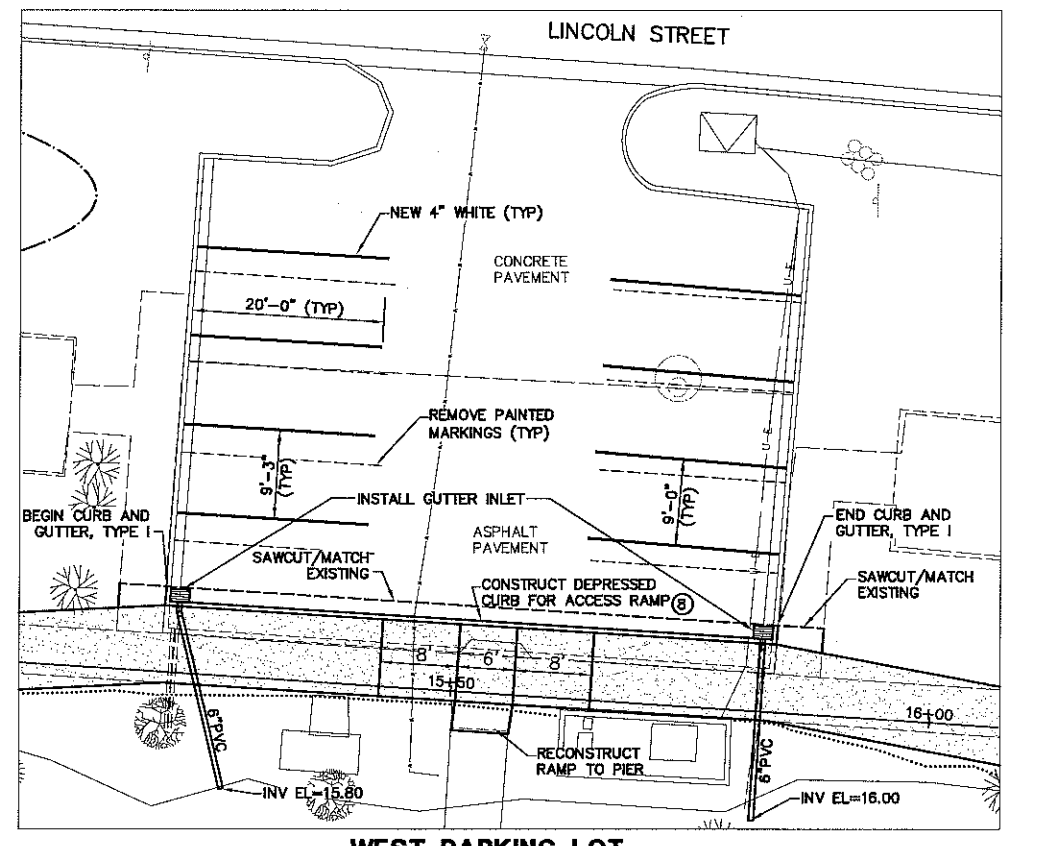
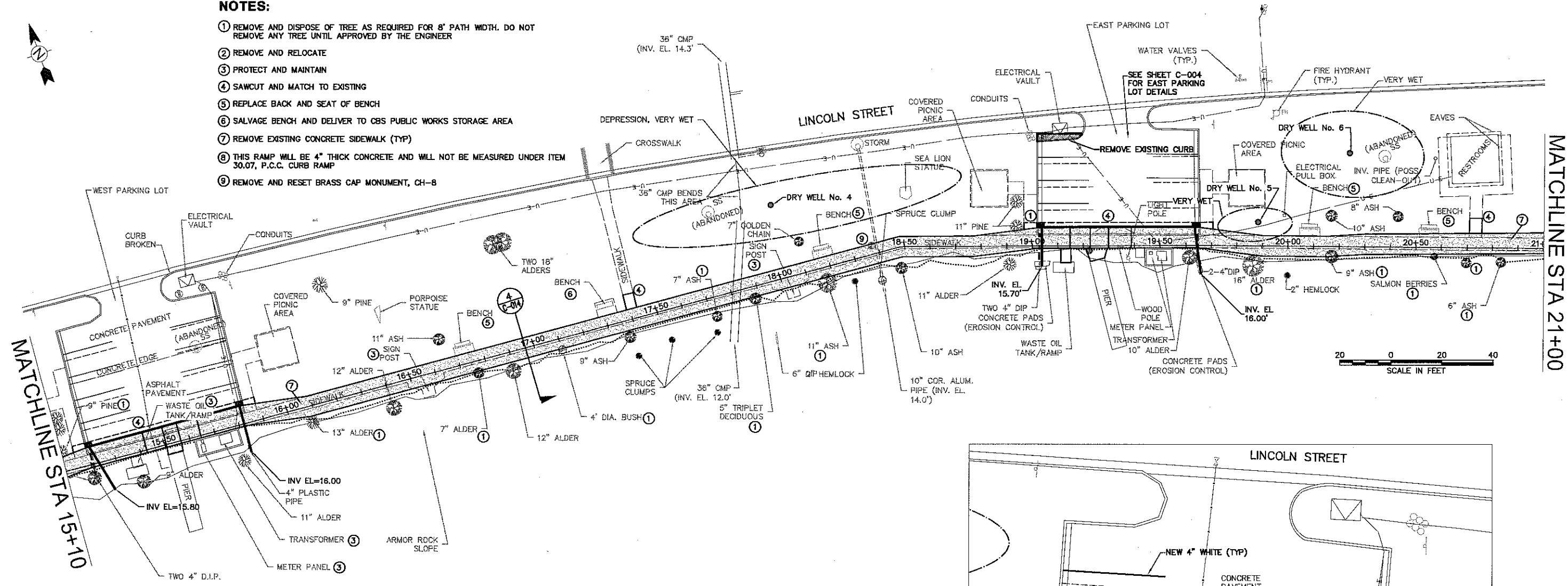

10/12/013 2:28:27 PM - S:\LIB\0492 SITKA SEAWALK\060 DESIGN\DRAWINGS\CADD\0492 PLAN.DWG - KEMP, JENNIFER

DOWL HKM
 5368 Commercial Boulevard
 Juneau, AK 99801
 (907) 780-3533
 Fax (907) 780-3533

TETRA TECH
 www.tetrattech.com
 230 South Franklin, Suite 212
 Juneau, Alaska 99801
 Phone: 907-596-9400 Fax: 907-436-3677

City and Borough of Sitka
 DEPARTMENT OF PUBLIC WORKS
 100 LINCOLN STREET SITKA, ALASKA 99835
 TEL (907) 747-1804 FAX (907) 747-3158

MARK	DATE	DESCRIPTION	BY

CITY AND BOROUGH OF SITKA ALASKA
 SEA WALK - Crescent Harbor Park to National Historic Park
 Project No's 90693, 90695
CIVIL PLAN - CRESCENT PARK
 STA 15+10 TO STA 21+00

Project No.: 135-19835-12001
 Designed By: NH
 Drawn By: NH
 Checked By: DB
C-003
 Sheet X
 Bar Measures 1 inch

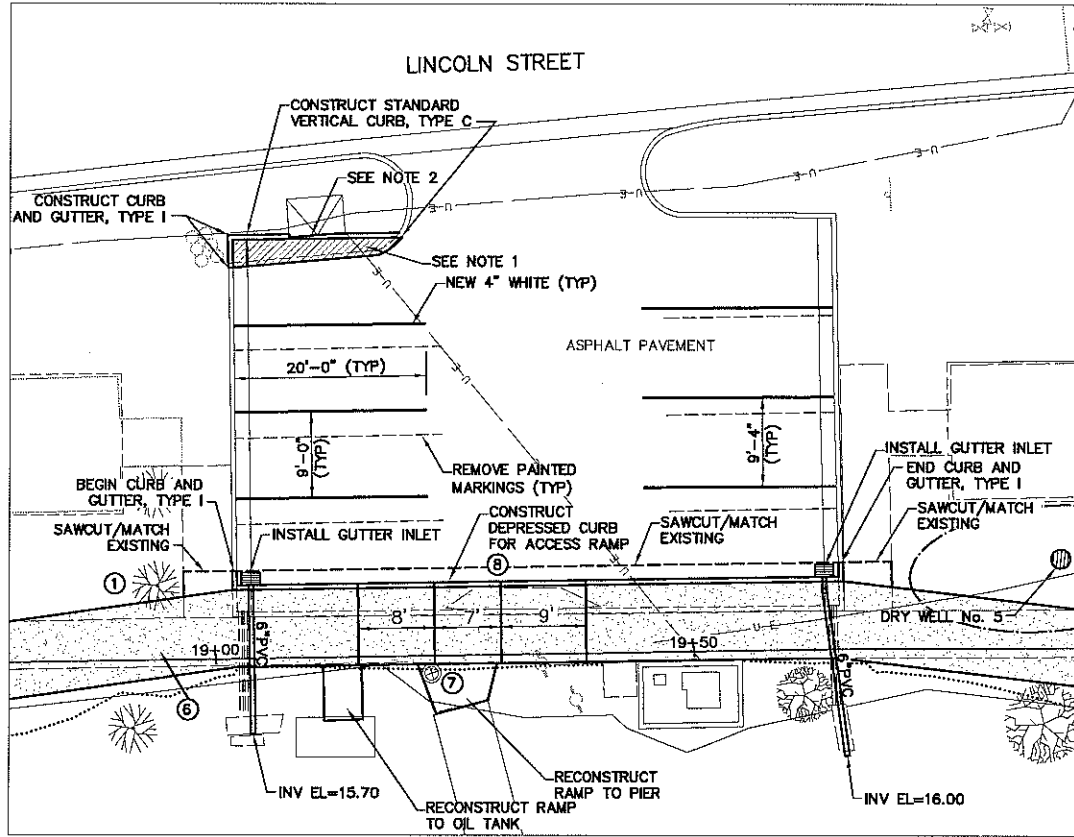

EAST PARKING LOT NOTES:

1. SUBCUT THIS AREA AND REPLACE WITH 15"-10" MINUS SHOT ROCK, 4" D-1 BASE COURSE AND 2" ASPHALT PAVEMENT.
2. CONSTRUCT CURB TO MATCH TO ELECTRICAL VAULT.

EAST PARKING LOT

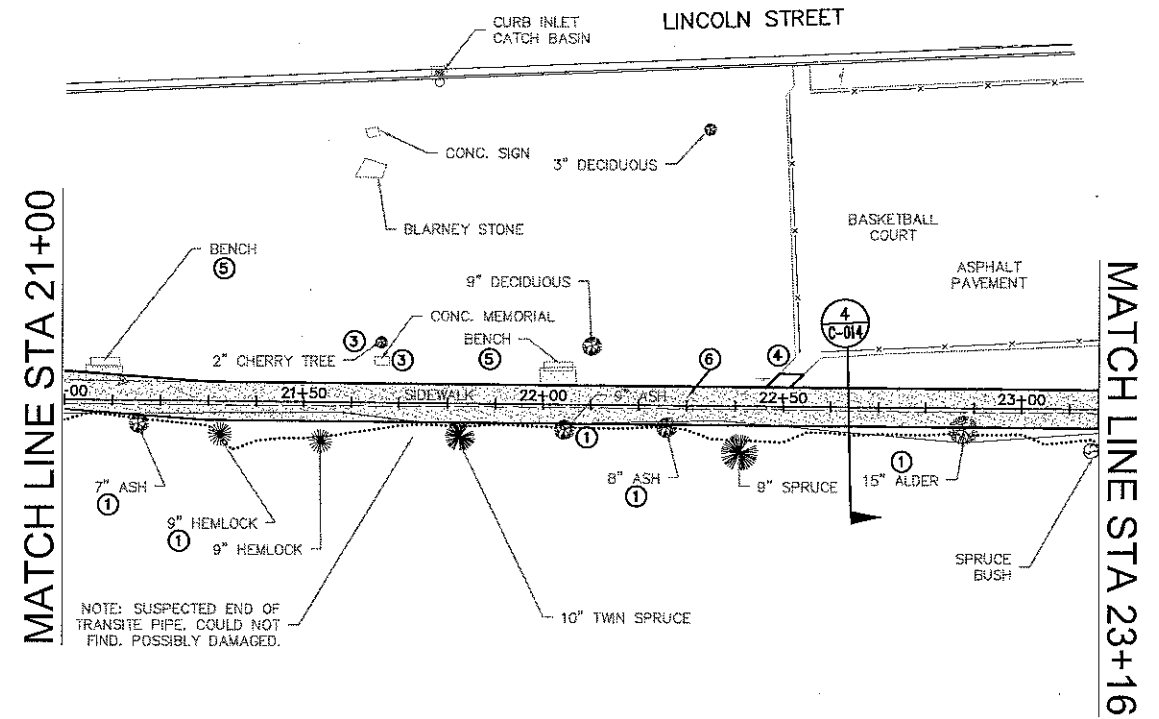

NOTE: SUSPECTED END OF TRANSITE PIPE, COULD NOT FIND. POSSIBLY DAMAGED.

NOTES:

- ① REMOVE AND DISPOSE OF TREE AS REQUIRED FOR 8' PATH WIDTH. DO NOT REMOVE ANY TREE UNTIL APPROVED BY THE ENGINEER
- ② REMOVE AND RELOCATE
- ③ PROTECT AND MAINTAIN
- ④ SAWCUT AND MATCH TO EXISTING
- ⑤ REPLACE BACK AND SEAT OF BENCH
- ⑥ REMOVE EXISTING CONCRETE SIDEWALK (TYP)
- ⑦ REMOVE AND RESET MONUMENT, CH-6
- ⑧ THIS RAMP WILL BE 4" THICK CONCRETE AND WILL NOT BE MEASURED UNDER ITEM 30.07, P.C.C. CURB RAMP



1/31/2013 2:29:30 PM - S:\11\B\70482 SITKA SEA WALK\050 DESIGN DRAWINGS\C3D\UT0482 PLAN.DWG - KEMP, JENNIFER

DOWL HKM
5368 Commercial Boulevard
Juneau, AK 99801
(907) 780-3533
Fax (907) 780-3533

TETRA TECH
www.tetratech.com
230 South Franklin, Suite 212
Juneau, Alaska 99801
Phone: 907-586-6400 Fax: 907-436-3677

City and Borough of Sitka
DEPARTMENT OF PUBLIC WORKS
100 LINCOLN STREET SITKA, ALASKA 99835
TEL (907) 747-1804 FAX (907) 747-3158

MARK	DATE	DESCRIPTION	BY

CITY AND BOROUGH OF SITKA ALASKA
SEA WALK - Crescent Harbor Park to National Historic Park
Project No's 90693, 90695
CIVIL PLAN - CRESCENT PARK
STA 21+00 TO STA 23+16

Project No: 135-19835-12001
Designed By: NH
Drawn By: NH
Checked By: DB
C-004
Sheet X
Bar Measures 1 inch

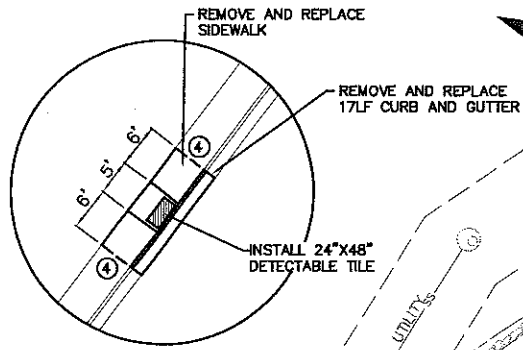
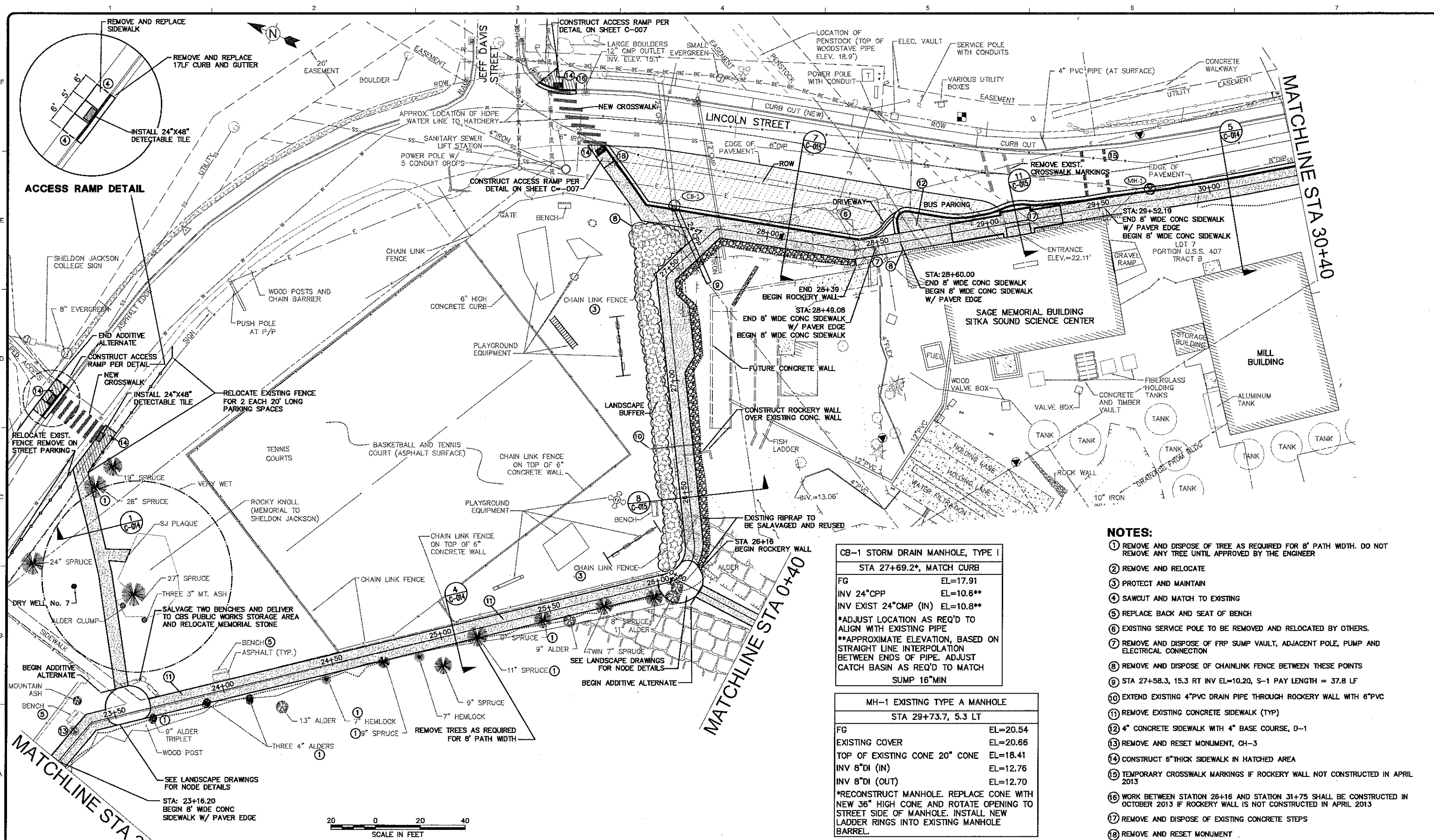

ACCESS RAMP DETAIL

CB-1 STORM DRAIN MANHOLE, TYPE I
STA 27+69.2*, MATCH CURB

FG	EL=17.91
INV 24"CPP	EL=10.6**
INV EXIST 24"CMP (IN)	EL=10.8**

*ADJUST LOCATION AS REQ'D TO ALIGN WITH EXISTING PIPE
**APPROXIMATE ELEVATION, BASED ON STRAIGHT LINE INTERPOLATION BETWEEN ENDS OF PIPE. ADJUST CATCH BASIN AS REQ'D TO MATCH SUMP 16"MIN

MH-1 EXISTING TYPE A MANHOLE
STA 29+73.7, 5.3 LT

FG	EL=20.54
EXISTING COVER	EL=20.66
TOP OF EXISTING CONE 20" CONE	EL=18.41
INV 8"DI (IN)	EL=12.76
INV 8"DI (OUT)	EL=12.70

*RECONSTRUCT MANHOLE. REPLACE CONE WITH NEW 36" HIGH CONE AND ROTATE OPENING TO STREET SIDE OF MANHOLE. INSTALL NEW LADDER RINGS INTO EXISTING MANHOLE BARREL.

- NOTES:**
- REMOVE AND DISPOSE OF TREE AS REQUIRED FOR 8' PATH WIDTH. DO NOT REMOVE ANY TREE UNTIL APPROVED BY THE ENGINEER
 - REMOVE AND RELOCATE
 - PROTECT AND MAINTAIN
 - SAWCUT AND MATCH TO EXISTING
 - REPLACE BACK AND SEAT OF BENCH
 - EXISTING SERVICE POLE TO BE REMOVED AND RELOCATED BY OTHERS.
 - REMOVE AND DISPOSE OF FRP SUMP VAULT, ADJACENT POLE, PUMP AND ELECTRICAL CONNECTION
 - REMOVE AND DISPOSE OF CHAINLINK FENCE BETWEEN THESE POINTS
 - STA 27+58.3, 15.3 RT INV EL=10.20, S-1 PAY LENGTH = 37.8 LF
 - EXTEND EXISTING 4"PVC DRAIN PIPE THROUGH ROCKERY WALL WITH 6"PVC
 - REMOVE EXISTING CONCRETE SIDEWALK (TYP)
 - 4" CONCRETE SIDEWALK WITH 4" BASE COURSE, D-1
 - REMOVE AND RESET MONUMENT, CH-3
 - CONSTRUCT 6"THICK SIDEWALK IN HATCHED AREA
 - TEMPORARY CROSSWALK MARKINGS IF ROCKERY WALL NOT CONSTRUCTED IN APRIL 2013
 - WORK BETWEEN STATION 26+16 AND STATION 31+75 SHALL BE CONSTRUCTED IN OCTOBER 2013 IF ROCKERY WALL IS NOT CONSTRUCTED IN APRIL 2013
 - REMOVE AND DISPOSE OF EXISTING CONCRETE STEPS
 - REMOVE AND RESET MONUMENT

2/12/2013 9:35:27 AM - S:\LIB\70492 SITKA SEAWALK\060 DESIGN DRAWINGS\CD\170492 PLAN.DWG - KEMP, JENNIFER

DOWL HKM
5368 Commercial Boulevard
Juneau, AK 99801
(907) 780-3533
Fax (907) 780-3533

TETRA TECH
www.tetrattech.com
230 South Franklin, Suite 212
Juneau, Alaska 99801
Phone: 907-586-6400 Fax: 907-436-3677

City and Borough of Sitka
DEPARTMENT OF PUBLIC WORKS
100 LINCOLN STREET SITKA, ALASKA 99835
TEL (907) 747-1604 FAX (907) 747-3158

MARK	DATE	DESCRIPTION	BY

CITY AND BOROUGH OF SITKA ALASKA
SEA WALK - Crescent Harbor Park to National Historic Park
Project No's 90693, 90895
CIVIL PLAN -
CRESCENT PARK AND SSSC
STA 23+16 TO STA 30+40

Project No.: 135-19835-12001
Designed By: NH
Drawn By: NH
Checked By: DB
C-005
Sheet X
Bar Measures 1 inch

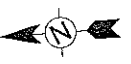

MATCHLINE STA 0+40

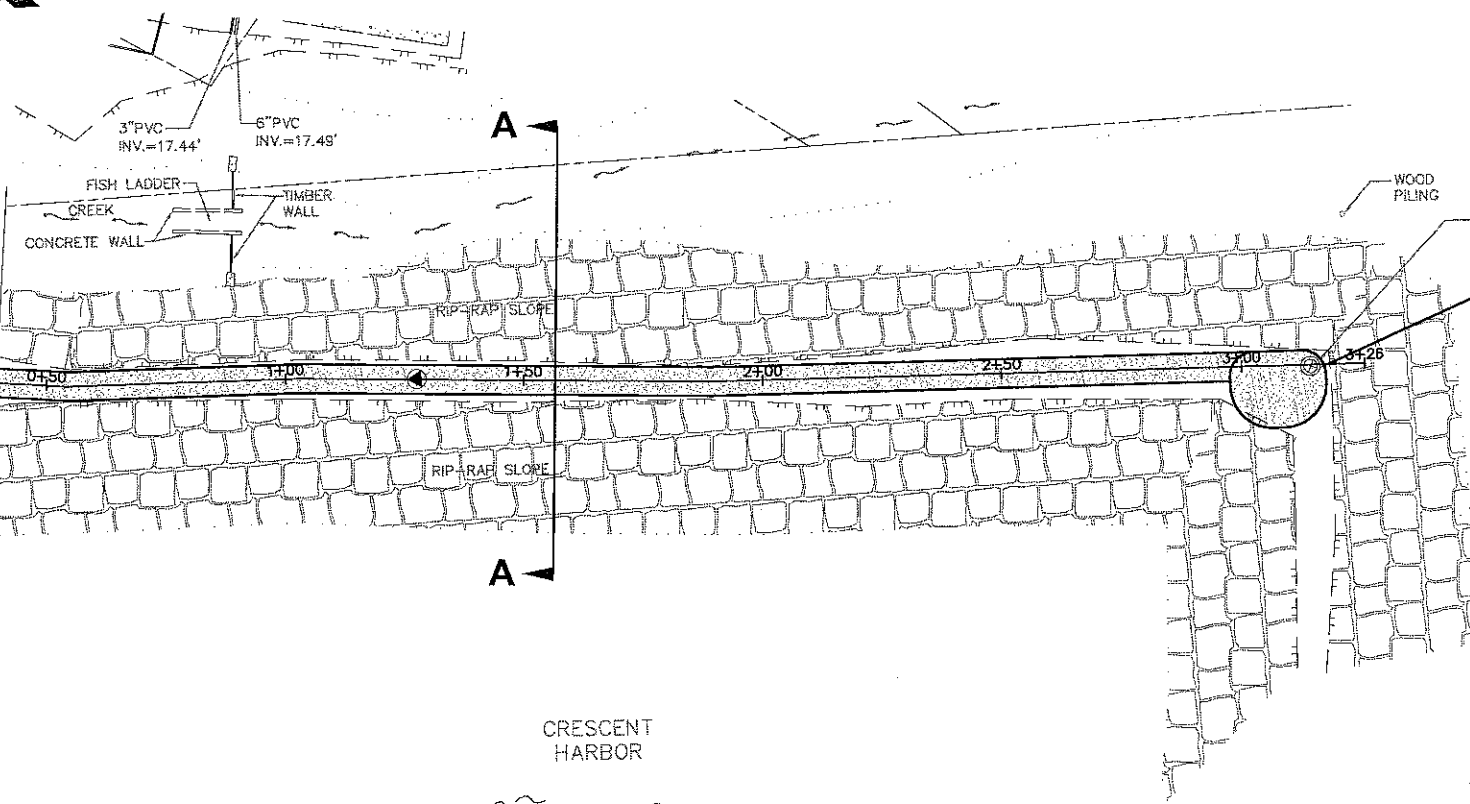

WOOD PILING
U.S. ARMY CORP OF ENGINEERS
3.5\"/>

CRESCENT HARBOR



NOTES:

1. EXISTING ROCKS ALONG THE TOP OF THE BREAKWATER SHALL BE MOVED WHERE POSSIBLE ALONG THE BREAKWATER TO FLATTEN THE SECTION FOR THE NEW PATHWAY AND TO FILL LARGE VOIDS.
2. ROCKS THAT ARE MOVED TO FLATTEN THE TOP OF THE BREAKWATER THAT ARE IN EXCESS OF WHAT IS REQUIRED TO FILL VOIDS AND TO BUILD A PAD OF SUFFICIENT WIDTH TO SUPPORT THE PATHWAY SECTION SHOWN MAY BE USED A SELECTED BORROW BEHIND THE ROCKERY WALL.
3. FILL REMAINING VOIDS IN EXISTING BREAKWATER ROCKS AFTER THE EXISTING ROCKS AT THE TOP OF THE BREAKWATER HAVE BEEN LEVELED AND THOROUGHLY COMPACTED, WITH 10\"/>
- 4. PLACE NON-WOVEN GEOTEXTILE OVER TOP OF LEVELED AND COMPACTED 10\"/>
- 5. FILL THE CELLULAR CONFINEMENT SYSTEM AS DESCRIBED IN THE SPECIAL PROVISIONS AND PLACE AND COMPACT A 1\"/>
- 6. THE TOP OF THE REGRADED PAD USING ROCKS FROM THE BREAKWATER ONLY, AND PRIOR TO PLACING 10\"/>
- 7. THE PAD ALONG THE TOP OF THE 10\"/>

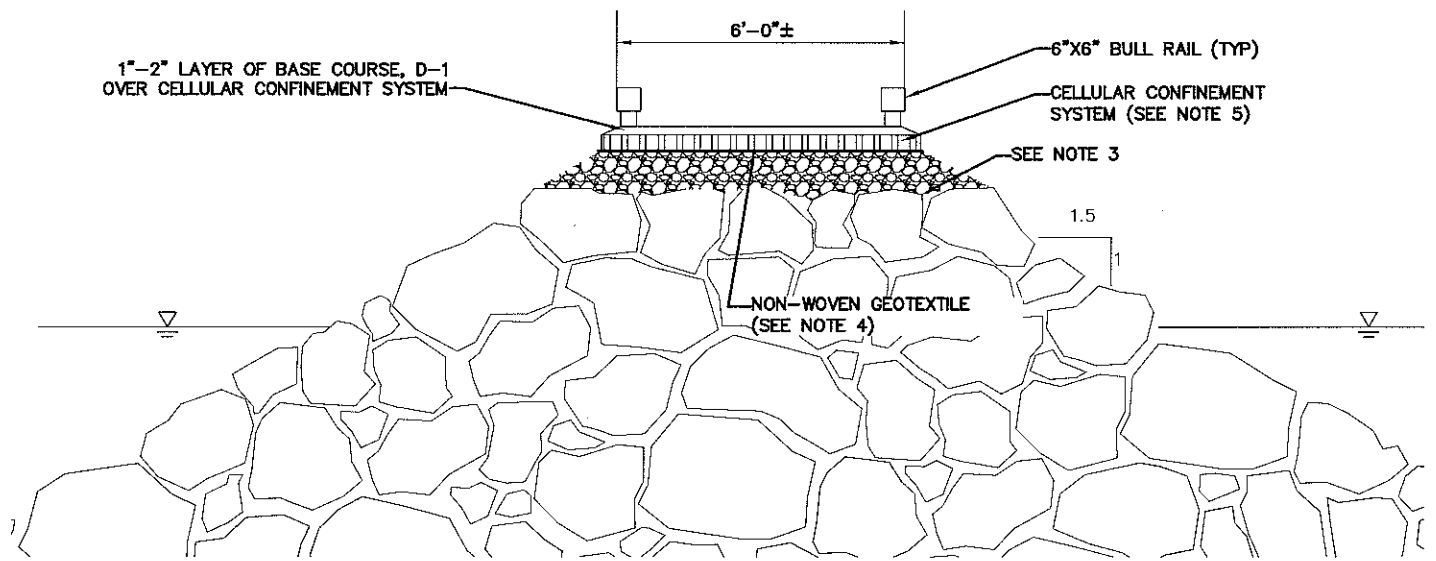

BREAKWATER TYPICAL SECTION A-A
NOT TO SCALE

1/31/2013 2:28:38 PM - S:\LIB\170482 SITKA SEAWALK\0650 DESIGN DRAWINGS\C3D\170482 PLAN.DWG - KEMP, JENNIFER

DOWL HKM
5368 Commercial Boulevard
Juneau, AK 99801
(907) 780-3533
Fax (907) 780-3533

TETRA TECH
www.tetratech.com
230 South Franklin, Suite 212
Juneau, Alaska 99801
Phone: 907-586-6400 Fax: 907-436-3677

City and Borough of Sitka
DEPARTMENT OF PUBLIC WORKS
100 LINCOLN STREET SITKA, ALASKA 99835
TEL (907) 747-1804 FAX (907) 747-3158

MARK	DATE	DESCRIPTION	BY

CITY AND BOROUGH OF SITKA ALASKA
SEA WALK - Crescent Harbor Park to National Historic Park
Project No's 90693, 90695
CIVIL PLAN - BREAKWATER

Project No.: 135-19835-12001
Designed By: NH
Drawn By: NH
Checked By: DB
C-006
Sheet X

Bar Measures 1 Inch

CB-2	TYPE III
STA 30+71.0, MATCH CURB	
FG	EL=19.92*
INV 8" PVC	EL=17.67
*APPROX. ONLY. ADJUST GRATE TO 1-5/8" BELOW EDGE OF PAVEMENT	

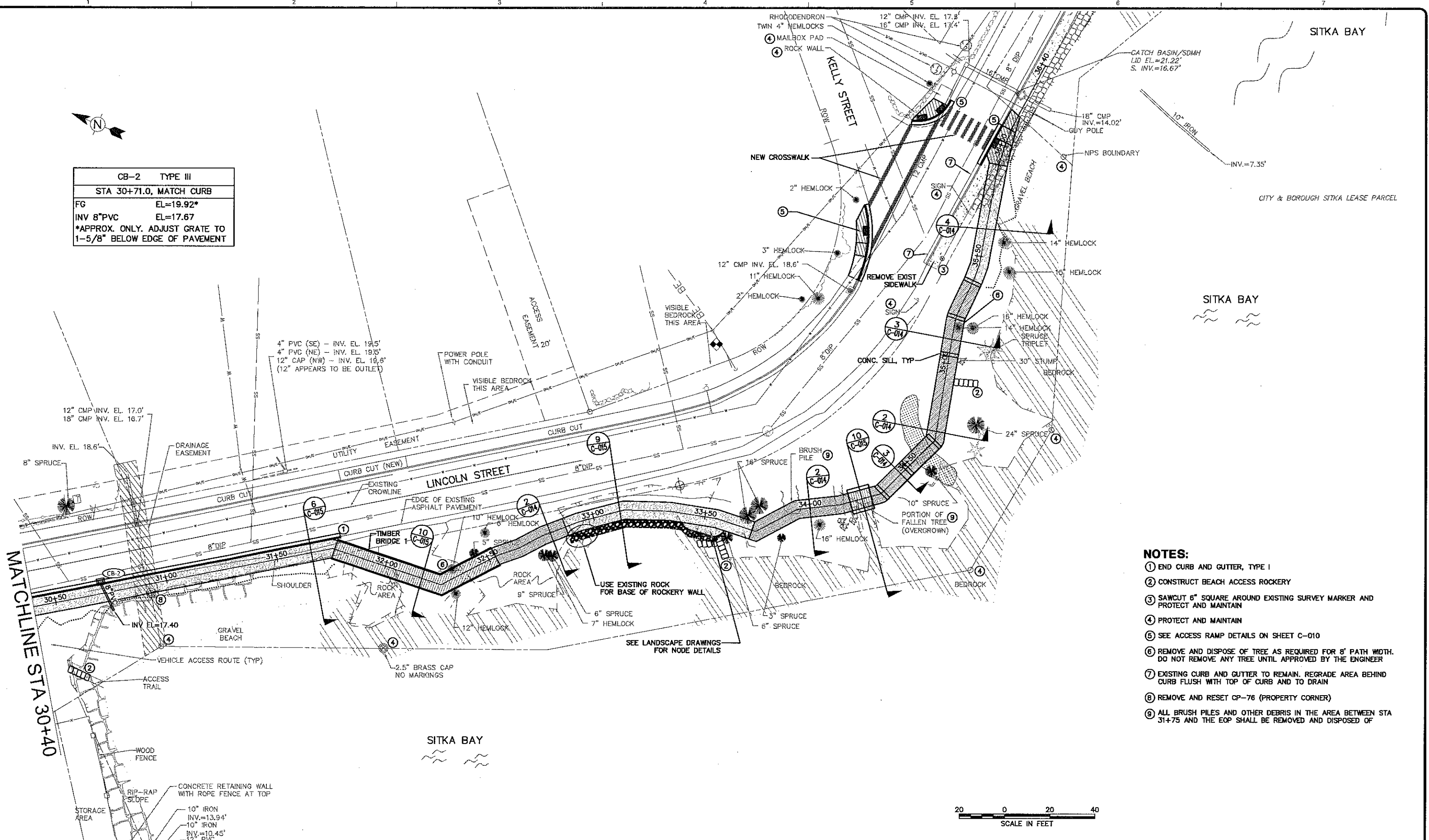

- NOTES:**
- 1 END CURB AND GUTTER, TYPE I
 - 2 CONSTRUCT BEACH ACCESS ROCKERY
 - 3 SAWCUT 6" SQUARE AROUND EXISTING SURVEY MARKER AND PROTECT AND MAINTAIN
 - 4 PROTECT AND MAINTAIN
 - 5 SEE ACCESS RAMP DETAILS ON SHEET C-010
 - 6 REMOVE AND DISPOSE OF TREE AS REQUIRED FOR 8' PATH WIDTH. DO NOT REMOVE ANY TREE UNTIL APPROVED BY THE ENGINEER
 - 7 EXISTING CURB AND GUTTER TO REMAIN. REGRADE AREA BEHIND CURB FLUSH WITH TOP OF CURB AND TO DRAIN
 - 8 REMOVE AND RESET CP-76 (PROPERTY CORNER)
 - 9 ALL BRUSH PILES AND OTHER DEBRIS IN THE AREA BETWEEN STA 31+75 AND THE EOP SHALL BE REMOVED AND DISPOSED OF



1/31/2013 2:28:41 PM - S:\LIBRARY\SITKA SEAWALK\DESIGN DRAWINGS\CADD\0402 PLAN.DWG - KEMP, JENNIFER

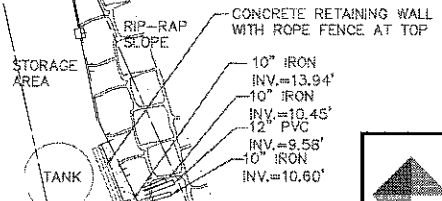

DOWL HKM
 5368 Commercial Boulevard
 Juneau, AK 99801
 (907) 780-3533
 Fax (907) 780-3533

TETRA TECH
 www.tetratech.com
 230 South Franklin, Suite 212
 Juneau, Alaska 99801
 Phone: 907-586-6400 Fax: 907-436-3677

City and Borough of Sitka
 DEPARTMENT OF PUBLIC WORKS
 100 LINCOLN STREET SITKA, ALASKA 99835
 TEL (907) 747-1804 FAX (907) 747-3158

MARK	DATE	DESCRIPTION	BY

CITY AND BOROUGH OF SITKA ALASKA
 SEA WALK - Crescent Harbor Park to National Historic Park
 Project No's 90693, 90695
CIVIL PLAN - CONSERVATION EASEMENT
 STA 30+40 TO E.O.P.

Project No: 135-19835-12001
 Designed By: NH
 Drawn By: NH
 Checked By: DB
C-007
 Sheet X

Bar Measures 1 Inch

1 2 3 4 5 6 7

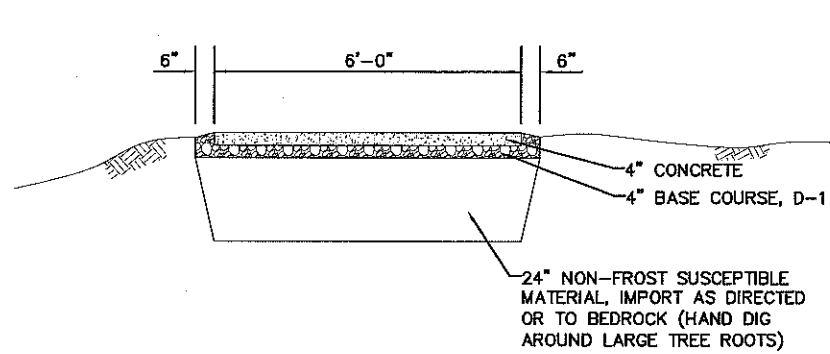

1 CONCRETE SIDEWALK
C-005 NOT TO SCALE

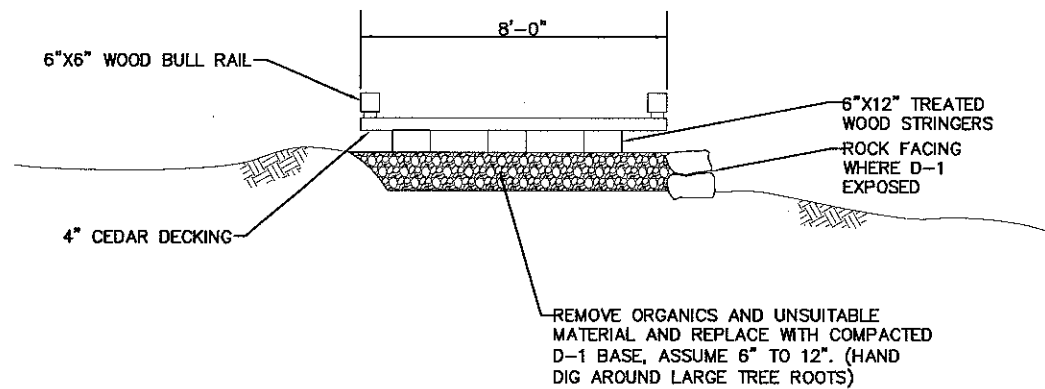

2 BOARDWALK
C-007 NOT TO SCALE

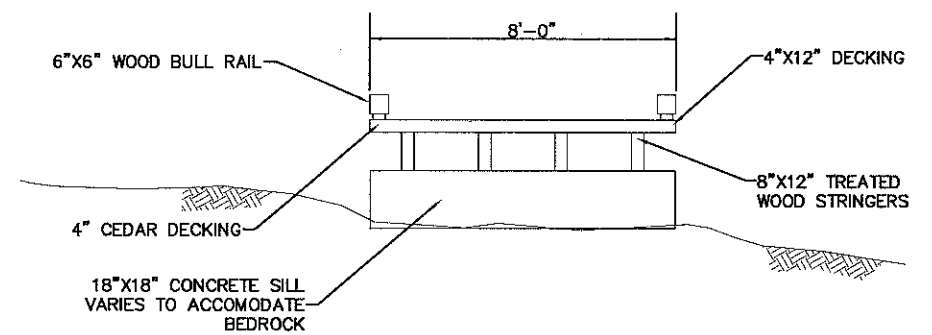

3 ELEVATED BOARDWALK
C-007 NOT TO SCALE

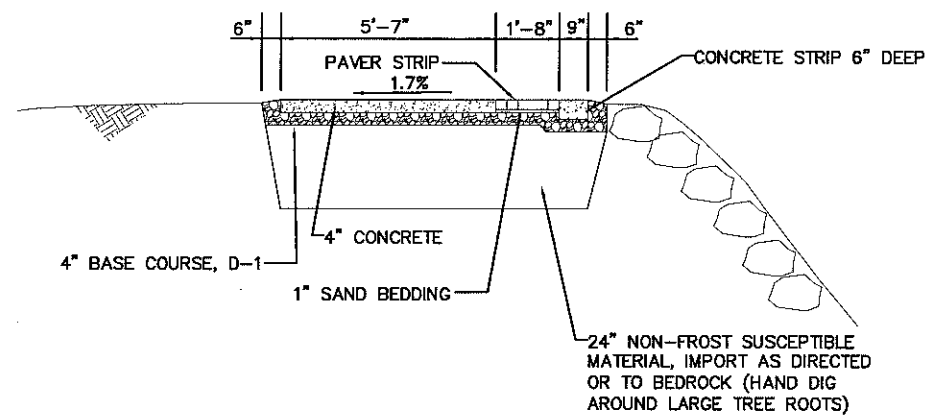

4 CONCRETE SIDEWALK WITH PAVER EDGE
C-002 C-003 C-004 C-005 NOT TO SCALE

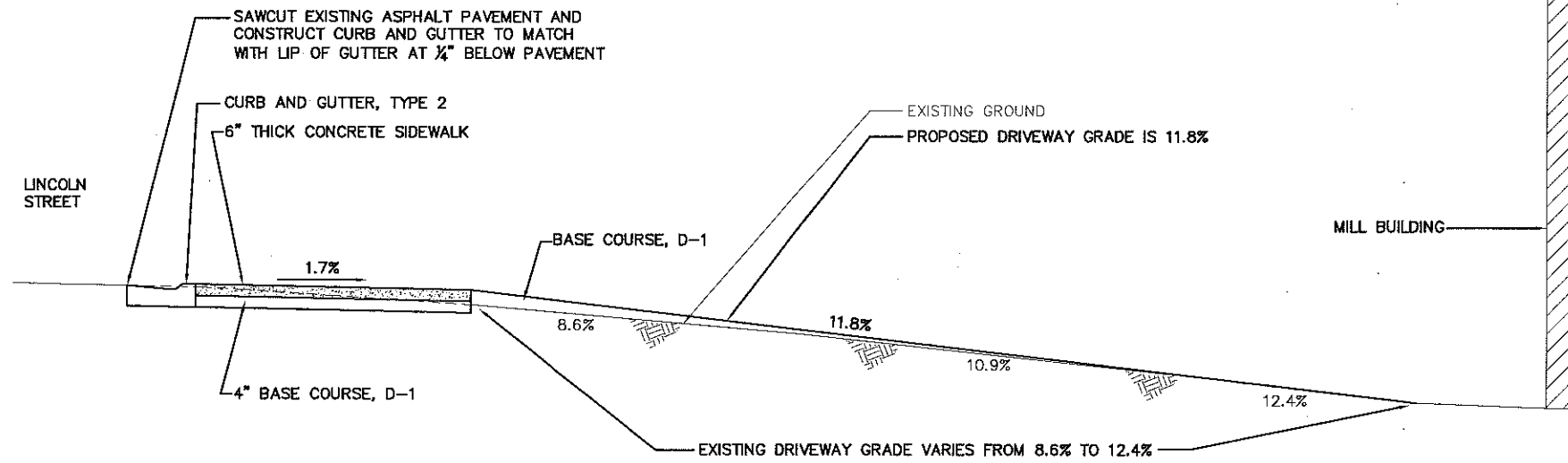

5 TYPICAL SECTION AT MILL BUILDING STA 29+52.2 TO STA 30+60.5
C-005 NOT TO SCALE

1/31/2013 2:31:04 PM - S:\L\170462 SITKA SEA WALK\K1660 DESIGN DRAWINGS\170462 XSEC.DWG - KEMP, JENNIFER

DOWL HKM
5368 Commercial Boulevard
Juneau, AK 99801
(907) 780-3533
Fax (907) 780-3533

TETRA TECH
www.tetrattech.com
230 South Franklin, Suite 212
Juneau, Alaska 99801
Phone: 907-586-6400 Fax: 907-436-3677

City and Borough of Sitka
DEPARTMENT OF PUBLIC WORKS
100 LINCOLN STREET SITKA, ALASKA 99835
TEL (907) 747-1804 FAX (907) 747-3158

MARK	DATE	DESCRIPTION	BY

CITY AND BOROUGH OF SITKA ALASKA
SEA WALK - Crescent Harbor Park to National Historic Park
Project No's 90693, 90695
TYPICAL SECTIONS

Project No.: 135-19835-12001
Designed By: DB/NH
Drawn By: NH/CM/KM
Checked By: DB

C-014
Sheet 15

Bar Measures 1 inch

Copyright: Tetra Tech

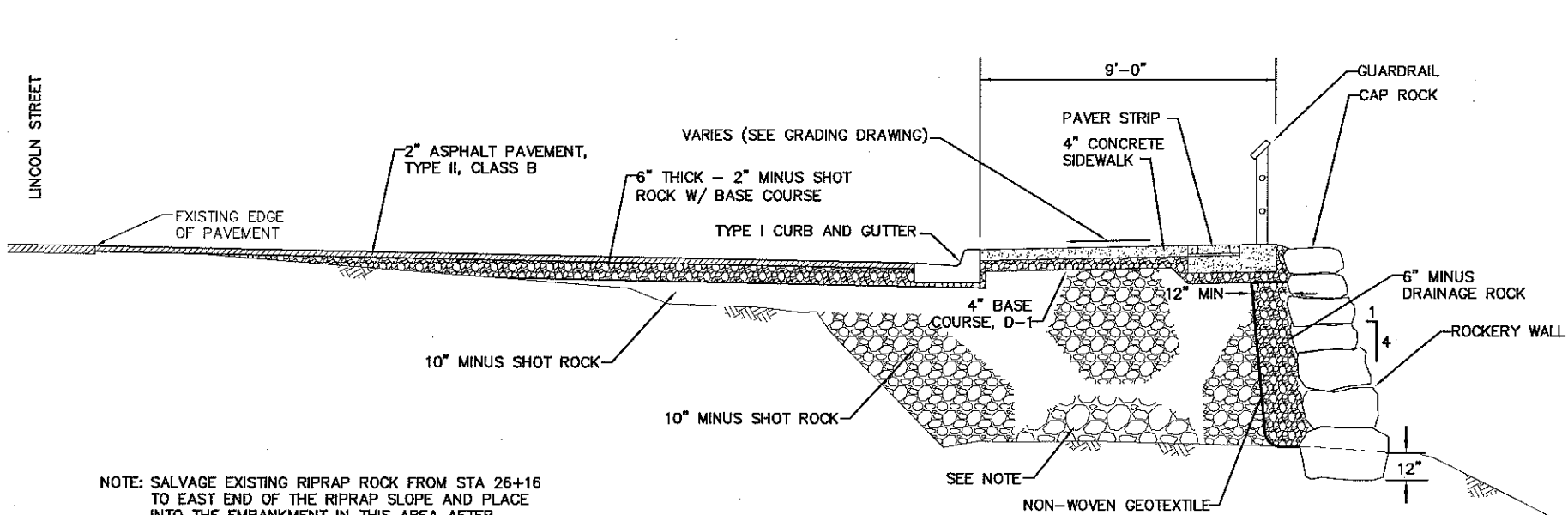

NOTE: SALVAGE EXISTING RIPRAP ROCK FROM STA 26+16 TO EAST END OF THE RIPRAP SLOPE AND PLACE INTO THE EMBANKMENT IN THIS AREA AFTER MIXING WITH SMALLER SHOT ROCK MATERIAL SO VOIDS ARE FILLED

7 ROCKERY WALL STA 27+40 TO STA 28+39
C-005 NOT TO SCALE

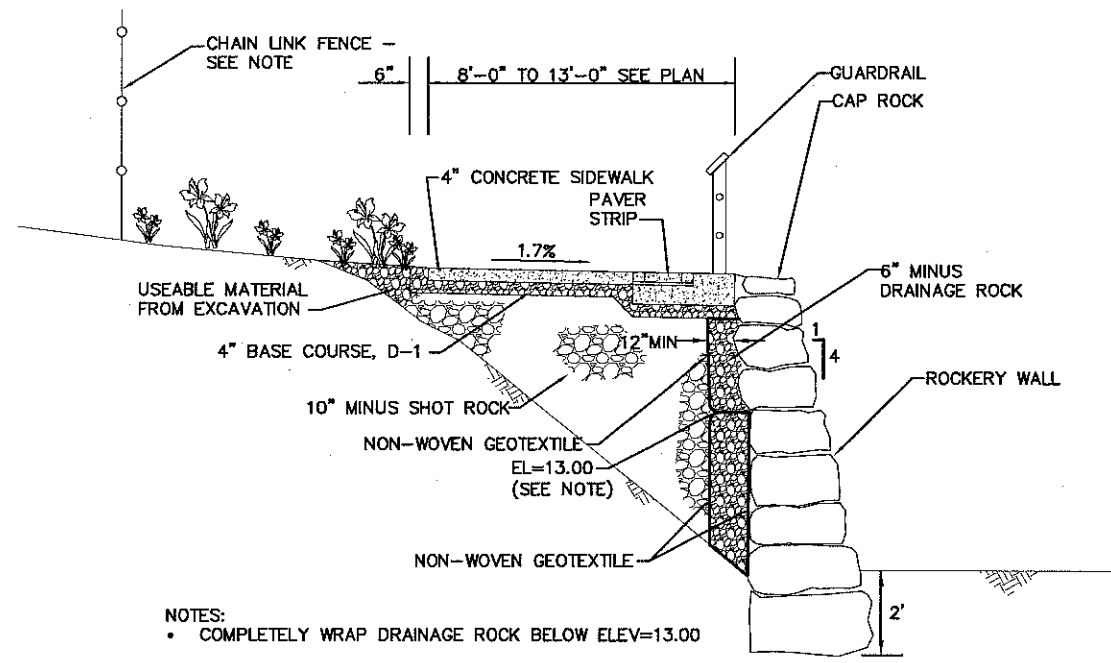

NOTES:
 • COMPLETELY WRAP DRAINAGE ROCK BELOW ELEV=13.00
 • SALVAGE EXISTING RIPRAP FROM THIS AREA AND REUSE IN AREA BETWEEN STA 27+40 AND STA 28+20
 • EXISTING CHAIN LINK FENCE TO REMAIN. ROCKERY WALL CONSTRUCTION AND OTHER WORK IN THIS AREA SHALL BE DONE WITH CHAIN LINK FENCE REMAINING IN PLACE.

8 ROCKERY WALL STA 26+16 TO STA 27+40
C-005 NOT TO SCALE

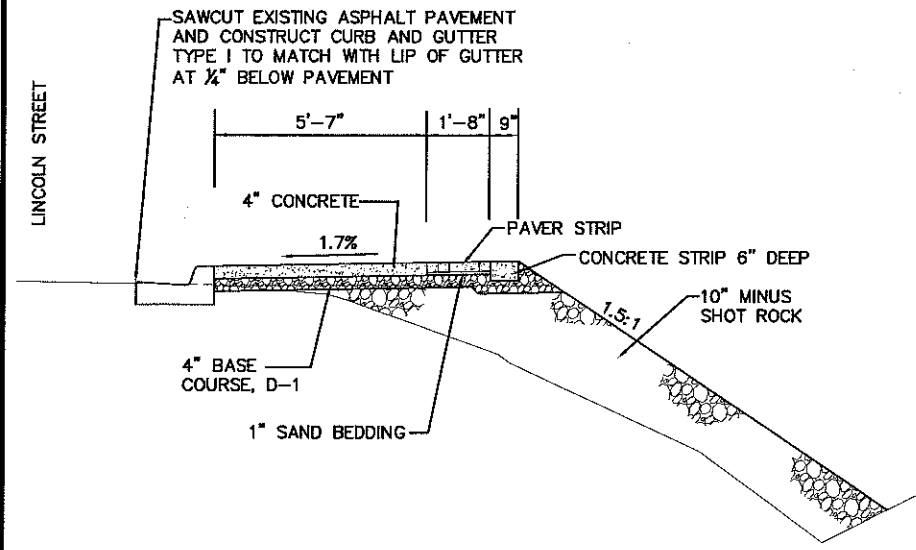

6 CONCRETE SIDEWALK ALONG LINCOLN STREET STA 30+60.5 TO STA 31+76.4
C-007 NOT TO SCALE

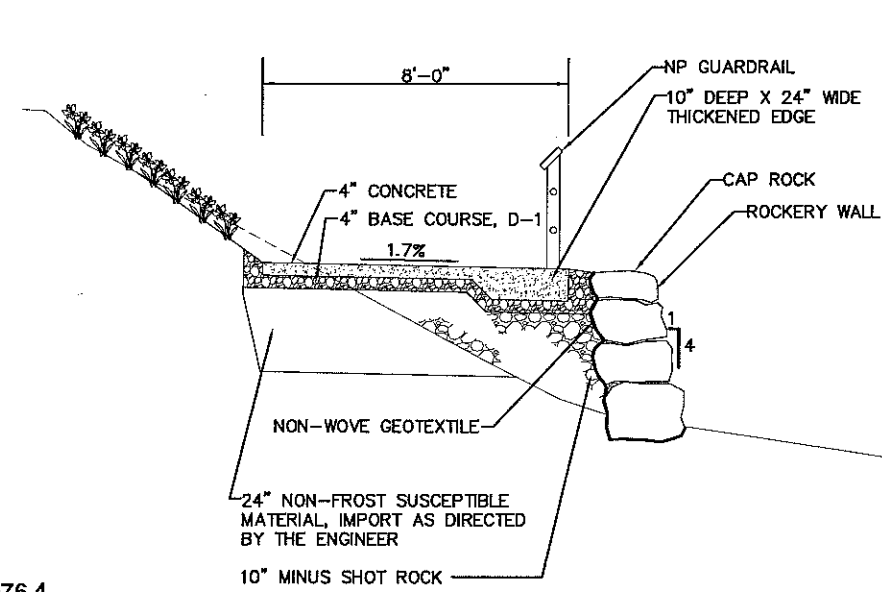

9 ROCKERY WALL WITH CONCRETE SIDEWALK - CONSERVATION EASEMENT
C-007 NOT TO SCALE

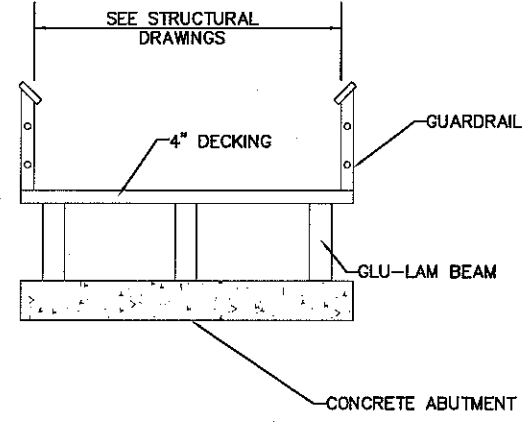

10 TIMBER BRIDGE
C-007 NOT TO SCALE

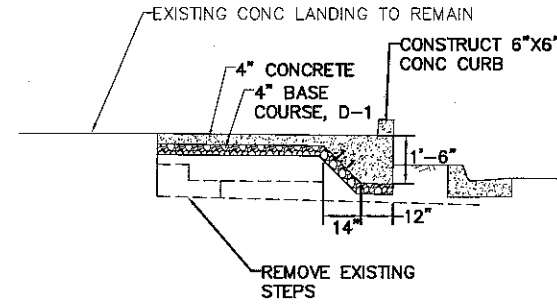

11 THICKENED SIDEWALK - SSSC BLDG
C-005 NOT TO SCALE

DOWL HKM
5368 Commercial Boulevard
Juneau, AK 99801
(907) 780-3533
Fax (907) 780-3533

TETRA TECH
www.tetra-tech.com
230 South Franklin, Suite 212
Juneau, Alaska 99801
Phone: 907-586-6400 Fax: 907-436-3677

City and Borough of Sitka
DEPARTMENT OF PUBLIC WORKS
100 LINCOLN STREET SITKA, ALASKA 99835
TEL (907) 747-1804 FAX (907) 747-3168

MARK	DATE	DESCRIPTION	BY

CITY AND BOROUGH OF SITKA ALASKA
SEA WALK - Crescent Harbor Park to National Historic Park
Project No's 90693, 90695
TYPICAL SECTIONS

Project No: 135-19835-12001
Designed By: DB/NH
Drawn By: NH/CM/KM
Checked By: DB

C-015
Sheet 16

1/31/2013 2:31:12 PM - S:\LBU\70462 SITKA SEAWALK\050 DESIGN DRAWINGS\0492.XSEC.DWG - KEMP, JENNIFER

Copyright: Tetra Tech

Bar Measures 1 Inch

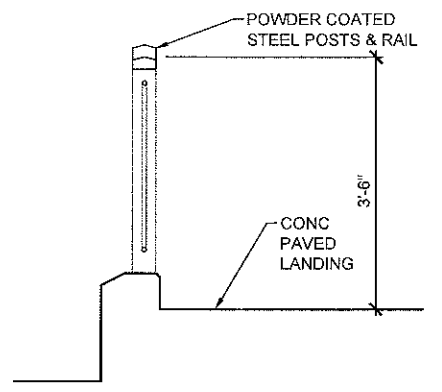
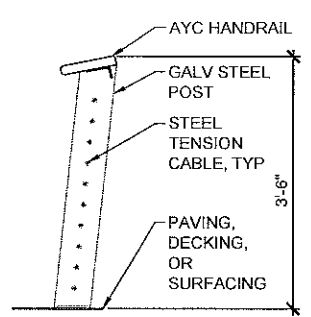
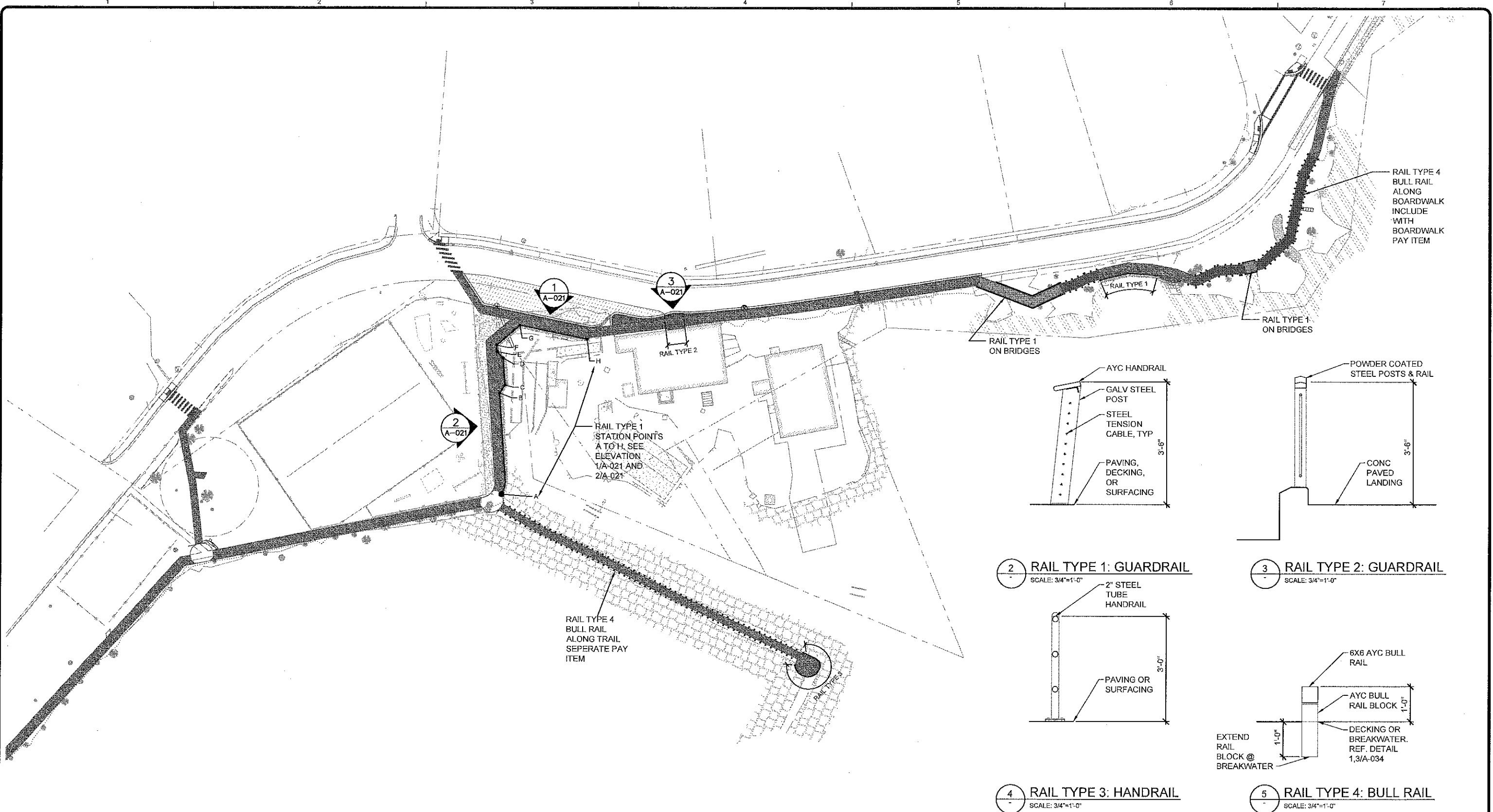

2 RAIL TYPE 1: GUARDRAIL
SCALE: 3/4"=1'-0"

3 RAIL TYPE 2: GUARDRAIL
SCALE: 3/4"=1'-0"

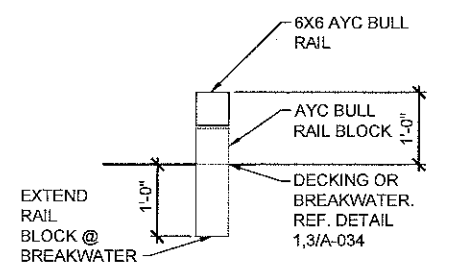
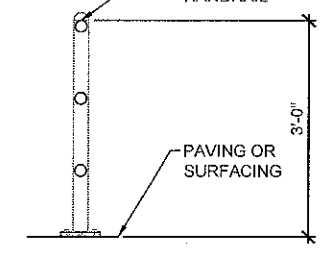

4 RAIL TYPE 3: HANDRAIL
SCALE: 3/4"=1'-0"

5 RAIL TYPE 4: BULL RAIL
SCALE: 3/4"=1'-0"

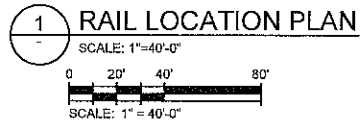
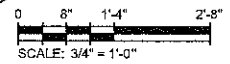

LEGEND

———	RAIL TYPE 1: 42" GUARDRAIL
———	RAIL TYPE 2: 42" GUARDRAIL
-----	RAIL TYPE 3: 36" HANDRAIL
.....	RAIL TYPE 4: 12" BULL RAIL



95% DESIGN
01-FEB-2013

<p>TETRA TECH www.tetrattech.com 230 South Franklin, Suite 212 Juneau, Alaska 99801 Phone: 907-586-6400 Fax: 907-436-3677</p>	<p>City and Borough of Sitka DEPARTMENT OF PUBLIC WORKS 100 LINCOLN STREET SITKA, ALASKA 99835 TEL (907) 747-1804 FAX (907) 747-3158</p>	<table border="1" style="width: 100%; border-collapse: collapse;"> <thead> <tr> <th>MARK</th> <th>DATE</th> <th>DESCRIPTION</th> <th>BY</th> </tr> </thead> <tbody> <tr><td> </td><td> </td><td> </td><td> </td></tr> <tr><td> </td><td> </td><td> </td><td> </td></tr> <tr><td> </td><td> </td><td> </td><td> </td></tr> <tr><td> </td><td> </td><td> </td><td> </td></tr> <tr><td> </td><td> </td><td> </td><td> </td></tr> <tr><td> </td><td> </td><td> </td><td> </td></tr> </tbody> </table>	MARK	DATE	DESCRIPTION	BY																									<p>CITY AND BOROUGH OF SITKA ALASKA SEA WALK - Crescent Harbor Park to National Historic Park Project No's 90693, 90695</p> <p>RAIL LOCATION PLAN AND TYPES</p>	<table border="1" style="width: 100%; border-collapse: collapse;"> <tr> <td>Project No:</td> <td>135-19835-12001</td> </tr> <tr> <td>Designed By:</td> <td>MB</td> </tr> <tr> <td>Drawn By:</td> <td>JH, KM</td> </tr> <tr> <td>Checked By:</td> <td>DB</td> </tr> <tr> <td colspan="2" style="font-size: 2em; font-weight: bold;">A-011</td> </tr> </table>	Project No:	135-19835-12001	Designed By:	MB	Drawn By:	JH, KM	Checked By:	DB	A-011	
		MARK	DATE	DESCRIPTION	BY																																					
Project No:	135-19835-12001																																									
Designed By:	MB																																									
Drawn By:	JH, KM																																									
Checked By:	DB																																									
A-011																																										
<p>Bar Measures 1 inch</p>																																										

2/1/2013 5:00:06 PM - P:\19835\135-19835-12001\CAD\DWG\01\PLANS.DWG - HONG, IRIS

Copyright: Tetra Tech

2/1/2013 12:15:14 PM - J:\11-12-01 SITKA SEAWALK\CORVUS-SHEETS SEAWALK.DWG - NICOLE FERREIRA

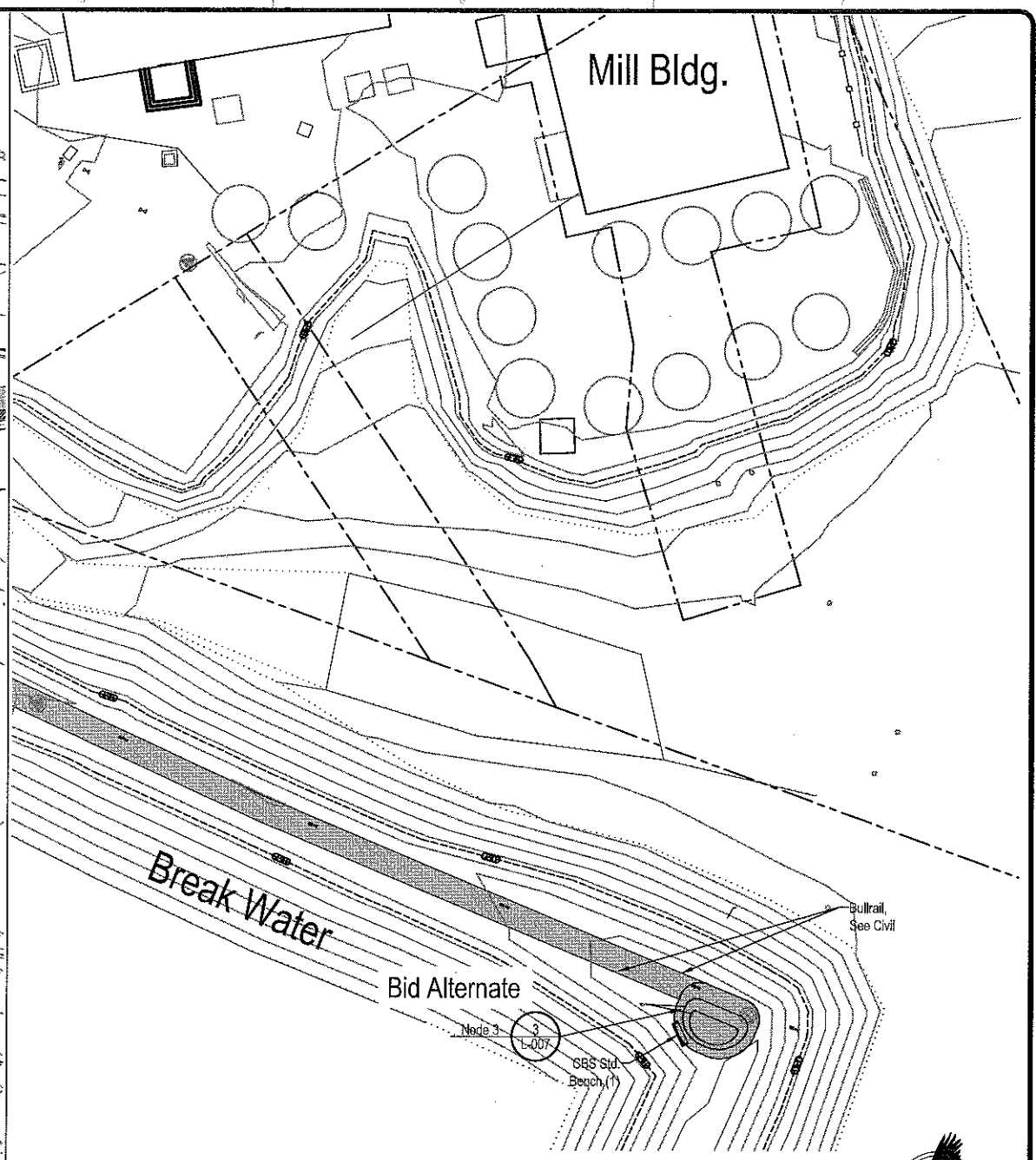
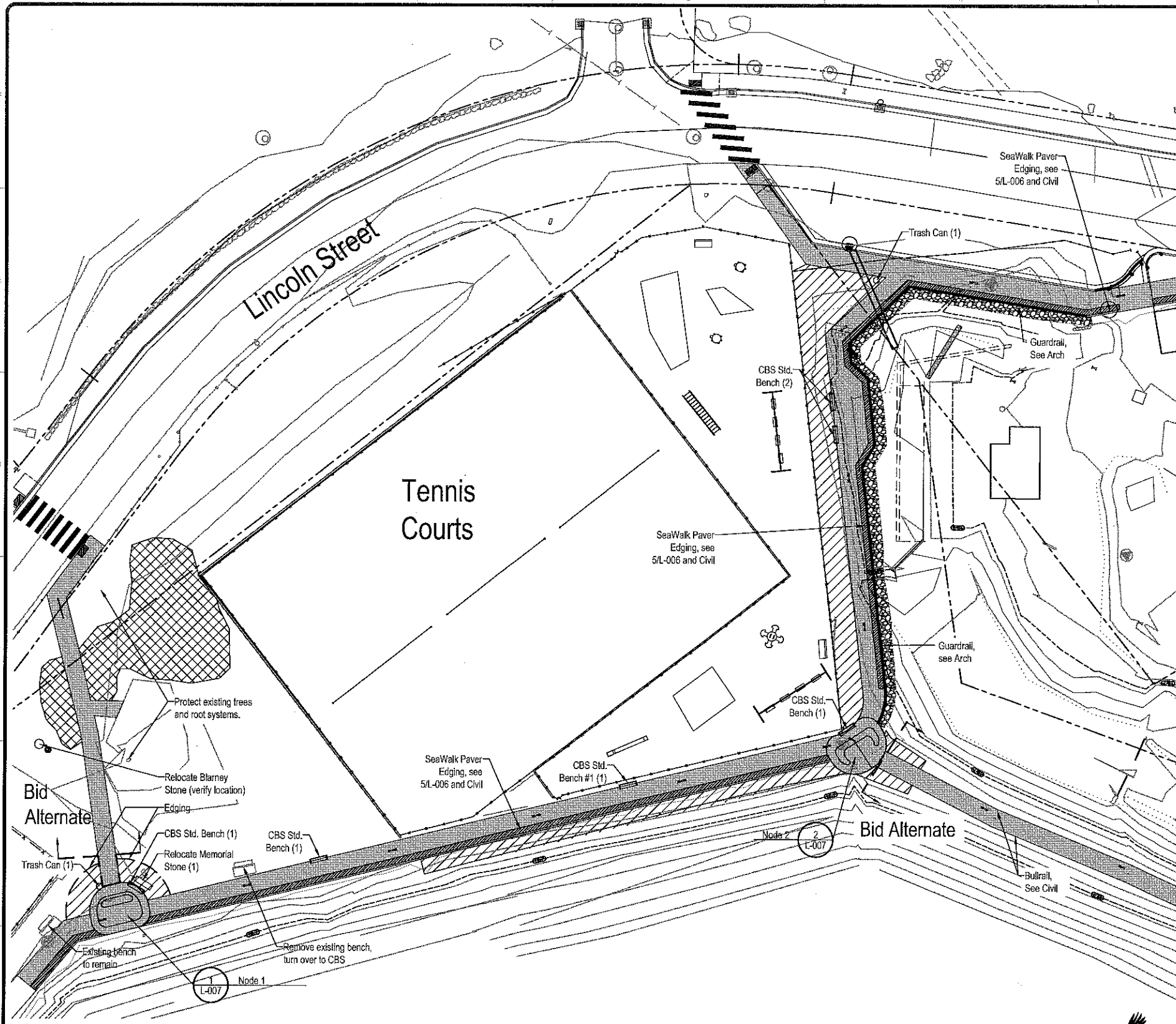

2 Layout Plan
Scale: 1"=20'-0"

0 20' 40' 60'

SCALE: 1"=20'-0"

Legend

- Excavate 18" below finished grade. Install 18" depth planting soil after light compaction.
- Remove existing turf and top dress with turf soil mix to create 2% slope and positive surface drainage to remove depressions. Coordinate with Civil.

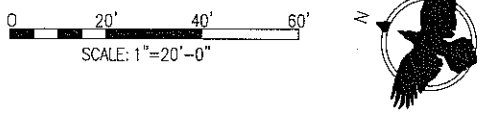

Corvus Design
Landscape Architecture
www.corvus-design.com
Anchorage - 907.222.2858
2506-B Fairbanks St. 99501
Juneau - 907.998.9000
119 Seaward St 99501

TETRA TECH
www.tetrattech.com
230 South Franklin, Suite 212
Juneau, Alaska 99801
PHONE: 907-586-6400 FAX: 907-436-3677

City and Borough of Sitka
DEPARTMENT OF PUBLIC WORKS
100 LINCOLN STREET SITKA, ALASKA 99805
TEL (907) 747-1804 FAX (907) 747-3158

MARK	DATE	DESCRIPTION	BY

CITY AND BOROUGH OF SITKA ALASKA
SEA WALK - BASKETBALL COURT TO NATIONAL HISTORIC PARK
PROJECT NO. 90695
Landscape Layout
Crescent Park & SSSC and Breakwater

Project No.: 135-19835-12001
Designed By: CM
Drawn By: NF
Checked By: CM
L-002
of 29

2/1/2013 12:15:18 PM - J:\TT-12-01 SITKA SEAWALK\CORVUS SHEETS SEAWALK.DWG - NICOLE FERREIRA

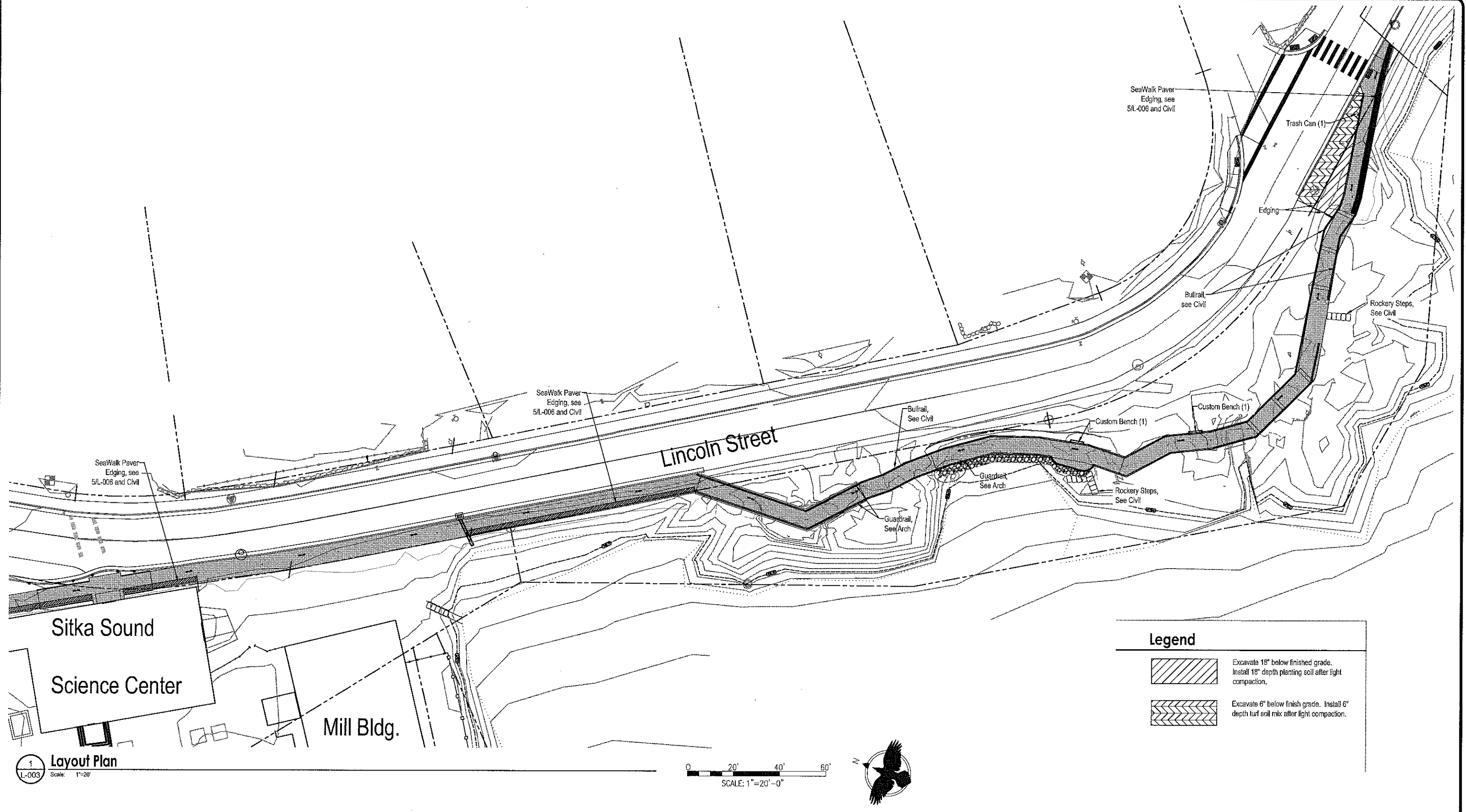



1
L-003
Layout Plan
Scale: 1"=20'

0 20' 40' 60'
SCALE: 1"=20'-0"

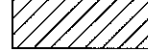

Legend

-  Excavate 18" below finished grade. Install 18" depth planting soil after light compaction.
-  Excavate 6" below finish grade. Install 6" depth turf soil mix after light compaction.

Corvus Design
Landscape Architecture
www.corvus-design.com
Anchorage - 907.222.2699
2506 S Fairbanks St. 99503
Juneau - 907.698.9000
118 Seward St. 99801

TETRA TECH
www.tetrattech.com
230 South Franklin, Suite 212
Juneau, Alaska 99801
PHONE: 907-588-6400 FAX: 907-436-3677

City and Borough of Sitka
DEPARTMENT OF PUBLIC WORKS
100 LINCOLN STREET SITKA, ALASKA 99835
TEL (907) 747-1804 FAX (907) 747-3158

MARK	DATE	DESCRIPTION	BY

CITY AND BOROUGH OF SITKA ALASKA
SEA WALK - BASKETBALL COURT TO NATIONAL HISTORIC PARK
PROJECT NO. 90695
**Landscape Layout
Conservation Easement**

Project No.: 135-19835-12001
Designed By: CM
Drawn By: NF
Checked By: CM
L-003
of 29

Bar Measures 1 inch

Planting Schedule

Deciduous Trees 1 L-006 Deciduous Tree

Qty.	Symbol	Label	Latin Name	Common Name	Size	Furnished	Notes
9		AA	Amelanchier arborea 'Autumn Brilliance'	Autumn Sunset Serviceberry	12' Ht.	CG	Multistemmed
5		ACI	Acer circinatum	Vine Maple	8' Ht.	CG	Multistemmed
6		AP	Acer platanoides 'Emerald Queen'	Emerald Queen Norway Maple	2" Cal	CG	Street Tree

Shrubs 2 L-006 Shrub Planting

Qty.	Symbol	Label	Latin Name	Common Name	Size	Furnished	Notes
48		AM	Aronia melanocarpa	Black Chokeberry	#3	CG	3' o.c.
24		CS	Cornus sericea	Red-twig Dogwood	#5	CG	4' o.c.
10		FG-M	Fothergilla gardenii 'Mount Airy'	Mount Airy Fothergilla	#2	CG	4' o.c.
21		MF	Menziesia ferruginea	False Azalea	#5	CG	4' o.c.
8		RR	Rosa rugosa aiba	White Sitka Rose	#3	CG	4' o.c.
10		VP	Vaccinium parvifolium	Red Huckleberry	#5	CG	3' o.c.
7		VA	Viburnum acerifolium	Mapleleaf Viburnum	#3	CG	3' o.c.

Perennials 3 L-006 Perennial Planting

Qty.	Symbol	Label	Latin Name	Common Name	Size	Furnished	Notes
370		AJ-W	Astilbe japonica 'Washington'	Washington Astilbe	#1	CG	18" o.c.

Miscellaneous

- Type A Seed Mix
- Landscape Edging

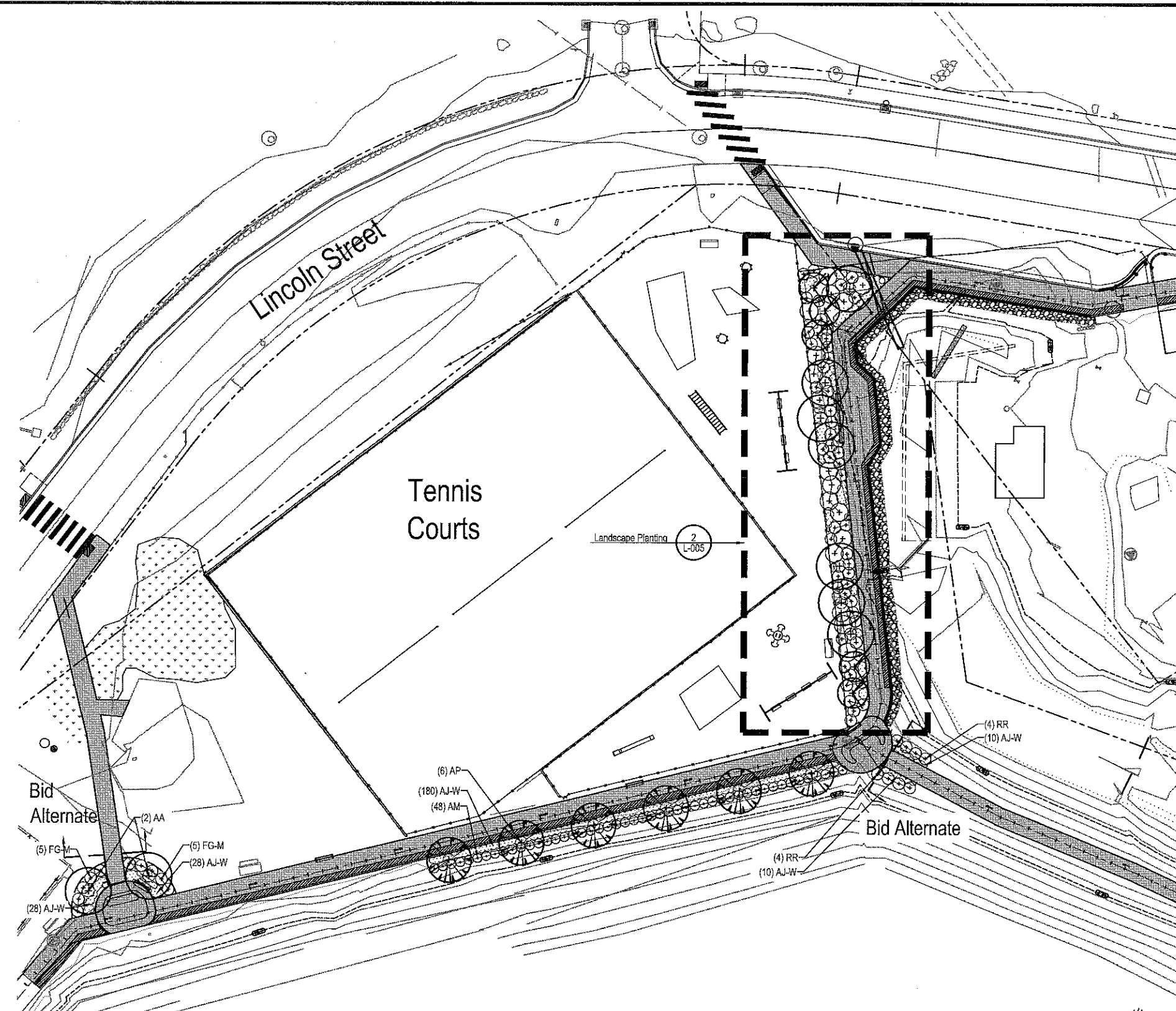

1 L-004 Landscape Planting Scale: 1"=20'

0 20' 40' 60'
SCALE: 1"=20'-0"

2/1/2013 12:15:23 PM - JNTT-L-12-01 SITKA SEAWALK/CORVUS-SHEETS SEAWALK.DWG - NICOLE FERREIRA

 Corvus Design Landscape Architecture www.corvus-design.com Anchorage - 907.222.2859 2206-B Fairbairn Dr. 99503 Juneau - 907.988.8000 118 Seward St. 99801	 TETRA TECH www.tetrattech.com 230 South Franklin, Suite 212 Juneau, Alaska 99801 PHONE: 907-586-6400 FAX: 907-436-3677	 City and Borough of Sitka DEPARTMENT OF PUBLIC WORKS 100 LINCOLN STREET SITKA, ALASKA 99835 TEL (907) 747-1804 FAX (907) 747-3158	<table border="1" style="width: 100%; border-collapse: collapse;"> <thead> <tr> <th>MARK</th> <th>DATE</th> <th>DESCRIPTION</th> <th>BY</th> </tr> </thead> <tbody> <tr><td> </td><td> </td><td> </td><td> </td></tr> <tr><td> </td><td> </td><td> </td><td> </td></tr> <tr><td> </td><td> </td><td> </td><td> </td></tr> <tr><td> </td><td> </td><td> </td><td> </td></tr> <tr><td> </td><td> </td><td> </td><td> </td></tr> <tr><td> </td><td> </td><td> </td><td> </td></tr> <tr><td> </td><td> </td><td> </td><td> </td></tr> <tr><td> </td><td> </td><td> </td><td> </td></tr> <tr><td> </td><td> </td><td> </td><td> </td></tr> <tr><td> </td><td> </td><td> </td><td> </td></tr> </tbody> </table>	MARK	DATE	DESCRIPTION	BY																																									CITY AND BOROUGH OF SITKA ALASKA SEA WALK - BASKETBALL COURT TO NATIONAL HISTORIC PARK PROJECT NO. 90695 Landscape Planting Crescent Park & SSSC	Project No.: 135-19835-12001 Designed By: CM Drawn By: NF Checked By: CM <div style="font-size: 2em; font-weight: bold; text-align: center;">L-004</div> of 29 Bar Measures 1 inch
MARK	DATE	DESCRIPTION	BY																																														

Planting Legend

Deciduous Trees

Symbol	Label	Latin Name	Common Name
	AA	<i>Amelanchier arborea</i> 'Autumn Brilliance'	Autumn Sunset Serviceberry
	ACI	<i>Acer circinatum</i>	Vine Maple
	AP	<i>Acer platanoides</i> 'Emerald Queen'	Emerald Queen Norway Maple

Shrubs

Symbol	Label	Latin Name	Common Name
	AM	<i>Aronia melanocarpa</i>	Black Chokeberry
	CS	<i>Cornus sericea</i>	Red-twig Dogwood
	FG-M	<i>Fothergilla gardenii</i> 'Mount Airy'	Mount Airy Fothergilla
	MF	<i>Menziesia ferruginea</i>	False Azalea
	RR	<i>Rosa rugosa</i>	Sitka Rose
	VP	<i>Vaccinium parvifolium</i>	Red Huckleberry
	VA	<i>Viburnum acerifolium</i>	Mapleleaf Viburnum

Perennials

Symbol	Label	Latin Name	Common Name
	AJ-W	<i>Astilbe japonica</i> 'Washington'	Washington Astilbe

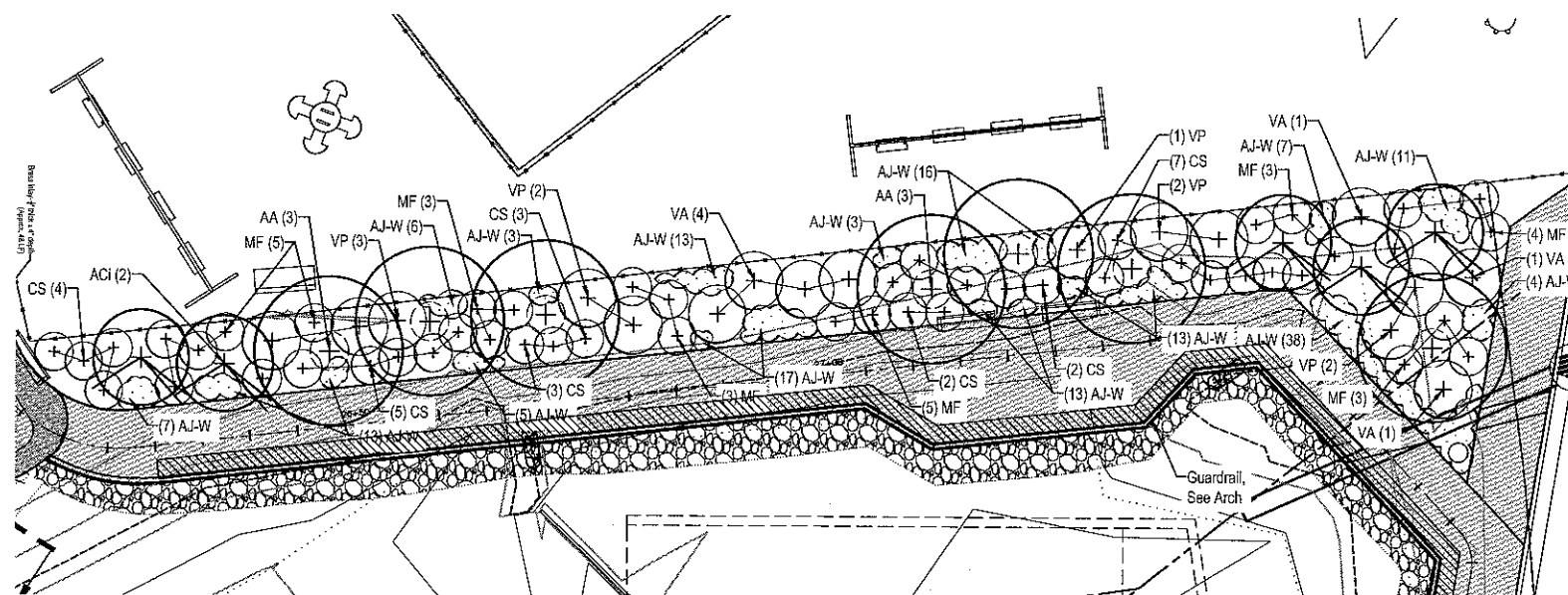

2 Planting Plan Enlargement 1
L-005 Scale: 1"=10'-0"

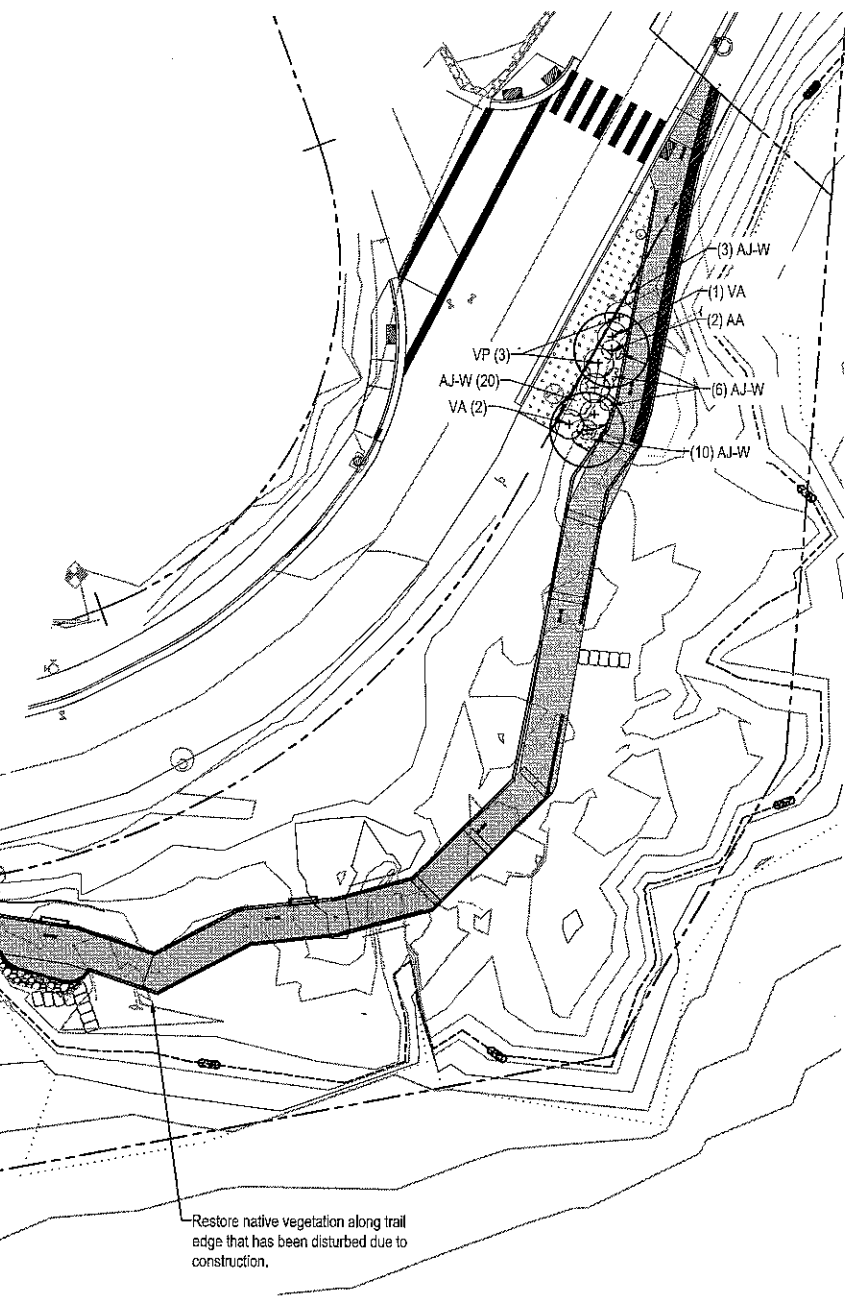
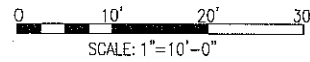

1 Planting Plan
L-005 Scale: 1"=20'

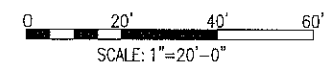

2/7/2013 12:15:28 PM - JTT-L-12-01 SITKA SEAWALK/CORVUS-SHEETS SEAWALK.DWG - NICOLE FERREIRA

Corvus Design
Landscape Architecture
www.corvus-design.com
Anchorage - 907.222.2859
2305 S Fairbanks St. 99503
Juneau - 907.988.9000
119 Seaward St. 99801

TETRA TECH
www.tetrattech.com
230 South Franklin, Suite 212
Juneau, Alaska 99801
PHONE: 907-586-6400 FAX: 907-436-3677

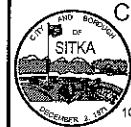

City and Borough of Sitka
DEPARTMENT OF PUBLIC WORKS
100 LINCOLN STREET SITKA, ALASKA 99835
TEL (907) 747-1804 FAX (907) 747-3158

MARK	DATE	DESCRIPTION	BY

CITY AND BOROUGH OF SITKA ALASKA
SEA WALK - BASKETBALL COURT TO NATIONAL HISTORIC PARK
PROJECT NO. 90695
Landscape Planting Conservation Easement

Project No.: 135-19835-12001
Designed By: CM
Drawn By: NF
Checked By: CM

L-005
of 29

Bar Measures 1 inch

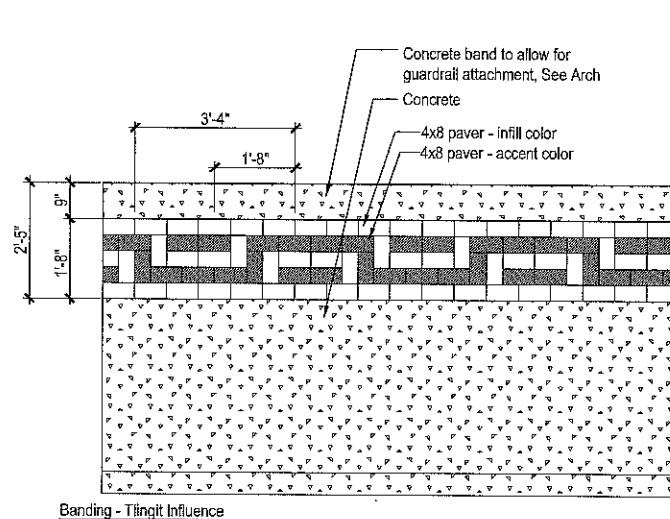

5 Paving Patterns - Tlingit Tide
L-006 SCALE: 1/2"=1'-0" dt-pvt-pvr-patt-tingband.dwg

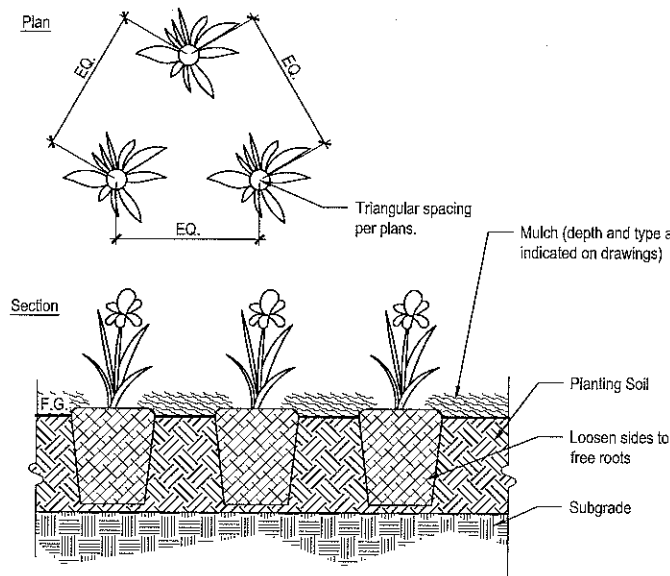

3 Perennial Planting
L-006 SCALE: 1"=1'-0" dt-pvt-pere.dwg

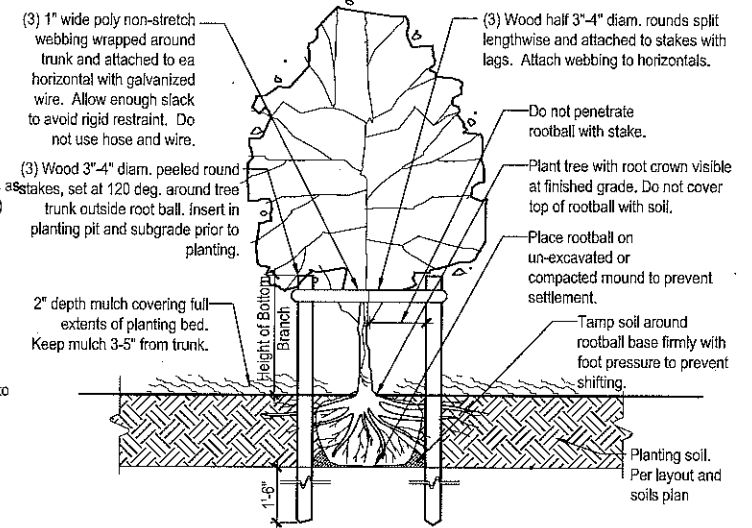

1 Deciduous Tree Planting - Staked
L-006 SCALE: 3/4"=1'-0" dt-tree-decd-stak.dwg

Note:
For trash cans located outside seawalk- set concrete slab flush with finish grade of adjoining surfacing. Slope pad 1%.

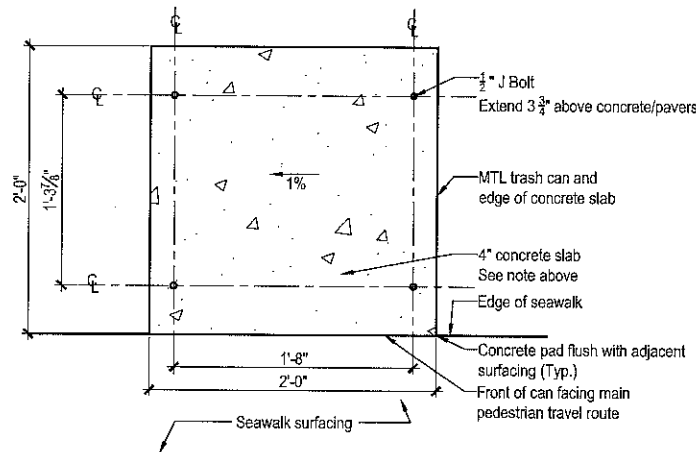

6 Trash Can
L-006 SCALE: NTS dt-fun-trash.dwg

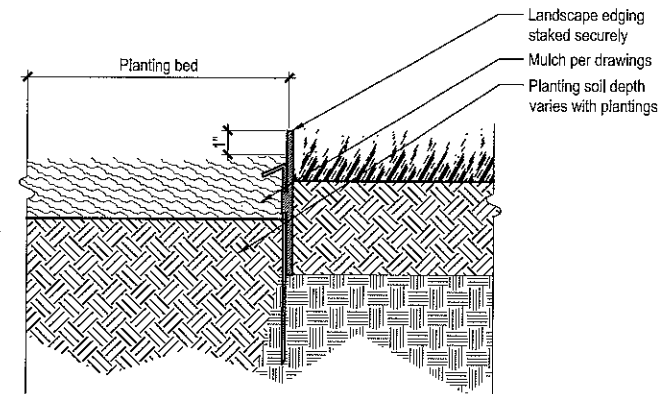

Notes: 1) Install edging per manufacturer's specifications

4 Landscape Edging
L-006 SCALE: 3"=1'-0" dt-pvt-edgr.dwg

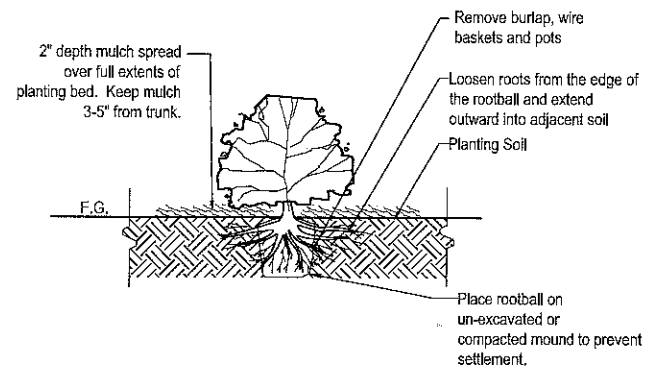

2 Shrub Planting
L-006 SCALE: NTS dt-shrb.dwg

2/12/2013 12:15:32 PM - J:\T1-12-01 SITKA SEAWALK\ACAD\CORVUS-SHEETS SEAWALK.DWG - NICOLE FERREIRA

Corvus Design
Landscape Architecture
www.corvus-design.com
Anchorage - 907.222.2059
230-C Fairbanks, St. 69603
Juneau - 907.986.9000
119 Seward St. 99601

TETRA TECH
www.tetrattech.com
230 South Franklin, Suite 212
Juneau, Alaska 99801
PHONE: 907-586-6400 FAX: 907-436-3677

City and Borough of Sitka
DEPARTMENT OF PUBLIC WORKS
100 LINCOLN STREET SITKA, ALASKA 99635
TEL (907) 747-1804 FAX (907) 747-3158

MARK	DATE	DESCRIPTION	BY

CITY AND BOROUGH OF SITKA ALASKA
SEA WALK - BASKETBALL COURT TO NATIONAL HISTORIC PARK
PROJECT NO. 90695

Details

Project No.: 135-19835-12001
Designed By: CM
Drawn By: NF
Checked By: CM
L-006
of 29