

WE HEREBY CERTIFY THAT WE ARE THE OWNERS OF THE PROPERTY SHOWN AND DESCRIBED HEREON AND THAT WE HEREBY ADOPT THIS PLAN OF SUBDIVISION WITH OUR FREE CONSENT AND DEDICATE ALL STREETS, ALLEYS, WALKS, PARKS AND OTHER OPEN SPACES TO PUBLIC OR PRIVATE USE AS NOTED.

DATE \_\_\_\_\_ OWNER \_\_\_\_\_ (SIGNATURE) \_\_\_\_\_

US OF AMERICA  
STATE OF ALASKA  
CITY & BOROUGH OF SITKA

THIS IS TO CERTIFY THAT ON THIS \_\_\_\_\_ DAY OF \_\_\_\_\_, 20\_\_\_\_, BEFORE ME,  
THE UNDERSIGNED, A NOTARY PUBLIC IN AND FOR THE STATE OF ALASKA, DULY  
COMMISSIONED AND SWORN, PERSONALLY APPEARED \_\_\_\_\_

TO ME KNOWN TO BE THE IDENTICAL INDIVIDUAL(S) MENTIONED AND WHO EXECUTED THE  
WITHIN PLAT AND \_\_\_\_\_ ACKNOWLEDGED TO ME THAT \_\_\_\_\_ SIGNED THE SAME  
FREELY AND VOLUNTARILY FOR THE USES AND PURPOSES THEREIN SPECIFIED.

WITNESS MY HAND AND NOTARY SEAL THE DAY AND YEAR IN THIS CERTIFICATE FIRST  
HEREIN WRITTEN.

NOTARY PUBLIC IN AND FOR THE STATE OF ALASKA

MY COMMISSION EXPIRES \_\_\_\_\_

I, THE UNDERSIGNED, BEING DULY APPOINTED AND QUALIFIED, AND ASSESSOR FOR THE CITY & BOROUGH OF SITKA, HEREBY CERTIFY THAT ACCORDING TO THE RECORDS IN MY POSSESSION, THE FOLLOWING DESCRIBED PROPERTY IS CARRIED ON THE TAX RECORDS OF THE CITY & BOROUGH OF SITKA, IN THE NAME OF \_\_\_\_\_

AND THAT ACCORDING TO THE RECORDS IN MY POSSESSION, ALL TAXES ASSESSED AGAINST SAID LANDS AND IN FAVOR OF THE CITY & BOROUGH OF SITKA ARE PAID IN FULL; THAT CURRENT TAXES FOR THE YEAR 20\_\_\_\_ WILL BE DUE ON OR BEFORE AUGUST 31, 20\_\_\_\_ DATED THIS \_\_\_\_ DAY OF \_\_\_\_\_.

ASSESSOR, CITY AND BOROUGH OF SITKA

I HEREBY CERTIFY THAT THE SUBDIVISION PLAT SHOWN HEREON HAS BEEN FOUND TO COMPLY WITH THE SUBDIVISION REGULATIONS OF THE CITY & BOROUGH OF SITKA PLANNING BOARD, AND THAT SAID PLAT HAS BEEN APPROVED BY THE BOARD BY PLAT RESOLUTION NO. \_\_\_\_\_ DATED \_\_\_\_\_, 20\_\_\_\_, AND THAT THE PLAT SHOWN HEREON HAS BEEN APPROVED FOR RECORDING IN THE OFFICE OF THE DISTRICT MAGISTRATE, EX-OFFICIO RECORDER, SITKA, ALASKA.

DATE \_\_\_\_\_ CHAIRMAN, PLATTING BOARD \_\_\_\_\_

**SECRETARY**

I HEREBY CERTIFY THAT THE SUBDIVISION PLAT SHOWN HEREON HAS BEEN FOUND TO COMPLY WITH THE SUBDIVISION REGULATIONS OF THE CITY & BOROUGH OF SITKA ASSEMBLY AS RECORDED IN MINUTE BOOK \_\_\_\_\_ PAGE \_\_\_\_\_ DATED \_\_\_\_\_ 20\_\_\_\_, AND THAT THE PLAT SHOWN HEREON HAS BEEN APPROVED FOR RECORDING IN THE OFFICE OF THE DISTRICT COURT, EX OFFICIO RECORDER, SITKA, ALASKA.

DATE \_\_\_\_\_ MAYOR \_\_\_\_\_

CITY AND BOROUGH CLERK

I, THE UNDERSIGNED, BEING DULY APPOINTED AND QUALIFIED, AND FINANCE DIRECTOR FOR THE CITY & BOROUGH OF SITKA, DO HEREBY CERTIFY THAT, ACCORDING TO THE RECORDS OF THE CITY & BOROUGH OF SITKA, THE FOLLOWING DESCRIBED PROPERTY IS CARRIED ON THE RECORDS IN THE NAME OF:

(ALL OWNERS OF RECORD); AND THAT, ACCORDING TO THE RECORDS IN MY POSSESSION, ALL L.I.D.'S ASSESSED AGAINST SAID LANDS AND IN FAVOR OF THE CITY & BOROUGH OF SITKA ARE PAID IN FULL.

DATED THIS \_\_\_\_ DAY OF \_\_\_\_\_  
20 \_\_\_\_, AT SITKA, ALASKA.

FINANCE DIRECTOR  
CITY & BOROUGH OF SITKA

BY	DATE	REV	DESCRIPTION OF CHANGE
RECORD OF REVISIONS			

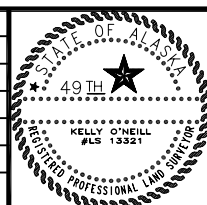

DESIGNED: K. O'NEILL  
DRAWN: JCH/ACAD  
CHECKED: KO  
DATE OF PLAT: APRIL 23, 2024  
SCALE: 1" = 50'  
DRAWING NAME: 40270-03

PROJECT  
NO. **40270-03**

I HEREBY CERTIFY THAT I AM A REGISTERED LAND SURVEYOR IN THE STATE OF ALASKA; THAT THIS PLAT IS A TRUE AND CORRECT REPRESENTATION OF LANDS SURVEYED BY ME OR UNDER MY DIRECT SUPERVISION; THAT THE DISTANCES AND BEARINGS ARE SHOWN CORRECTLY AND THE ERROR OF CLOSURE FOR FIELD TRAVERSES DOES NOT EXCEED ONE PART IN 5,000; AND THAT ALL PERMANENT EXTERIOR CONTROL MONUMENTS, ALL OTHER MONUMENTS, AND LOT CORNERS HAVE BEEN SET.

DATE \_\_\_\_\_ KELLY D'NEILL LS 13321

- PRIMARY CONTROL MONUMENT RECOVERED (BRASS CAP)
- BLM/GLO PRIMARY BRASS CAP (RECOVERED)
- SECONDARY MONUMENT (SET)
- SECONDARY MONUMENT (RECOVERED)
- ORIGINAL WHITCOMB HTS. MONUMENT (RECOVERED)
- (R) RECORDED DATA
- (C) COMPUTED DATA
- (M) MEASURED DATA

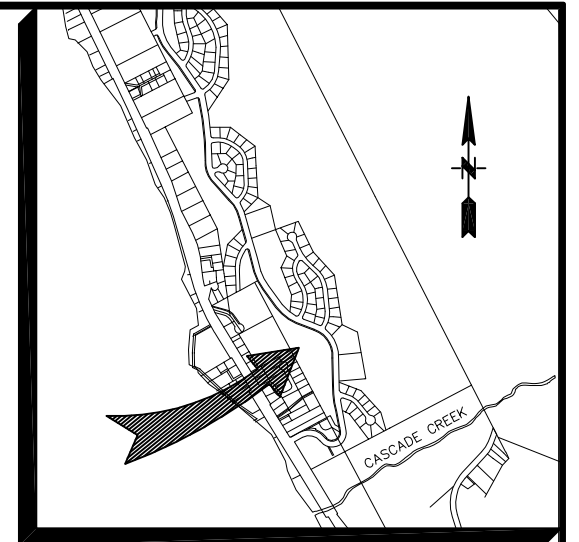

VICINITY MAP  
SCALE 1"=1,000'

