

FLOOR PLAN

FINISH SCHEDULE			
SPACE	MATERIAL	FINISH	COLOR
MAIN FLOOR	STAINLESS STEEL	STUDDED	HIGH POLISHED
INTERIOR WALLS	STAINLESS STEEL	SMOOTH	HIGH POLISHED

EQUIPMENT	LENGTH	HEIGHT	WIDTH	KNOBS	BURNERS	WEIGHT
GRIDDLE	610 mm	355 mm	766 mm	2	2	54 kg
STOVE	305 mm	355 mm	766 mm	2	2	28.2 kg
FREYER	284 mm	274 mm	444 mm	1	1	07 kg
BAIN MARIE	766 mm	355 mm	610 mm	1	1	45 kg

- 1.- BUSINESS NAME ON THE SIDE OF FOOD UNIT
- 2.- EXTRACTOR WITH A GREASE CATCHBOX REMOVABLE
- 3.- LED DISPLAY LIGHTS
- 4.- INLET WATER REFILL
- 5.- SECURE CAGE FOR GAS TANK
- 6.- TO COLLECT THE WASTE WATER THE TRUCK HAS INSIDE 45 GALL NFS PLASTIC CONTAINER
- 7.- INSIDE THE TRUCK IT'S NSF PLASTIC CONTAINER 33 GAL FRESH WATER TANK
- 8.- WINDOWS
- 9.- SIZE: 8 X 14 FEET

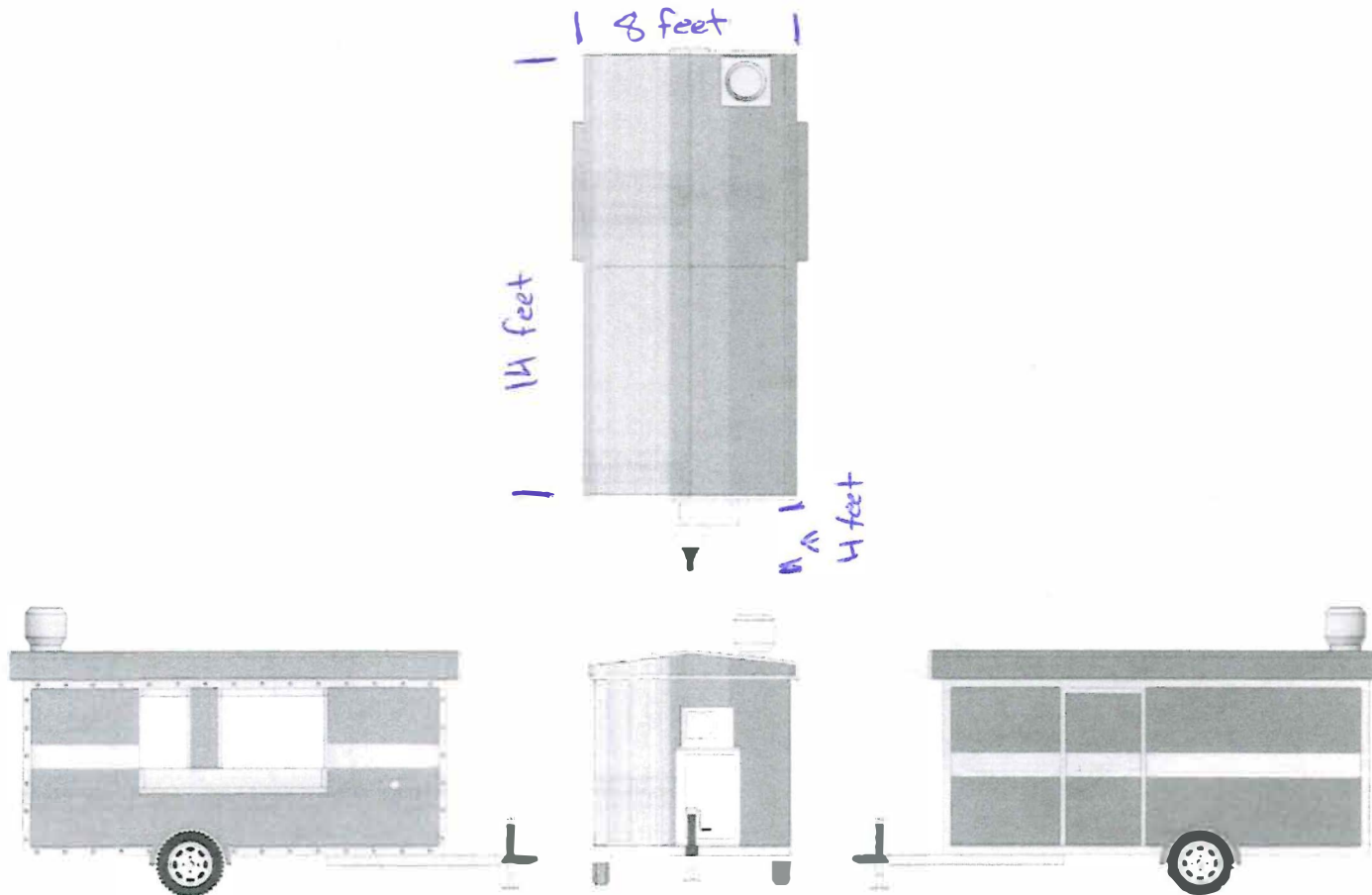

Piring

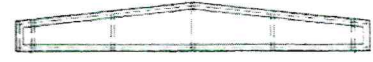
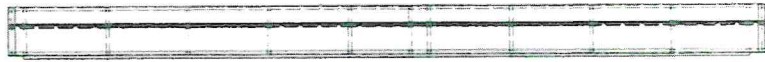
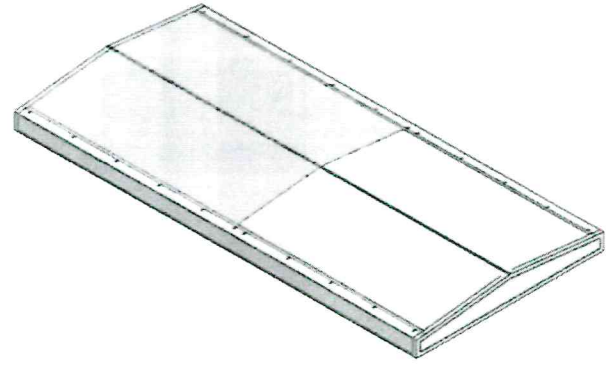
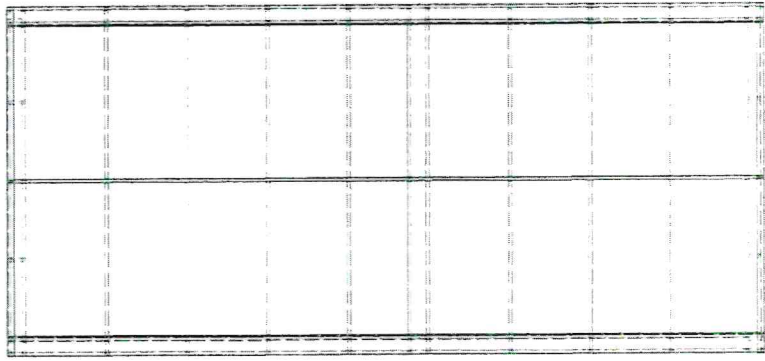

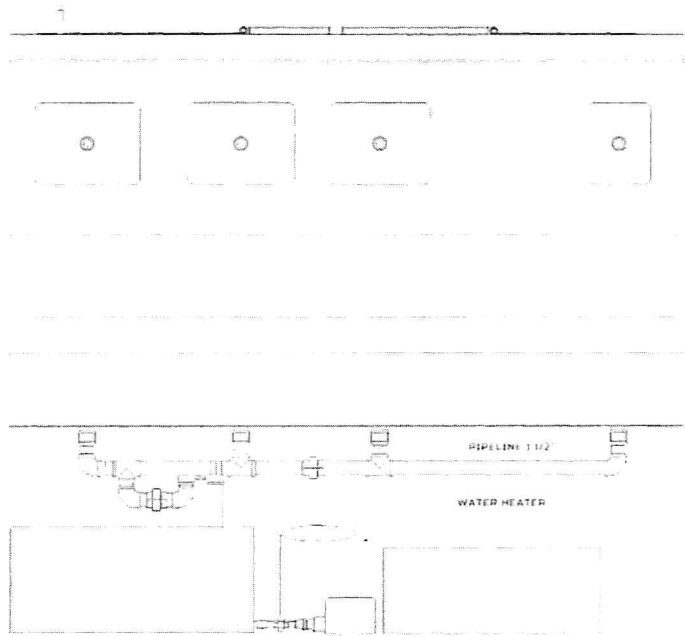

WATER BOMB

SINK STAINLESS STEEL

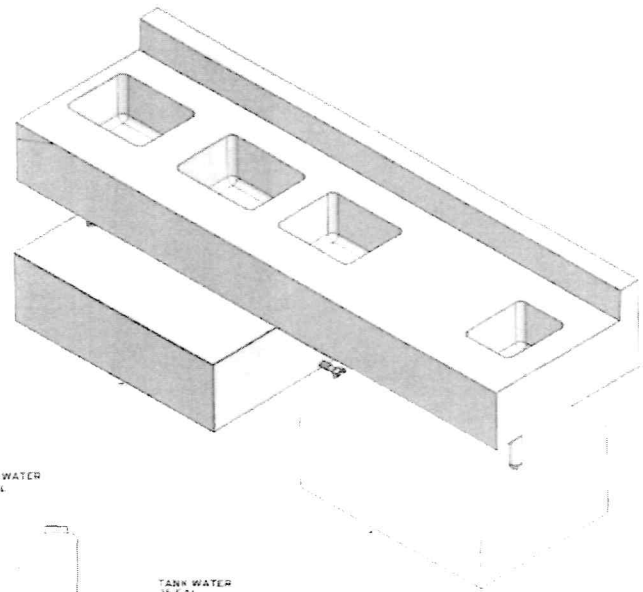

TANK WATER
64 GAL

TANK WATER
35 GAL

PIPELINE 1/2"
COLD 1/2"
HOT 1/2"

